

2010
JAM
JOINT ANNUAL MEETING



ADSA® . PSA . AMPA . CSAS . WSASAS . ASAS
July 11–15, Denver, Colorado

Conference Information
and
Scientific Program

<http://adsa.psa.ampa.csas.asas.org/meetings/2010>

WELCOME to JAM 2010!



**Phil Tong,
ADSA President**

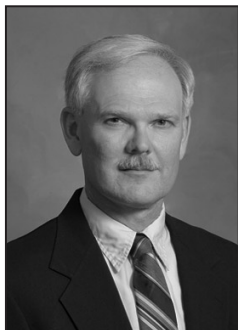

**James Oltjen,
ASAS President**



**Sally Noll,
PSA President**



**Karen Schwartzkopf-
Genswein,
CSAS President**



**Miguel Cervantes-
Ramirez,
AMPA President**

On behalf of the participating societies, we welcome you to JAM 2010. This year, in addition to the American Society of Animal Science (ASAS), the American Dairy Science Association® (ADSA®), and the Poultry Science Association (PSA), we welcome the participation of the Canadian Society of Animal Science (CSAS) and the Asociación Mexicana de Producción Animal (AMPA), making this meeting one of the largest ever. The annual meeting is an important event for all of the societies. It is a great opportunity to share ideas across species and societies, visit with each other in person, and make new acquaintances.

Many opportunities exist for interaction among society members, starting with the opening session and reception on Sunday, July 11, when a live John Denver Tribute concert will kick off the week. Other special events include the National Extension Workshop and Informal Nutrition Symposium on Sunday, July 11, a presentation by Dr. Roger Beachy (USDA-NIFA) on Monday, July 12, and the FASS update scheduled for Tuesday, July 13, where the activities of the FASS Science Policy Directors will be highlighted. And don't miss the Global Networking Reception on Wednesday, July 14—it's open to all attendees, friends, and families.

The meeting program offers many different educational and professional development opportunities. Over 2,800 abstracts were accepted and over 44 scientific symposia are scheduled. The program committee worked hard to produce an integrated program across species. Scheduled symposia include the National Extension Workshop; Nonruminant Nutrition: Nutrigenomics; Animal Health: Accounting for Diseased Animals in Research Trials (Outliers, Treatment Interactions, and Disease Induction by Treatment); Dairy Products and Human Health: The Facts; Companion Animals: Comparative Enrichment—Implications on Health and Behavior; Dairy Foods: Towards a Mechanistic Understanding of Probiotic Function in Man and Animals; Contemporary Issues: Global Livestock Production to 2050; CSAS Symposium: Livestock Transport; ASAS Cell Biology Symposium: Receptors and Signal Transduction; Breeding and Genetics, Physiology, and Endocrinology: Bridging the Gap Between Physiology and Genomics; Growth and Development: Intestinal Development and Growth; Meat Science and Muscle Biology: Impact of Pre- and Post-Slaughter Handling on Meat Quality; Physiology and Endocrinology: Sperm Oviduct Interaction in Livestock and Poultry. Graduate students should check out the symposium titled "Transitions."

We are grateful to the many people involved with this meeting and program, starting with our sponsors—their support is essential to the success and quality of the program. A list of sponsors of this year's meeting is available in this program book. Please take time to thank them during the meeting. The program committee has worked long and hard to organize an excellent program. Our thanks to the overall program committee of Greg Lardy (chair), Clint Krehbiel, John Vicini, Dave Casper, Chris Ashwell, Amy Batal, and Karen Schwartzkopf-Genswein. We also thank the many others who contributed to this huge undertaking, including the FASS staff and the executive and associate executive directors of the founding societies: Meghan Wulster-Radcliffe and Paula Schultz (ASAS), Jim Kessler and Jon Cole (PSA), and Peter Studney (ADSA).

Most of all, thank you, our attendees, for participating in JAM 2010 and making it a success!

Table of Contents

Welcome Letter.	1
General Meeting Information.	3
Headquarters Hotels	6
Transportation	7
Denver Information	7
Special Events	9
Award Donors	14
Exhibit Schedule and Floor Plan	15
Guide to Exhibitors	16
Exhibit Directory	17
Corporate Sponsorship.	27
Denver, Convention Center, and Hotel Maps	29
Meeting Sponsors	36
Schedule of Events	37
ADSA SAD Schedule of Events	41
Scientific Program Table of Contents	45
Scientific Sessions	53
Author Index	241
Program at a Glance.	281

<http://adsa.psa.ampa.csas.asas.org/meetings/2010/>

Important Message

In the event that protestors interrupt the meetings, please ignore them. Their goal is to attract attention and any attention you give them will only help their cause. Convention staff has a plan in place to handle these situations, and they depend on your cooperation. If members of the media approach you for an interview, please politely refuse and direct them to the convention's media room, where spokespersons are available.

Thank you for your cooperation.

General Meeting Information

Location

The Colorado Convention Center is conveniently located at the heart of exciting downtown Denver within easy walking distance of more than 7,000 hotel rooms, 300 restaurants, the nine theatres of the Denver Performing Arts Complex, and a wide variety of shopping venues.

Schedule of Events

The 2010 ADSA®-PSA-AMPA-CSAS-WSASAS-ASAS Joint Annual Meeting will be held July 11–15 (Sunday through Thursday). The opening session will be held on Sunday evening, July 11; scientific sessions will begin Monday morning, July 12, and run through noon on Thursday, July 15. ***Please note that the schedule for this meeting is Sunday to Thursday.***

The Triennial Growth Symposium: Dietary Regulation of Growth and Development will be held Sunday, July 11.

The opening session will begin with a presentation on animal agriculture in Colorado by the new president of Colorado State University, Dr. Anthony Frank. The festivities will continue with “The Absolute Best John Denver Tribute Concert” performed live by John Adams and his band! Since John Denver’s untimely death in 1997, John Adams has promised to keep the legend’s music alive. John Denver himself was amazed by how much the two sounded alike when he was alive, so this show is sure to provide great entertainment for all! Join us for dessert and beverages at the reception that follows.

The complete schedule of events can be found on page 37 of this book.

Program Format for 2010

Poster sessions	7:30 am–9:30 am
Scientific sessions	9:30 am–12:30 pm
Lunch break	12:30 pm–2:00 pm
Scientific sessions	2:00 pm–5:00 pm

Meeting rooms will be equipped for electronic presentations and preloaded sessions. A Cyber Café will be available for attendees to keep up to date while at the meeting.

Registration Hours

Registration will be located on Level 1 of the Colorado Convention Center in Denver, in front of Exhibit Hall F. Registration hours for the 2010 ADSA-PSA-AMPA-CSAS-WSASAS-ASAS Joint Annual Meeting, including special symposia and other events, will be as follows:

Saturday, July 10 (preregistered only)	3:00 pm–5:00 pm
Sunday, July 11	7:00 am–7:00 pm
Monday, July 12	6:30 am–5:15 pm
Tuesday, July 13	6:30 am–5:15 pm
Wednesday, July 14	6:30 am–5:15 pm
Thursday, July 15	8:00 am–1:00 pm

Important Phone Numbers

Registration Desk	(303) 228-8239
Hyatt Regency at the Colorado Convention Center	(303) 436-1234
Grand Hyatt Denver	(303) 295-1234
Comfort Inn Denver, Downtown	(303) 296-0400
Crowne Plaza Denver	(303) 573-1450
Marriott City Center Denver	(303) 297-1300
Residence Inn City Center	(303) 296-3444
Hilton Garden Inn	(303) 603-8000

Media Check-In

Please check in at the Registration Desk on the 1st Level lobby, outside Exhibit Hall F of the Colorado Convention Center.

Speaker Ready Room

The Speaker Ready Room is located in Room 407 of the Colorado Convention Center. This room will be available for speakers from 7:00 am to 5:00 pm on each day of the meeting.

Hospitality Lounge

A hospitality lounge will be located in Room 709 of the Colorado Convention Center. This lounge will offer attendees an area to relax, network, and catch up with old friends. The hospitality lounge is also a great meet-up place when departing the convention center as a group.

Business Center

The Business Center is located off Lobby A in the Colorado Convention Center and provides printing, copying, and shipping services. The Business Center is open from 7:30 am to 5:30 pm during the meeting.

Presentation Information

Oral and Invited Speakers

Oral sessions will begin at 9:30 am on Monday and Tuesday, 10:30 am on Wednesday, and 8:30 am on Thursday. Please note that all session rooms will be equipped with a computer and LCD projector. All oral presentations and invited speaker presentations will be preloaded before the start of the session based on the schedule below.

Onsite Upload Information

Onsite upload: We will provide onsite presentation uploading in Room 407. Files can be delivered to the pre-load room (Room 407) on the day prior to your scheduled presentation. **Note: Presentations must be uploaded by 5:00 pm on the day before your scheduled presentation; no exceptions will be made. Files will not be accepted by e-mail.**

Poster Presentations

We have dedicated a two-hour block each morning to poster presentations. The “open poster” sessions will be from 7:30 to 9:30 am Monday, Tuesday, and Wednesday in the Convention Center, Exhibit Hall F.

Each poster presentation will be available for public viewing for the entire day, with the presenting authors present during the open posters time (7:30–9:30 am). All posters must be mounted on the board 30 minutes before the beginning of the day’s session (**poster sessions begin at 7:30 am so posters must be mounted on boards by 7:00 am**). The exhibit hall will open at 6:30 am on Monday through Wednesday. **Posters must be removed after 5:00 pm each day.** Any posters remaining after 5:30 pm will be removed by the convention center staff and discarded.

Each poster board area is 48 inches high and 96 inches wide. Use of this space is dictated by the presenter, with the following exceptions: the top of the poster space should include the abstract number, title, authors, and affiliations. The lettering for this section should be at least 1 inch high.

Locating the Correct Poster Board

Each poster board number corresponds to the abstract number as noted in the program. For Monday posters an “M”, Tuesday posters a “T”, and for Wednesday posters a “W” precede the board number.

Camera, Video Camera, and Cell Phone Policy

Use of cameras, video cameras, and cell phones (for calls or as cameras) is prohibited during oral and poster presentations to minimize disruption and unauthorized dissemination of data. Anyone found in violation of this policy will be asked to leave the conference.

ARPAS Continuing Education Units

The 2010 ADSA-PSA-AMPA-CSAS-WSASAS-ASAS Joint Annual Meeting has been approved for up to 21 continuing education units (CEUs) for the American Registry of Professional Animal Scientists (ARPAS) certification requirements. Check the schedule of events for times and location of the ARPAS exams.

Continuing Education Credits for Veterinarians (RACE credits)

Many of the symposia at the 2010 Joint Annual Meeting will be approved for RACE credits. We are in the process of having specific symposia approved. Following approval, symposia approved for RACE credits will be posted online at <http://adsa.psa.ampa.csas.asas.org/meetings/2010/>.

Job Resource Center

The ADSA-PSA-AMPA-CSAS-WSASAS-ASAS Job Resource Center is located in the exhibit hall. The job announcements and resumes will be organized into the following categories for posting: Animal Behavior and Well-Being; Animal Health; Animal Breeding; Companion Animals; Extension; Food Safety; Food Science; Forages and Pastures; Genetics; Growth and Development; International Animal Agriculture; Lactation; Meat Science and Muscle Biology; Nonruminant Nutrition; Pharmacology and Toxicology; Physiology and Endocrinology; Poultry Production and Management; Poultry Nutrition; Poultry Processing; Poultry Health; Production and Management; Ruminant Nutrition; and Teaching.

E-Career Tool Now Available Online!

Whether you are an employer looking to fill a position or a potential employee looking for a job, the E-Career Tool has been developed to facilitate this communication. The E-career tool is free to use and very user friendly. Take advantage of the "search employee" function to identify potential candidates and see where and when they will be presenting their work at the 2010 ADSA-PSA-AMPA-CSAS-WSASAS-ASAS Joint Annual Meeting. For the job seeker, upload your CV and cover letter.

ASAS is excited to bring this feature to Joint Annual Meeting attendees once again, and we hope you will take full advantage of this exciting tool! Visit <http://adsa.psa.ampa.csas.asas.org/meetings/2010/ecareer.asp> for more information! See you in Denver!

Cyber Café

Keep in touch with work, family, and friends during the ADSA-PSA-AMPA-CSAS-WSASAS-ASAS Joint Annual Meeting at the Cyber Café. Located in exhibit hall, the Cyber Café is available to all meeting attendees. The Cyber Café will also have a computer with a printer for limited printing during the meeting.

Headquarters Hotels

Hyatt Regency at the Colorado Convention Center

ASAS Headquarter Hotel
650 15th Street
Denver, CO 80202
(303) 436-1234

Grand Hyatt Denver

ADSA Headquarter Hotel
1750 Welton Street
Denver, CO 80202
(303) 295-1234

Comfort Inn Downtown Denver

Student Headquarter Hotel
401 17th Street
Denver, CO 80202
(303) 296-0400

Crowne Plaza Denver

PSA Headquarter Hotel
1450 Glenarm Place
Denver, CO 80202
(303) 573-1450

Marriott City Center Denver

CSAS Headquarter Hotel
1701 California Street
Denver, CO 80202
(303) 297-1300

Residence Inn City Center

Official JAM Hotel
1725 Champa Street
Denver, CO 80202
(303) 296-3444

Hilton Garden Inn

Official JAM Hotel
1400 Welton St
Denver, CO 80202
(303) 603-8000

Transportation in Denver: How to get downtown?

1. Shuttle Service

The JAM has partnered with Blue Sky Shuttle to secure a special rate for airport/downtown transportation of \$18.00 one way and \$24.00 round trip. We recommend making reservations in advance at www.blueskyshuttle.com/reservation_step1.php#. Please use the group code "JAM" to ensure you receive the JAM discount.

2. Taxi Service

Taxicabs are readily available outside the airport. The fare from the airport to the downtown convention hotels will start at \$54.50 plus gratuity. Share a cab with a fellow JAM attendee!

3. Denver Light Rail

RTD light rail offers over 30 convenient stations on several lines to get you anywhere you want to go. Visit <http://www.rtd-denver.com/> for maps and more information.

Welcome to Denver

Denver Sightseeing Options

When you wake up in Denver, adventure awaits. If you're looking for a chic and sophisticated jaunt, visit one of many museums and galleries that make Denver the Arts Capital of the West. Or indulge your inner shopper or foodie followed by a blissful afternoon at a spa. Bike paths throughout the city are a great way to explore major attractions or escape for a day trip into the majestic Rockies. A Visitor Information Center is conveniently located inside the 14th and California Street entrance of the Colorado Convention Center, where the staff is available to assist conference attendees with city questions and dining reservations—they know all the best restaurants in the city! There are also more than 100 brochures promoting the best Denver has to offer.

Downtown Denver

The Brookings Institute ranks Denver as the fourth most walkable downtown in the nation. You can save on shoe-leather by riding the free shuttle bus on the 16th Street Mall—it makes everything downtown easy to reach.

Colorado State Capitol

www.state.co.us

Stand exactly 5,280 feet above sea level (one mile high!) on the west steps, and then climb to the rotunda for a panorama of snowcapped peaks. It is against state law to block the view of the 200 named mountains visible from the dome. Free tours on weekdays.

Denver Art Museum

www.denverartmuseum.org

There are two buildings—one a fortress-like structure from Italian architect Gio Ponti, the other a structure that resembles a titanium crystal with peaks and shards, designed by Daniel Libeskind. Inside, find the world's greatest collection of Native American art and 68,000 other art objects, including works from European masters and Old West classics. Coming July 1, 2010 is Tutankhamen: The Golden King and the Great Pharaohs.

U.S. Mint

www.usmint.gov/mint_tours/index.cfm?action=StartReservation

Learn how to make money! The Mint produces 50 million coins a day, each one stamped with "D" for Denver. Free tours show every step in the process of turning a dull, blank, metal slug into shiny pocket change.

16th Street Mall – Pedestrian Mall

Lined with 200 trees and 50,000 flowers, this festive, mile-long pedestrian promenade has 28 outdoor cafes and offers Denver's best people-watching. I. M. Pei designed the gray and pink granite pathway to resemble the pattern of a diamondback rattlesnake. Hop on the bus—they're free and stop on every corner. After dark, horse-drawn carriages clatter up and down the Mall.

Larimer Square

www.LarimerSquare.com

This trendy block of Victorian buildings is home to chic shopping, dance clubs, a comedy club, outdoor cafés, and a dozen of Denver's best restaurants. For 40 years in downtown Denver, it's hip to be at the "Square."

LoDo Historic District

www.lodo.org

Denver's happening historic district is filled with turn-of-the-century warehouses, now home to 90 brewpubs, sports bars, restaurants, and rooftop cafes. Stop by Rockmount Ranchwear for a snap-button Western shirt at the store where they were invented; browse from 6:30 a.m. to 9 p.m. at the Tattered Cover Bookstore; listen to jazz at El Chapultepec, one of Esquire Magazine's 50 best bars; or sip a handcrafted beer at the Wynkoop Brewing Company, Denver's first brewpub opened by the current mayor, John Hickenlooper.

Confluence Park

www.greenwayfoundation.org

Denver was founded here as a gold mining camp in 1858. Today, the river park is the heart of Denver's 850-mile bike trail network and is surrounded by attractions. Gear up for the mountains at the REI Flagship store; ride the Platte River Trolley to the Downtown Aquarium to see stingrays and sharks; eat and drink in the nearby neighborhoods of Riverfront, LoHi, and Highlands; or scream your head off on the Mind Eraser at Elitch Gardens, Denver's downtown theme park.

A Dozen Mile High "Must-Dos"

You can't come to Denver without trying some of these activities:

- Stand exactly one mile above sea level on the steps of the State Capitol or in City Park
- Sip a local Denver beer (Denver brews more beer than any other city in the US)
- Taste buffalo (buffalo is the leanest of red meats with fewer calories than chicken)
- See a dinosaur bone (the first dinosaurs were discovered at Dinosaur Ridge, where you can still see bones and footprints embedded in rock)
- Hear a concert at Red Rocks
- Take a hike. There are thousands of miles of hiking trails within an hour or so of downtown
- Cheer on a team! (Denver has a record seven professional sports teams and six sports stadiums)
- Borrow a bike (Denver's bike sharing program offers 500 bikes for sharing at 30 locations)
- Browse art on First Friday (dozens of art galleries in Denver neighborhoods stay open late on the First Friday of the month)
- Enjoy theatre, opera, symphony, and dance (the Denver Performing Arts Complex is the second largest in the nation with 10 venues seating 10,000 people)
- Climb a 14er (there are 54 of them in Colorado—Mount Evans is accessible by car and Pikes Peak can be climbed by car or cog railroad)
- Hit a golf ball (in Denver's rarefied air, golf balls travel 10% farther than at sea level).

Special Events

Student White Water Rafting Trip on Clear Creek

Saturday, July 10

12:00 pm – 4:00 pm

Bus departs from the Comfort Inn

Tickets: \$44

Prepare for the adventure of a lifetime! We'll do a beginner trip with Class I to III rapids, perfect for first-time paddlers but plenty of action for those seeking it. Participants must complete the necessary liability waivers and should bring rubber-soled foot gear (tennis shoes, river sandals, etc.); swimsuit or shirt and shorts that will dry quickly (nylon, fleece, other synthetics, or wool); sunscreen and lip balm; sunglasses with strap; bandanna or hat; bottled water; and personal necessities. Price includes round-trip transportation, rafting trip, equipment rental, and guide gratuity.

Student Informal Mixer: Cowboy Lounge

Saturday, July 10

5:30 pm – 8:00 pm

Tickets: \$18

Meet in the lobby of the Comfort Inn at 5:30 and we'll walk as a group down 16th Street Mall to Cowboy Lounge at 1941 Market St. (near Coors Field). Cowboy Lounge is the only country and western bar in downtown Denver offering country and rock music. The atmosphere captures the true Wild West with its western cowboy flair, spacious dance floor, dance lessons, and movie screens. Ticket price includes Backyard Barbecue dinner.

Open Meeting: Becoming an ADSA Volunteer Leader

Sunday, July 11

11:30 am – 12:30 pm

Grand Hyatt, Maroon Peak

Why become an ADSA Volunteer Leader? Come to this meeting to find out! Whether you want to get started as a volunteer or are already serving on an ADSA committee, this meeting will help you understand the benefits of leadership, what ADSA is doing, where ADSA is headed, and how you can help us get there.

SAD Midday Mixer and Pizza Party

Sunday, July 11

12:00 – 1:00 pm

Convention Center, 704/706

Tickets: \$5

Join your fellow dairy club members for a fun hour of getting reacquainted and making new friends. Lunch includes pizza, salad, and beverages. Registration is limited to undergraduate and graduate students and advisors.

JDIP Meeting

Sunday, July 11

1:00 pm – 6:00 pm

Grand Hyatt Denver, Mt. Sopris

Join with Johne's Disease Integrated Program (JDIP) members and others with an interest in Johne's disease to learn more about JDIP, get updates on current work in each of JDIP's Core and Project areas and provide input on future plans. In addition to Sunday's meeting, approximately 40 Johne's related abstracts will be presented in poster and oral presentation sections on Monday that are part of the JAM Animal Health – Johne's/JDIP program. All JAM registrants are welcome to attend any of the sessions.

SAD-Dairy Quiz Bowl Final Round

Sunday, July 11

5:30 – 6:00 pm

Convention Center, 705

On Sunday, university teams from across the US will compete in the ADSA Dairy Quiz Bowl. The event gives schools an opportunity to demonstrate their knowledge about dairy production, processing, and ADSA history. The Student Affiliate Division (SAD) invites you to join them for the excitement of the final round of competition as the top two schools go head-to-head for the title of 2010 Dairy Quiz Bowl Winning Team.

Opening Session**Sunday, July 11****7:00 – 8:00 pm****Convention Center, Wells Fargo Theater**

Come help us kick off the 2010 Joint Annual Meeting at the opening session. We will be paying tribute to a Colorado legend, John Denver, by featuring John Adams in “The Absolute Best John Denver Tribute Concert.”

Opening Reception**Sunday, July 11****8:00 – 10:00 pm****Convention Center, Korbel Ballroom**

Wind down the evening by joining us after the opening session for desserts, beverages, and some long-awaited socializing time with colleagues and friends.

ASAS Graduate Student Open Forum**Monday, July 12****12:30 – 1:30 pm****Convention Center, Korbel Ballroom 2c**

The ASAS Graduate Student Directors invite all ASAS graduate student members to an open forum on Monday, July 12. This forum has been established for three purposes: 1) to allow for representatives from graduate student organization to interact and exchange ideas to bring back to their respective universities; 2) to provide an opportunity for graduate students to voice their opinions and concerns on what the society can do to improve services to graduate students; and 3) to inform students about the activities and services ASAS has to offer graduate students and early career professionals. All graduate students are welcome.

Exhibitor Reception**Monday, July 12****4:00 – 6:00 pm****Convention Center, Exhibit Hall F**

Relax after a high-energy first day of meeting with beverages and snacks in the exhibit hall. While there, take some time to peruse the exhibits to learn more about the latest products and services in our industries.

Address by Dr. Roger Beachy, Director of NIFA**Monday, July 12****5:00 – 6:00 pm****Convention Center, 403/404**

Please take this opportunity to attend a presentation by Dr. Roger Beachy, Director of the National Institute of Food and Agriculture (NIFA). NIFA replaced the former Cooperative State Research, Education and Extension Service (CSREES), and its mission is to advance knowledge for agriculture, the environment, human health and well-being, and communities by supporting research, education, and extension programs in the land-grant university system and other partner organizations. NIFA helps fund research, education, and extension at the state and local levels and provides program leadership in these areas. Dr. Beachy will speak for 30 minutes, followed by a question and answer session.

ASAS Awards Program**Monday, July 12****7:00 – 8:30 pm****Convention Center, Korbel Ballroom 4abc**

All meeting participants, families, and friends are welcome to attend the 2010 ASAS awards program. Please join us at this special event to recognize and congratulate the ASAS award winners at the **Colorado Convention Center** on Monday, July 12.

Graduate Student Mixer**Monday, July 12****9:00 pm****Blake Street Vault****1526 Blake Street****LoDo Denver**

The Graduate Student Mixer, a regular JAM event, will be held 9:00 pm on Monday night at the Blake Street Vault (<http://www.blakestreetvault.com/>), which is located in LoDo Denver. If graduate students register prior to the meeting, they will receive free beverage tickets, but registration is not necessary to attend the event. The mixer is a great opportunity to catch up with old friends and make new ones at an historic Denver tavern. Preregistration is highly recommended.

Student Informal Mixer: Lucky Strike Lanes and Lounge**Monday, July 12****6:00 pm – 8:00 pm**

No ticket required, meet in the lobby of the Comfort Inn to walk as a group.

Bowling, billiards, fun food, and drinks await at Lucky Strikes Lanes and Lounge on the 16th Street Mall. Enjoy the retro feel and experience the cool vibe. Premium, upscale bowling alleys with lane-side food service including a menu of appetizers, burgers, sandwiches, pizza, finger foods, salads, and desserts.

Spouse Event No. 1**Tuesday, July 13****9:00 am – 1:00 pm****Tour departs from the Hyatt Regency***Tickets: \$45*

Get out your walking shoes and join in on a creative and entertaining way to see the city. Denver Inside and Out is a walking tour/scavenger hunt/street theater based on the 1922 robbery of the Denver Mint. Participants of the tour unwittingly become accomplices in Denver's most famous crime mystery. This downtown adventure takes in the city's most noted landmarks. Guests use old-fashioned elbow grease and shoe leather to unravel the hidden clues while coming face to face with the bandits of the actual crime as they try and untwist one of Colorado's most notorious crimes. Tour begins at the Hyatt Regency, directly across the street from the Convention Center. Tours will leave every 15 minutes in groups of 10 and then all will meet up at the end where you will be escorted to the shuttle and dropped off for lunch at the wonderful Rialto Café.

Preregistration for this event is required.

SAD Career Roundtable**Tuesday, July 13****9:30 – 11:00 am****Convention Center, 705**

Students will have the opportunity to visit with industry professionals representing various facets of the animal agriculture industry. They will learn about careers in the industry, get useful tips on planning for their careers, and much more. Students are encouraged to dress professionally (business casual or better) and bring several copies of their resumes. Students should also plan time to visit industry representatives in the exhibit hall for information about internships and job opportunities.

SAD Awards Luncheon**Tuesday, July 13****11:45 am – 2:00 pm****Convention Center, 704/706**

Plan to attend this year's SAD awards luncheon. The afternoon will be capped with presentation of student awards and announcement of new SAD officers. Both students and professionals are encouraged to attend. This is a wonderful chance to get to know the next generation of the dairy industry.

Northeast ASAS/ADSA Business Meeting and Awards Lunch**Tuesday, July 13****12:30 pm – 2:00 pm****Convention Center, 711***Tickets: \$30*

Join us for lunch to celebrate the winners of the Northeast ASAS section and ADSA branch awards. Lunch will be followed by the Northeast ASAS/ADSA Business Meeting.

Western Section-ASAS Awards Lunch

Tuesday, July 13

12:30 pm – 2:00 pm

Convention Center, 708/710/712

Tickets: \$30

All Western Section members of ASAS are invited to the WSASAS Awards Luncheon to congratulate our award winners.

ASAS GS Lunch and Learn: Preparing for the Transition: Navigating the Job Market in a Difficult Economy

Tuesday, July 13

12:30 – 2:00 pm

Convention Center, 703

Enjoy lunch and an informal discussion with a diverse panel of academic, industry, and government professionals ready to answer your questions. Topics discussed will include the application process, interview skills, and marketing yourself in today's job market. Differences in landing a job in academia, industry, or government will be highlighted. This event is open to ASAS graduate students, and preregistration is necessary to receive lunch.

PSA Student Luncheon

Tuesday, July 13

12:30 – 2:00 pm

Crowne Plaza, Library and Museum

If you are a student and a member of the Poultry Science Association and you want to know more about PSA and its plans for the future, join us for an update from the student membership. This is a great time to meet other students in poultry science and to make new friends.

The ASAS Open Forum

Tuesday, July 13

4:30 – 5:00 pm

Convention Center, 405

Attendees are invited to The ASAS Open Forum in the Convention Center. You will have the opportunity to join discussions on current ASAS issues.

FASS Update

Tuesday, July 13

5:00 – 6:00 pm

Convention Center, 507

Plan to attend the FASS Update to hear an update from headquarters and learn about the work being done in Washington, DC. The session will include a presentation by our current science policy directors, Lowell Randel and Walt Smith. Also speaking will be the 2009–2010 FASS Congressional Science Fellow, Avenel Joseph.

ADSA Awards Program

Tuesday, July 13

7:00 – 8:00 pm

Grand Hyatt, Grand Ballroom

All meeting participants, families, and friends are welcome to attend the 2010 ADSA awards program. Please join us at this special event at the Grand Hyatt to recognize and congratulate the 2010 award winners.

2010 ADSA-PSA-AMPA-CSAS-WSASAS-ASAS Ice Cream Social

Tuesday, July 13

8:15 – 9:30 pm

Grand Hyatt, Imperial Ballroom

Ice cream—we're going to eat ice cream! All meeting participants, families, friends, and award donors are invited to join us for the time-honored ice cream social.

PSA/WPSA-USA-Canada Student Mixer**Tuesday, July 13****9:30 pm****Meet in the lobby of the Crowne Plaza**

Poultry science students are invited to meet in the lobby of the Crowne Plaza at 9:15 to walk over as a group or pick up a map and head out for a trip back to the Old West. The fun will begin at 9:30 at the Blake Street Vault. Enjoy a classic western saloon dating back to 1863, Old West food and drinks with Jack Daniels whiskey tastings as well as old favorites like Moscow Mules. The mixer is sponsored by the Poultry Science Association and the US and Canadian branches of the World's Poultry Science Association

Spouse Event No. 2**Wednesday, July 14****10:00 am – 1:00 pm****Bus departs from the Convention Center***Tickets: \$45*

You will board the bus at the Colorado Convention Center and then sit back and enjoy the ride on Banjo Billy's Bus Tour! This historic tour of Denver takes place on an old school bus tricked out to look like a traveling hillbilly shack. Hear ghost tales, crime stories, and history while sitting on a couch, recliner, or saddle as the bus rolls through the core of the city. The bus will then drop you off at Marlowe's Restaurant, where you'll enjoy a delicious lunch!

Preregistration for this event is required. Register early—capacity is limited.

Global Networking Reception**Wednesday, July 14****4:30 – 5:30 pm****Convention Center, Korbel Ballroom 4abc**

All meeting participants, families, and friends are welcome to attend the global networking reception on Wednesday evening. Again this year, attendees will have the opportunity to indicate their home affiliation on a world map; check the exhibit hall for the poster board before the reception.

PSA Awards Banquet**Wednesday, July 14****6:00 – 10:00 pm****Convention Center, Four Seasons Ballroom 1&2***Tickets: \$35*

Please join us for a celebratory evening honoring the 2010 PSA award winners. All meeting participants, spouses, and friends are welcome at this event. The evening is sure to be a good time for all. Please make sure to purchase your ticket in advance. A limited number of tickets will be available for purchase at the registration desk.

CSAS Awards Banquet**Wednesday, July 14****6:00 – 8:30 pm****Denver Marriott, Ballroom Suites I–III***Tickets: \$61*

Please join us in honoring the 2010 CSAS award winners. All meeting participants, spouses, and friends are invited to attend this celebratory event. Please make sure to purchase your tickets in advance, as a limited number of tickets will be available for purchase at the registration desk.

AMPA Dinner**Wednesday, July 14****6:30 – 10:30 pm****Convention Center, 708/710/712***Tickets: \$35*

What better way to wrap up the week's events than at the AMPA dinner fiesta! All are invited to enjoy good food and friendship with AMPA members as the 2010 ADSA-PSA-AMPA-CSAS-WSASAS-ASAS Joint Annual Meeting draws to a close.

2010 ADSA Award Donors

ABS Global Inc.
ADSA
ADSA Foundation
Alltech Biotechnology Center
American Feed Industry Association
Cargill Animal Nutrition
Cargill Flavor Systems
Dairy Management Inc.
Danisco USA Inc.
DeLaval Inc.
Elanco Animal Health

Hoard's Dairyman
International Dairy Foods Association
Kraft Foods
Land O'Lakes
Land O'Lakes Purina Feed LLC
Milk Industry Foundation
National Milk Producers Federation
Nutrition Professionals Inc.
Pfizer Animal Health
Pioneer, A DuPont Company
West Agro Inc.

2010 ASAS and ASAS Western Section Award Donors

ABS Global Inc.
American Feed Industry Association
American Society of Animal Science
American Society of Animal Science Foundation
Center for Regulatory Services, Inc.
DSM Nutritional Products Inc.
Elanco Animal Health

Land O'Lakes, Purina Mills LLC
Merial Limited
Morrison Award Fund
Omega Protein Corporation
Pfizer Animal Health
The Iams Company
Zinpro Corporation

2010 PSA Award Donors

Alltech Inc.
American Egg Board
American Feed Industry Association
American Poultry Historical Society
Aviagen Turkeys
Embrex Inc.
Evonik Degussa Corporation
Hy-Line International
Jones-Hamilton Co.
Maple Leaf Farms

Merial Select Inc.
National Chicken Council
National Turkey Federation
Novus International Inc.
Perdue Farms Inc.
Phibro Animal Health
Poultry Science Association
Tyson Foods Inc.
United Egg Producers

2010 CSAS Award Donors

Alltech
Nutreco
Elanco Animal Health

Dairy Farmers of Canada, Canadian Pork Council,
and Chicken Farmers of Canada
Pfizer Animal Health

Exhibit Schedule

Sunday, July 12	Exhibit Setup	10:00 am – 6:00 pm
Monday, July 13	Exhibits Open	8:00 am – 5:00 pm
	Exhibitor Reception	4:00 pm – 6:00 pm
Tuesday, July 14	Exhibits Open	8:00 am – 5:00 pm
Wednesday, July 15	Exhibits Open	8:00 am – 2:00 pm
	Exhibit Dismantle	2:00 pm – 5:00 pm

Exhibit Floor Plan

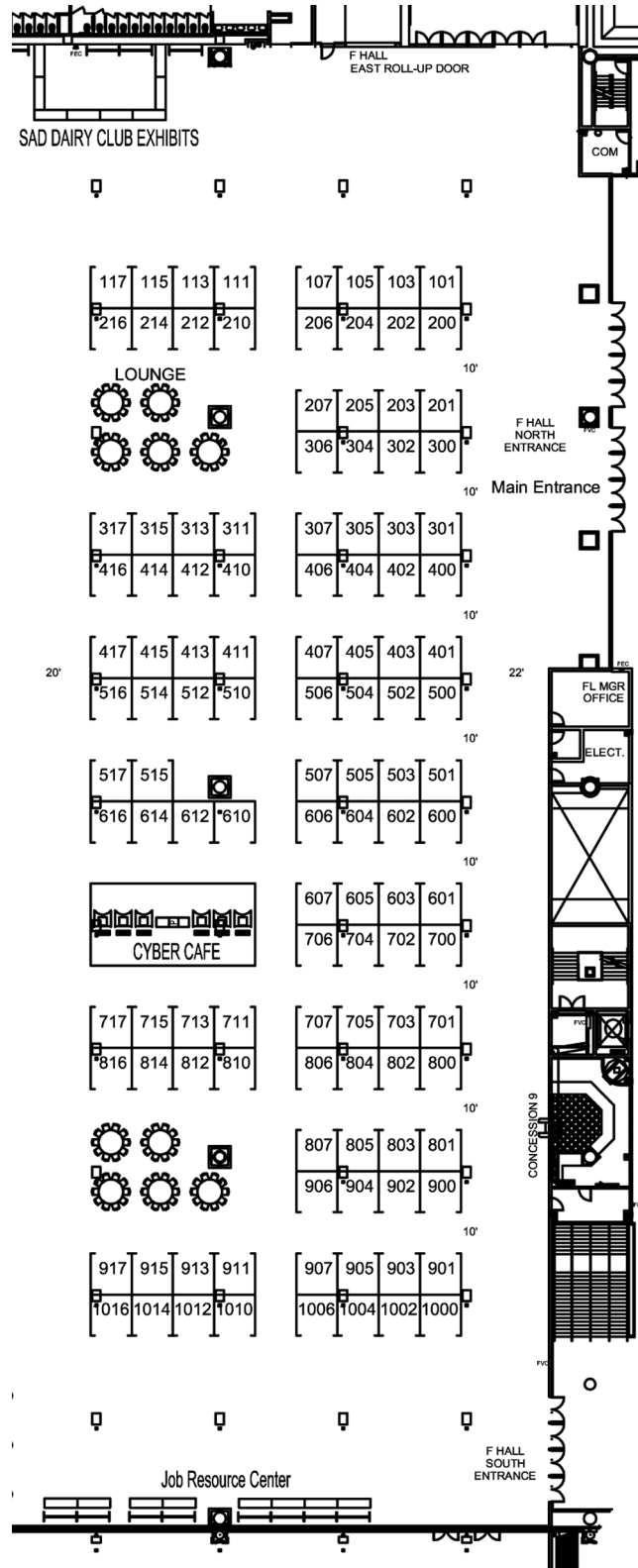

Guide to Exhibitors/Booth Numbers

AAALAC	406	FeedAC	802
Acadian Agritech.	715	Feedstuffs	304
Adisseo	801, 803, 900, 902	GTC Nutrition	202
Ag Processing Inc.	413	H.J. Baker & Bro. Inc.	516
Alltech	315, 317, 414, 416	Ice Robotics Limited.	915, 917
Aloka Ultrasound	607	International Ingredient Corp.	401
Alternative Design Mfg.	510	Jefo Nutrition Inc.	205
American Dairy Science Association (ADSA)	604	Johne's Disease Integrated Program	204
American Society of Animal Science (ASAS).	700	<i>Journal of Animal Science (JAS)</i>	704
Analab	404	Kahne Limited	711
Ankom Technology	410	Kemin Industries	911, 912
Arm & Hammer Animal Nutrition	207	Lallemand Animal Nutrition.	403
ARPAS.	514	Lotek Wireless Inc.	214
ASAS Foundation	702	National Animal Health Monitoring System (NAHMS)	804
Asociación Mexicana de Producción Animal (AMPA)	814	Nottingham University Press	412
A-Tech Global (an MES Company)	601, 603	Novus International	300, 302
Balchem	507	Omega Protein Inc.	500
Biomim	706	Pearson.	612
Buchi Corporation	506	PetAg Inc.	306
CABI Publishing	703, 705	Phode International.	806
Cambridge University Press	701	Poultry Protein & Fat Council	206
Chr. Hansen	301, 303	Poultry Science Association (PSA)	805
C-Lock Inc.	812	Prince Agri Products.	606
Cumberland Valley Analytical Services	311	Probiotech International, Inc	707
Dairy Records Management.	210	Saf Agri/Lesaffre Feed Additives	402
Dalex Livestock Solutions LLC	212	Sigma Xi	203
Diamond V Mills	515, 517, 614, 616	Soybean Meal Information Center.	415
Distillers Grains Technology Council	313	SoyBest.	717, 816
DSM Nutritional Products	807	SoyPLUS, SoyChlor (West Central)	610
EAAP	605	Unity Scientific, Inc	407
Elsevier	400	USDA–Animal Welfare Information Center	505
Estroject	216	Varied Industries Corporation.	501, 503, 600, 602
Evonik Degussa Corp	305, 307	Virtus Nutrition.	417
FDA–Center for Veterinary Medicine	713	Western Yeast Company	512
Federation of Animal Science Societies (FASS)	405	Wiley-Blackwell.	201
Feed Management Systems.	411	Zinpro	101, 200

**A special thank you to our
2010 ADSA®-PSA-AMPA-CSAS-WSASAS-ASAS
Joint Meeting Exhibitors!**

Exhibit Directory

AAALAC

**5283 Corporate Dr Ste 203
Frederick, MD 21703-2879
<http://www.aaalac.org>
Booth(s): 406**

AAALAC International offers accreditation and education services for agricultural animal research programs. Earning accreditation demonstrates dedication to responsible animal care. It also assures research partners, funding sources, and the public of a commitment to quality research and good science. More than 800 institutions in 32 countries have earned AAALAC accreditation.

Acadian Agritech

**30 Brown Avenue
Dartmouth, NS B3B1X8, Canada
Phone: (902) 468-2840; Fax: (902) 468-3474
<http://www.tasco.ca>
Booth(s): 715**

Tasco is a functional food designed to address critical production issues in today's livestock industry. All-natural Tasco helps modulate functions relative to health, productivity, and stress resistance. Tasco is generally regarded as safe (GRAS) in animal feeds.

Adisseo

**4400 N Point Pkwy Ste 275
One Point Royal
Alpharetta, GA 30022-2429
Phone: (678) 339-1502; Fax: (678) 339-1602
<http://www.adisseo.com/>
Booth(s): 801, 803, 900, 902**

At Adisseo, we are nutritionists, with a long tradition of applying our expertise to nutritional additives. We are dedicated to serving the animal production industry by helping premixers, feed manufacturers and integrators to improve their performance and to become more competitive.

Ag Processing Inc.

**PO Box 2047
Omaha, NE 68103-2047
Phone: (402) 492-3309; Fax: (402) 496-6686
<http://www.amino-plus.com>
Booth(s): 413**

AminoPlus is the number one volume bypass protein soybean meal dairy supplement in the United States. The patented AminoPlus process utilizes soybean meal to provide high amino acid quality, rumen bypass and intestinal digestibility without the addition of chemicals or non-soybean components.

Alltech

**3031 Catnip Hill Rd
Nicholasville, KY 40356-8700
Phone: (859) 887-3245; Fax: (859) 887-3256
<http://www.alltech.com>
Booth(s): 315, 317, 414, 416**

For more than 25 years, Alltech has been researching and providing all-natural nutritional solutions that benefit animal health, performance, and productivity. Alltech's cutting-edge brands—Yea-Sacc 1026, Sel-Plex, Bio-Mos, MTB-100, Bioplex, and Sil-All—set a unique example of how all-natural technologies backed by dedicated research can move the industry forward.

Aloka Ultrasound

**10 Fairfield Blvd
Wallingford, CT 06492-5903
Phone: (203) 269-5088 x228; Fax: (203) 269-6075
<http://www.alokavet.com>
Booth(s): 607**

Aloka, the innovator in ultrasound, offers a full line of veterinary ultrasound systems. The Alpha 10 and Alpha 5 offer superb image quality for the most challenging cases. More cost effective solutions are the SSD-3500 and SSD-4000. Our two portables, the SSD-500 and SSD-900, are reliable and rugged systems.

Alternative Design Mfg.

**PO Box 6330
Siloam Springs, AR 72761-6330
Phone: (479) 524-4343; Fax: (479) 524-4125
Booth(s): 510**

Alternative Design Manufacturing designs and manufactures poultry caging systems for poultry science and commercial enterprises. Caging units include start grow, brooders, laying hen, artificial insemination, and feed conversion housing systems. Caging is made from either PVC coated wire or stainless steel wire mesh.

American Dairy Science Association (ADSA)

**2441 Village Green Place
Champaign, IL 61822-7676
Phone: (217) 356-3182; Fax: (217) 398-4119
<http://www.adsa.org>
Booth(s): 604**

Established in 1906, ADSA is an international organization of educators, scientists, industry, and government representatives who are committed to advancing the dairy industry. All are keenly aware of the vital role the dairy sciences play in fulfilling the economic, nutritive, and health requirements of the world's population. Together, ADSA members have discovered new methods and technologies that have revolutionized the dairy industry. Please visit www.adsa.org for more information.

American Society of Animal Science (ASAS)
2441 Village Green Place
Champaign, IL 61822-7676
Phone: (217) 356-3182; Fax: (217) 398-4119
<http://www.asas.org>
Booth(s): 700

Established in 1908, ASAS is a professional organization for animal scientists designed to help members provide effective leadership through research, extension, teaching, and service for the dynamic and rapidly changing livestock and meat industries. Please visit www.asas.org for more information.

Analab
PO Box 208
Fulton, IL 61252-0208
Phone: (815) 589-2525; Fax: (815) 589-4568
<http://www.analabtest.com>
Booth(s): 404

Analab is a premier state-of-the-art laboratory and research facility operated by an innovative, pioneering team of professional chemists and microbiologists.

Ankom Technology
2052 O'Neil Rd
Macedon, NY 14502-8953
Phone: (315) 986-8090; Fax: (315) 986-8091
<http://www.ankom.com>
Booth(s): 410

Ankom Technology is best known for the development of filter bag technology for automating fiber and fat analysis in foods and feeds. Ankom has products supporting in vitro digestibility, in vitro gas production, and in situ digestibility. Ankom products are in use in over 90 countries around the world.

Arm & Hammer Animal Nutrition
469 N Harrison St
Princeton, NJ 08540-3510
Phone: (609) 279-7335; Fax: (609) 497-7176
<http://www.AHDairy.com>
Booth(s): 207

Arm & Hammer Animal Nutrition is a leading supplier of dairy feed ingredients that work to improve producer profitability. We've developed a wide range of innovative products to address the dairy nutrition challenges today's producers face. Trust Arm & Hammer Animal Nutrition for innovative, proven, and reliable nutritional solutions.

ARPAS
2441 Village Green Place
Champaign, IL 61822-7676
Phone: (217) 356-5390; Fax: (217) 398-4119
<http://www.arpas.org>
Booth(s): 514

ARPAS is the organization that provides certification of animal scientists through examination, continuing education, and commitment to a code of ethics. Continual improvement of individual members is catalyzed through publications (including *The Professional Animal Scientist journal*) and by providing information on educational opportunities.

ASAS Foundation
2441 Village Green Place
Champaign, IL 61822
Phone: (217) 356-9050; Fax: (217) 398-4119
Booth(s): 702

The ASAS Foundation was created by the ASAS Board of Directors to identify individual and corporate entities that seek to enhance and perpetuate the activities of the society. The Foundation seeks to create a nucleus of funds and investments from which its Board of Directors and its membership may address critical issues facing the profession. Moreover, we would encourage the funding of ventures into new areas that will assist the society and its members in obtaining excellence in a highly dynamic industry. We visualize a corpus of funds composed of gifts, grants, endowments, and appreciation clubs, each tailored to the needs and wishes of the donor and that are consistent with the mission of the society.

Asociación Mexicana de Producción Animal (AMPA)
Booth(s): 814

AMPA is a scientific, non-governmental, and non-profit organization; its members include researchers, students, and producers.

A-Tech Global (an MES Company)
5757 W Century Blvd, Ste 805
Los Angeles, CA 90045-6409
Phone: (818) 917-1074; Fax: (323) 935-1221
<http://www.a-tech-america.com>
Booth(s): 601, 603

A-Tech Global presents our line of automated sperm quality analyzers for studs, bovine veterinarians, and dairymen. The systems precisely calculate post thaw progressive motility for high-fertility dosing, sperm concentration, and morphology.

Balchem
PO Box 600
52 Sunrise Park
New Hampton, NY 10958-0600
Phone: (845) 326-5600; Fax: (845) 326-5742
<http://www.balchem.com>
Booth(s): 507

Balchem's Animal Nutrition and Health Division brings the benefits of patented proprietary micro-encapsulation and chelated trace mineral technology to the livestock, poultry, and companion animal industries. Encapsulation and chelation technologies offer "protection nutrition" to sensitive compounds. Hence, these compounds become bioavailable when and where they offer the most benefit to the animal. Our products include ReaShure, NiaShure, AminoShure-L, NitroShure, KeyShure, VitaShure, and choline chloride.

Biomin
1846 Lockhill Selma Rd, Ste 101
San Antonio, TX 78213-1551
Phone: (210) 342-9555; Fax: (210) 342-9575
Booth(s): 706

Biomin is a customer-oriented company with the objective to enhance productivity and unlock the performance potential of livestock. Based on intense research, BIOMIN develops and produces feed additives and premixes in accordance with latest know-how and with state-of-the-art production technology. Their top brands are Biofix Plus and Biofix Select.

Buchi Corporation
19 Lukens Dr, Ste 400
New Castle, DE 19720-2787
<http://www.mybuch.com>
Booth(s): 506

Dedicated to reliability, automation and safety, products include Evaporation systems, Syncore synthesis systems, Spray drying, Spray chilling, Melting point systems, Flash and Preparative Chromatography, Soxhlet extractors, Automated Kjeldahl systems and FT-NIR systems as well as a range of Support Solutions from Method development, Application support and direct Buchi® Service Department.

CABI Publishing
22883 Quicksilver Dr
Sterling, VA 20166-2019
Phone: (703) 996-1012
<http://www.cabi.org>
Booth(s): 703

CABI is a not-for-profit international organization that improves people's lives by providing information and applying scientific expertise to solve problems in agriculture and the environment. Our mission and direction is influenced by our member countries who help guide the activities we undertake.

CABI Publishing
Nosworthy Way
Wallingford, Oxfordshire OX10 8DE, United Kingdom
Phone: +44 1491829376
<http://www.cabi.org>
Booth(s): 705

CABI is a not-for-profit international organization that improves people's lives by providing information and applying scientific expertise to solve problems in agriculture and the environment. Our mission and direction is influenced by our member countries who help guide the activities we undertake.

Cambridge University Press
32 Avenue of The Americas Bldg 1
New York, NY 10013-2473
<http://journals.cambridge.org>
Booth(s): 701

Cambridge University Press publishes high-quality books and journals, including *Animal: The International Journal of Animal Bioscience* on behalf of The Animal Consortium, and *Animal Health Research Reviews* in collaboration with the Conference of Research Workers in Animal Diseases. Please stop by our booth to peruse these and other publications.

Chr. Hansen
9015 W Maple St
Milwaukee, WI 53214-4213
Phone: (414) 607-5739; Fax: (414) 607-5704
<http://www.chr-hansen.com>
Booth(s): 301, 303

Chr. Hansen Animal Health & Nutrition has been ranked as the most trusted direct-fed microbial source by dairy nutritionists. As the "world's microbial experts," Chr. Hansen has been the leading supplier of lactic acid bacteria and other ingredients since 1874. A history rich in science, research, and product quality has produced products such as Probios, Biomate, Biomax, and BioPlus.

C-Lock Inc.
2525 West Main St.
Rapid City, SD 57702
Phone: (605) 791-5657
<http://c-lockinc.com>
Booth(s): 812

GreenFeed is a low-cost (patent pending) system to measure CH₄ and CO₂ emissions from ruminants remotely in a noninvasive way. CH₄ and CO₂ data collected several times daily provides valuable feedback on the performance of individual animals and can aid in maintaining animal health and in maximizing feed efficiency.

Cumberland Valley Analytical Services
14515 Industry Dr
Hagerstown, MD 21742-2410
Phone: (301) 790-1980; Fax: (301) 790-1981
<http://www.foragelab.com>
Booth(s): 311

Cumberland Valley Analytical Services is a full-service forage and feed testing laboratory specializing in chemistry analysis.

Dairy Records Management
313 Chapanoke Rd, Ste 100
Raleigh, NC 27603-3434
Phone: (919) 661-3100; Fax: (919) 661-3145
<http://www.drms.org>
Booth(s): 210

Dairy Records Management Systems provides innovative dairy information products and services for producers, DHIA staff, consultants and other dairy industry professionals. Comprehensive processed reports include Transition Cow Management, Survival Analysis and Persistency Analysis. Leading-edge software and web tools include PCDART, PocketDairy, Herd Detective, DairyMetrics, WebReports, and Reports On-Demand.

Dalex Livestock Solutions LLC
240 Industrial Blvd
Waconia, MN 55387-1734
Phone: (952) 442 4251 Ext. 158; Fax: (952) 831-4251
<http://www.dalex.com>
Booth(s): 212

Dalex Livestock Solutions LLC is the leading provider of ration formulation software and related livestock solutions. Current programs include The Consulting Nutritionist, Dairy Record Manager, Feed Tag and Beef Profit Projection. Dalex has provided a complete solution to formulate, analyze and monitor livestock feeding situations since 1980.

Diamond V Mills
838 1st St NW
Cedar Rapids, IA 52405-2713
Phone: (563) 880-4343; Fax: (319) 366-6333
<http://www.diamondv.com>
Booth(s): 515, 517, 614, 616

Diamond V, headquartered in Cedar Rapids, Iowa, provides nutritional fermentation products that optimize digestive function and nutrition key to animal and aqua health, productivity, efficiency and profitability. Our commitment to innovation, technology, and quality has earned Diamond V a global reputation of trust and reliability within the animal feed industry. We help our customers succeed by sharing knowledge, innovation and capability. The benefit is real because the Diamond V investment and commitment is real.

Diamond V's innovative brands—Original family (Original XPC, XP and YC), DiaMune Se, SelenoSource and DV Aqua—are research proven and engineered to deliver results.

Distillers Grains Technology Council
435 Lutz Hall
University of Louisville
Louisville, KY 40292-0001
Phone: (502) 852-1575; Fax: (502) 852-1577
<http://www.distillersgrains.org>
Booth(s): 313

Distillers Grains Technology Council (DGTC) is a nonprofit association of fuel and beverage ethanol and distillers grains producers that was established in 1945. At the DGTC exhibit booth we will have information on feeding wet and dry distillers grains to dairy and beef cattle, calves, sheep, goats, poultry, and horses and combining it with other feed ingredients to reduce corn usage and costs. Stop by and let's talk about the rapidly growing availability of distillers grain and its feed value.

DSM Nutritional Products
45 Waterview Blvd
Parsippany, NJ 07054-7611
Fax: 973-257-8653
<http://unlimitednutrition-na.dsm.com>
Booth(s): 807

DSM Nutritional Products is the leading supplier of vitamins, carotenoids, enzymes, and direct-fed microbials to the animal feed industry. With its extensive network of premix plants, DSM Nutritional Products is optimally poised to deliver these essential micronutrients as straight ingredients or through ROVIMIX premix.

EAAP
Via G. Tomassetti 3 A/1
I-00161 Rome, Italy
Phone: +39 06 44202639; Fax: + 39 06 44266798
<http://www.eaap.org>; <http://www.waap.it>

EAAP is a federation of national member organizations and has now, together with ASAS, established individual membership so that scientists not resident in EAAP countries can participate and sustain EAAP and ASAS activities jointly. Any scientist having interest in animal science or animal industry and wishing to participate in EAAP and ASAS activities can jointly apply for individual membership to both organizations at a lower price (and receive electronic access to *Animal* and the *Journal of Animal Science*).
www.eaap.org or www.eaap.org/Content/Individual_Member_Information.html

Elsevier
1600 John F Kennedy Blvd, Ste 1800
Philadelphia, PA 19103-2398
Phone: (215) 239-3491; Fax: (215) 239-3494
<http://www.elsevier.com>
Booth(s): 400

Elsevier is a world-leading multiple media publisher of Science, Technology and Health information products and services. We are proud to publish the *Journal of Dairy Science*® (JDS), official journal of the American Dairy Science Association®. Please visit the Elsevier stand in the exhibition hall with any questions you might have about claiming member access on the new JDS website (www.journalofdairyscience.org) and to browse our other journal titles in animal science.

EstroTECT
PO Box 39
Spring Valley, WI 54767-0039
Phone: (952) 892-0291; Fax: (715) 778-5817
<http://www.estroTECT.com>
Booth(s): 216

EstroTECT Heat Detectors are a unique breeding management tool for artificial insemination, embryo transfer recipient management and natural breeding programs. The simple scratch-off surface show evidence of multiple mountings which give reliable indications of estrus and increase breeding success in many programs. EstroTECT detectors have been used successfully in all the major agricultural countries, in all kinds of environments around the world with great success. EstroTECT continues to provide "mounting evidence" for breeding success.

Evonik Degussa Corp
1701 Barrett Lakes Blvd NW Ste 340
Kennesaw, GA 30144-4509
Phone: (678) 797-4311; Fax: (678) 797-4313
<http://www.aminoacidsandmore.com>
Booth(s): 305, 307

Degussa is the only company in the world to supply from a single source all four of the important amino acids for animal nutrition: DL-methionine, Biolys® (L-lysine), L-threonine, and L-tryptophan. Mepron®, a rumen-protected DL-methionine, rounds off the company's product range as part of its "one source" strategy.

FDA—Center for Veterinary Medicine
7519 Standish Pl
Rockville, MD 20855-2792
Phone: (301) 827-3800; Fax: (301) 827-4065
<http://www.fda.gov/animalveterinary/default.htm>
Booth(s): 713

The Center for Veterinary Medicine (CVM) regulates the manufacture and distribution of food additives and drugs that will be given to animals from which human foods are derived, as well as food additives and drugs for pet (or companion) animals. CVM is responsible for regulating drugs, devices, and food additives given to, or used on, over one hundred million companion animals, plus millions of poultry, cattle, swine, and minor animal species. (Minor animal species include animals other than cattle, swine, chickens, turkeys, horses, dogs, and cats.)

Federation of Animal Science Societies
2441 Village Green Place
Champaign, IL 61822-7676
Phone: (217) 356-3182; Fax: (217) 398-4119
<http://www.fass.org>
Booth(s): 405

The Federation of Animal Science Societies (FASS) was formed in 1998 by three founding member societies: the American Dairy Science Association® (ADSA®), the American Society of Animal Science (ASAS), and the Poultry Science Association (PSA). FASS is unique in that we support common agricultural interests and, at the same time, streamline administrative expenses while preserving the societies' traditions and values. We specialize in providing a wide array of management services to small- and medium-sized, not-for-profit associations. In addition, each year, PhD scientists in animal science compete for the opportunity to represent FASS in Congress through the Congressional Science Fellowship (CSF) Program. Many of these individuals stay on the Washington scene after their fellowship year and continue to serve animal agriculture in significant ways. Be sure to stop by the FASS booth to hear about DC activities from the 2009–2010 CSF.

Feed Management Systems
6120 Earle Brown Dr Ste 300
Brooklyn Center, MN 55430-4101
Phone: (763) 560-8139
<http://www.feedsys.com>
Booth(s): 411

Feed Management Systems provides integrated software solutions for feed manufacturers to manage their critical formula and production data. Ensure the quality of your feed supply by automating and optimizing formulas, pricing, ordering, inventory, labeling, delivery, traceability, reporting and financials. Solutions: Feed Mill Manager, Brill Formulation, Feed Ration Balancer, Feed Tags.

FeedAC
2441 Village Green Place
Champaign, IL 61822-7676
Phone: (217) 398-4697; Fax: (217) 398-4119
<http://www.feedac.org>
Booth(s): 802

The Feed Analysis Consortium Inc. (FeedAC) is a membership-based nonprofit organization dedicated to the advancement of feed analysis and nutritional modeling. The mission of FeedAC is to serve the animal feed industry by developing improved methods of feed analysis, providing leadership for methods standardization, and building and maintaining a comprehensive and evolving database of feed analysis information for all farm animals. Upon request from its membership, the organization has also committed to providing leadership to standardizing electronic data exchange. The organization also continues to develop collaborations with other organizations to achieve its goals. Be sure to attend this year's annual meeting and stop by the exhibitor booth to get an update on FeedAC activities and to find out how you can get involved!

Feedstuffs

**12400 Whitewater Dr, Ste 160
Minnetonka, MN 55343-4158
Phone: (985) 930-4349; Fax: (952) 938-1832
Booth(s): 304**

Feedstuffs is the only weekly paid news source for agribusiness. Every week, we keep our subscribers informed on the important issues affecting the business of producing food for the world.

GTC Nutrition

**600 Corporate Cir, Ste H
Golden, CO 80401-5604
Phone: (303) 951-6520; Fax: (303) 951-6520
<http://fortifeed.com>
Booth(s): 202**

GTC Nutrition, a business unit of Corn Products International Inc., is a recognized leader in providing innovative ingredients along with scientific, technical and marketing expertise to the animal feed, food process, and dietary supplement industries. GTC Nutrition's flagship animal feed ingredient, FortiFeed prebiotic fiber, selectively stimulates the growth of beneficial microflora in the intestines of animals to improve overall well-being and performance. GTC Nutrition promotes animal and human health globally with innovative functional food ingredients and unsurpassed customer support. For more information, visit www.fortifeed.com.

H.J. Baker & Bro. Inc.

**228 Saugatuck Ave, Ste 1
Westport, CT 06880-6444
Phone: (203) 682-9200; Fax: (203) 227-8351
<http://www.bakerbro.com>
Booth(s): 516**

Pro-Lak Dairy By-Pass Protein is designed to complement the protein from rumen microbial activity and formulated for today's high producing dairy cows. Desired nutrient balance is accomplished by 72% of protein bypassing rumen degradation and delivering the essential amino acid profile to support maximum milk production. For university research and more information see www.bakerbro.com.

Ice Robotics Limited

**Logan Bldg Roslin Biocentre
Roslin, Scotland, United Kingdom
Phone: +44 131 527 4380; Fax: +44 131 527 4381
<http://www.icerobotics.com>
Booth(s): 915, 917**

IceRobotics is developer and sole supplier of the IceTag live-stock activity monitoring system, which has been specifically designed to facilitate both small and large research projects in dairy cattle health and welfare. This system has now been extended to include automated farm download and remote data access through theCattleGrid.com, a new online data management tool.

International Ingredient Corp.

**150 Larkin Williams Ind Ct
Fenton, MO 63026-2409
Phone: (636) 343-4111, x1252; Fax: (636) 349-4845
<http://www.iicag.com>
Booth(s): 401**

International Ingredient Corporation is a manufacturer of specialty ingredients for swine, pets, dairy cattle, aquaculture and poultry. IIC has nine plant locations producing quality ingredients, including DairyLac 80, Nutri-Gold Dried Milk, Brewtech Brewers Yeast, Dried Cheese Products, Dried Bacon Fat, Nutri-Sure, Milk Chocolate Product, Sugar Food Products, and GroBiotic prebiotics.

Jefo Nutrition Inc.

**5020 Jefo Avenue - C.P. 325
St-Hyacinthe, Québec, J2S 7B6, Canada
Phone: (450) 799-2000; Fax: (450) 778-1338
Booth(s): 205**

Jefo Nutrition is a world leader in performance feed additives. Species-specific by design, Jefo performance additives are respectful of nature and increase livestock production economic performance. Since the company was founded, all efforts have been focused to understand and contribute to improving the science, economics, and techniques of agriculture, with the greatest respect for the environment and sustainable development. Our products are top quality and represent an additional advantage in a nutritional program without growth factor antibiotics. Our facilities, processes, and know-how ensure effective and robust products that can withstand the strictest standards and harshest conditions of feed manufacturing. Our products are designed to improve livestock production techniques and increase animal performance, with evidence to prove it.

Johne's Disease Integrated Program (JDIP)

**The Pennsylvania State University
Department of Veterinary and Biomedical Sciences
205 Wartik Laboratory
University Park, PA 16802
Phone: 814-867-0261
Fax: 814-863-6699
<http://www.jdip.org/>
Booth(s): 204**

The Johne's Disease Integrated Program (JDIP) is a consortium of scientists, whose mission is to promote animal bio-security through the development and support of projects designed to enhance knowledge, promote education, and develop real-world solutions to mitigate losses associated with Johne's disease. JDIP is funded by a grant from the USDA-NIFA.

Journal of Animal Science (JAS)
2441 Village Green Place
Champaign, IL 61822-7676
Phone: (217) 356-3185; Fax: (217) 398-4119
<http://jas.fass.org/>
Booth(s): 704

The *Journal of Animal Science* (JAS) is the premier journal for animal science and serves as the leading source of new knowledge and perspective in this area. JAS publishes more than 400 peer-reviewed research articles, invited reviews, technical notes, and letters to the editor each year. According to Thomson-Reuters' Journal Citation Reports, JAS consistently ranks as one of the top journals (among 43 titles) in the category of Agriculture, Dairy, and Animal Sciences in terms of impact factor, immediacy index, and cited half-life and is in the top 1% of STM publishing (50,000+ titles) by total ISI citations.

Kahne Limited
109 Valley Road
Mt. Eden
New Zealand
Phone: (649) 623-4757; Fax: (649) 623-3012
<http://www.kahneanimalhealth.com>
Booth(s): 711

Kahne Ltd. sells wireless rumen sensors and receivers essential for researchers involved in rumen nutrition, animal welfare, and behaviour. Using less invasive practises, Kahne wireless sensors deliver comprehensive and accurate rumen biometric measurements from unrestrained animals

Kemin Industries
600 E Court Ave
Des Moines, IA 50309
Phone: (515) 559-5450
<http://www.kemin.com>
Booth(s): 911, 912

The agrifood businesses of Kemin focus on Total Nutrition to help customers achieve a highly effective, consistent system of profitable animal production. The essential combination of Kemin products with good nutrition and solid animal husbandry ensures that customers around the globe maintain profitability while enhancing the health and well-being of animals.

Lallemand Animal Nutrition
6120 W Douglas Ave
Milwaukee, WI 53218-1548
Phone: (414) 393-4030; Fax: (414) 464-6430
<http://www.lallemandanimalnutrition.com/>
Booth(s): 403

Lallemand Animal Nutrition offers a range of solutions for the dairy industry including Levucell SC and Levucell SB active dry yeast, Biotol forage inoculants, Alkosel organic selenium yeast, Agrimos, and other mineral-enriched yeast supplements.

Lotek Wireless Inc.
115 Pony Dr
Newmarket, ON L3Y 7B5, Canada
Phone: (905) 836-6680; Fax: (905) 836-6455
<http://www.lotek.com>
Booth(s): 214

Lotek is a world leader in the design and manufacturing of innovative wildlife monitoring systems including radio, satellite, GSM and GPS systems.

National Animal Health Monitoring System (NAHMS)
2150 Centre Ave Bldg B-2E7
USDA:APHIS:VS:CEAH
Fort Collins, CO 80526-8116
Phone: (970) 494-7245; Fax: (970) 494-7228
<http://nahms.aphis.usda.gov>
Booth(s): 804

National studies conducted by the National Animal Health Monitoring System (NAHMS) provide essential information on livestock and poultry health and management in the US. Production types are studied at regular intervals, providing up-to-date information needed to monitor US animal health, inform trade decisions, assess research needs, inform the public, and set policy.

Nottingham University Press
Manor Farm, Church Lane, Thrumpton
Nottingham NG110AX, United Kingdom
Phone: +44 (0) 1159 831011; Fax: +44 (0) 1159 831003
<http://www.nup.com>
Booth(s): 412

Based in the UK, Nottingham University Press is owned by the University of Nottingham, a major biosciences university with worldwide recognition. Consequently, Nottingham University Press is a strong brand for scientific books. We publish conference proceedings in a wide range of topics. Our full portfolio of titles is on our website, www.nup.com.

Novus International
20 Research Park Dr
Saint Charles, MO 63304-5633
Phone: (314) 453-7711; Fax: (314) 576-4635
<http://www.novusint.com>
Booth(s): 300, 302

Novus International Inc. is headquartered in St. Louis, Missouri, and serves customers in more than 90 countries around the world. An industry leader in animal nutrition and health, Novus products include Alimet and MHA feed supplements, Activate nutritional feed acid, Acidomix preservative premixture, Advent coccidiosis control, Mintrex organic trace minerals, Santoquin feed preservative, and many other specialty ingredients. Novus is privately owned by Mitsui and Co. Ltd. and Nippon Soda Co. Ltd. For more information, visit our website at www.novusint.com.

Omega Protein Inc.
2101 Citywest Blvd Ste 500
Bldg. 3, Suite 500
Houston, TX 77042-2832
<http://www.omeganutrient.com>
Booth(s): 500

Omega Protein is the world's largest producer of omega-3 fish oil and North America's largest producer of fish meal and fish solubles. These ingredients are used in poultry, swine, pet, equine, aquaculture, and other livestock feeds. Omega Protein is vertically integrated and certified sustainable. Available in bulk, bag, or drums.

Pearson
1 Lake St
Saddle River, NJ 07458-1813
Phone: (201) 236-5894; Fax: (201) 236-5888
<http://www.pearson.com>
Booth(s): 612

Pearson is one of the world's great publishers, publishing more books than any other company and reaching millions of people every day in print and online. Our higher education publishing brands have earned the trust of educators and students because of their commitment to accuracy, integrity, and independence of thought.

PetAg Inc.
255 Keyes Ave
Hampshire, IL 60140-9449
Phone: (847) 683-2288; Fax: (847) 683-2343
<http://www.petag.com>
Booth(s): 306

Bospro is an aspergillus mycelium product for ruminants that has demonstrated remarkable effects on increasing rumen function. Fermacto is an aspergillus mycelium product for monogastrics that has demonstrated increased maturity levels of the gastrointestinal tract of immature poultry. Please stop by our booth for data and samples.

Phode International
Zi Albipole
81150 Terssac, France
Phone: (717) 203-4814
<http://www.phode.com>
Booth(s): 806

Based on its three key areas of expertise—animal health, olfaction and nutrition—the company has developed natural solutions to meet the needs of today's farming. Optimizing the potential of farm animals while preserving their health and well-being is the company's goal, in line with today's increasing environmental and regulatory pressure. Six unique and natural sensory solutions are available, documented for their ability to optimize feed value: VéO, Cristalfeed, Oleobiotec, Optifeed, Glytran, and Phodesweet.

Poultry Protein and Fat Council
1530 Cooledge Rd
Tucker, GA 30084-7303
Phone: (770) 493-9401; Fax: (770) 493-9257
<http://www.poultryegg.org/ppfc/>
Booth(s): 206

The Poultry Protein and Fat Council solicits and sponsors research that would develop new and increased utilization of poultry byproduct meal, feather meal, blood meal, and poultry fat by demonstrating their efficacy in poultry, aquaculture, livestock, and companion animal rations.

Poultry Science Association (PSA)
2441 Village Green Place
Champaign, IL 61822-7676
Phone: (217) 356-5285; Fax: (217) 398-4119
<http://www.poultryscience.org>
Booth(s): 805

The Poultry Science Association (PSA) is a global society consisting of approximately 2,400 educators, scientists, extension specialists, administrators, and producers committed to advancing the poultry industry. The association is dedicated to discovery and dissemination of knowledge generated by poultry research that enhances human and animal health and well-being and provides for the ethical and sustainable production of food. Since 1908, the PSA has maintained a level of prestige that ranks it among the top professional organizations in the field. Please visit www.poultryscience.org for more information.

Prince Agri Products
PO Box 1009
Quincy, IL 62306-1009
Phone: (217) 592-1356
<http://www.princeagri.com>
Booth(s): 606

Prince Agri Products is a global provider of proven, science-based, value-added products for the animal feed industry. Our team of professionals help customers successfully meet their goals through product solutions and problem solving, unequalled quality and credibility, and with superior customer service. Put the Prince team to work for you by calling 217-222-8854; *Advancing Nutrition for Healthy Animals*.

Probiotech International, Inc
6225 Choquette Street
St. Hyacinthe, QC J2S 8L2, Canada
Phone: (450) 771-7252; Fax: (450) 771-4509
<http://www.probiotech.com>
Booth(s): 707

Probiotech International Inc. develops and provides the animal nutrition industry with natural solutions. The line of products was designed using the principles of biotechnology to promote animal health and to maximize agriculture production with respect for our environment in mind. Products range from patented rumen-protected choline for dairy cows to organic acidifiers and plant extracts for swine and poultry.

Saf Agri/Lesaffre Feed Additives
7475 W Main St
Milwaukee, WI 53214-1552
Phone: (414) 615-4138; Fax: (414) 615-4003
<http://www.lfa-america.com>
Booth(s): 402

Lesaffre Feed Additives provides innovative products produced by the Lesaffre Group, the world's oldest and largest yeast manufacturer, to livestock feed producers and pet food manufacturers throughout the Americas. The product line includes active dry yeast for pelleted and non-pelleted feeds, inactive dry yeast, mineral yeast, enzymes, and mannan oligosaccharides.

Sigma Xi
3106 E. NC Highway 54
Research Triangle Park, NC 27709
Phone: (919) 549-4691; Fax: (919) 549-0090
<http://www.sigmaxi.org>
Booth(s): 203

Sigma Xi is an international, multidisciplinary research society that promotes the health of the scientific enterprise and honors scientific achievement. The Society endeavors to encourage support of original work across the spectrum of science and technology and to promote an appreciation within society at large for the role research has played in human progress. Sigma Xi publishes American Scientist magazine, awards grants annually to promising student researchers, and sponsors programs that serve science and society. Programmatic interests include research ethics, science and engineering education, public understanding of science, international research networking, and the overall health of the research enterprise.

Soybean Meal Information Center
1255 SW Prairie Trail Pkwy
Iowa Soybean Association
Ankeny, IA 50023-7068
Phone: (515) 251-8640; Fax: (515) 251-8657
<http://www.soymeal.org/>
Booth(s): 415

The Soybean Meal INFOcenter website is designed to be a "center" or primary source of key information regarding soybean meal as an important supplement protein for livestock, poultry and specialty markets. The website provides information to feed manufacturers, professional nutritionists, feed formulators, livestock and poultry producers and the general public.

SoyBest
PO Box 157
West Point, NE 68788-0157
Phone: (402) 372-2429; Fax: (402) 372-3305
<http://www.soybest.com>
Booth(s): 717, 816

SoyBest High Bypass Soybean Meal is bypass protein for dairy cows. Manufactured by the mechanical process, it contains no chemical solvents and is all natural. SoyBest includes fresh soy gums with lecithin and phosphatidyl choline. Research shows that these nutrients behave like rumen-protected fat, resulting in even more bypass protein with excellent intestinal digestibility.

SoyPLUS, SoyChlor (West Central)
PO Box 68
Ralston, IA 51459-0068
Phone: (712) 667-3200; Fax: (712) 667-3399
<http://www.soyplus.com>
Booth(s): 610

SoyPLUS is the industry leader, consistently delivering dairy bypass protein, unbeatable protein quality and intestinal digestibility. SoyPLUS contains research proven higher energy and rumen inert fat. SoyChlor has proven itself in effectively balancing DCAD in herd health. SoyChlor's key ingredient is hydrochloric acid, the most palatable source of chloride available.

Unity Scientific Inc.
32 Cornerstone Dr
North Easton, MA 02356-2740
Phone: (540) 338-8991; Fax: (540) 338-8992
<http://www.unityscientific.com>
Booth(s): 407

Unity Scientific is a global leader in the design and manufacturing of near infrared instrumentation for a variety of industries and applications. Unity has introduced the new SpectraStar RTW series that offers a top window presentation of samples in either a rotating platter or static mode of analysis. The system also has extreme sample flexibility by using existing sample cups from other brand units, petri dishes, beakers or even plastic bags. The SpectraStar RTW is ideal for the analysis of feeds and forages—Unity can easily transfer existing databases in just a matter of minutes.

USDA—Animal Welfare Information Center
10301 Baltimore Ave Rm 410
Beltsville, MD 20705-2326
<http://www.nal.usda.gov>
Booth(s): 505

The USDA is mandated by the Animal Welfare Act to provide information for the improved care and use of animals used in research, testing, teaching, and exhibition. Staff at the Animal Welfare Information Center provide a variety of topical publications, literature searches, and training opportunities.

Varied Industries Corporation
905 S Carolina Ave
P.O. Box 1483
Mason City, IA 50401-5813
Phone: (641) 423-1460; Fax: (641) 423-0832
<http://www.vi-cor.com>
Booth(s): 501, 503, 600, 602

Varied Industries Corporation (Vi-COR), located in Mason City, Iowa, was purchased in 1999 by Mark Holt, president, who changed the company into a world-class manufacturer of fermentation feed. An innovative company with many new discoveries in applied microbiology and fermentation chemistry put Vi-COR first in the market to develop a concentrated and liquid yeast culture and first to identify and guarantee metabolites associated with the benefits of yeast culture. This specialized process developing Celmanax can be seen in the health of your animals, production improvements, and return on investment and profitability. Vi-COR currently is doing business globally in over 40 countries.

Virtus Nutrition
520 Industrial Ave
Corcoran, CA 93212-9629
Phone: (559) 734-3530
<http://www.virtusnutrition.com>
Booth(s): 417

Leading a new era in strategic nutrition with calcium salts of omega fatty acids.

Western Yeast Company
305 W Ash St
Chillicothe, IL 61523-1603
<http://www.westernyeast.com>
Booth(s): 512

Western Yeast Company was founded in 1932 and uses the Newhaven process for making yeast culture. This process makes live yeast cultures the old-fashioned way with no added carriers after double fermentation. Western Yeast Culture is an active, all-natural feed supplement designed specifically to improve animal nutrition.

Wiley-Blackwell
2121 State Ave
Ames, IA 50014-8365
Phone: (515) 292-0140; Fax: (515) 292-3348
<http://www.wiley.com/go/veterinary>
Booth(s): 201

Wiley-Blackwell has an internationally renowned program of books and journals, positioning us as one of the foremost publishers in veterinary medicine. Our veterinary publishing program represents the very best in academic research, clinical expertise, and student learning. A conference discount is offered to all attendees at our booth.

Zinpro
10400 Vicking Drive
Suite 240
Eden Prairie, MN 55344
<http://www.zinpro.com>
Booth(s): 101, 200

Zinpro Performance Minerals are uniquely designed and manufactured to be the highest bioavailable trace mineral products on the market.

2010 Corporate Sponsorship

ASAS Corporate Sustaining Members

Ajinomoto Heartland LLC
Akey
Archer Daniels Midland Co.
Darling International Inc.
Diamond V Mills Inc.
Elanco Animal Health
Global Pig Farms Inc.
International Ingredient Corporation
Kent Feeds

MIN-AD Inc.
Nutra-Flo Protein and Biotech Products
PCS Sales (USA) Inc.
Pfizer Animal Health
PIC North America
Quali Tech Inc.
Trouw Nutrition USA
Varied Industries Corporation
Zinpro Corporation

ADSA Corporate Sustaining Members

Adisseo North America
Ag Processing Inc.
Akey
Alltech Biotechnology Center
BioZyme Incorporated
Danisco USA Inc
Darling International Research
Diamond V Mills Inc
Elanco Animal Health
GEA Farm Technologies
Grande Cheese Company
Kent Feeds

Kraft Foods
Land O'Lakes Inc
MIN-AD Inc.
Novus International
Performance Products Inc.
Pioneer, A DuPont Company
Prince Agri Products Inc.
Quali Tech
SoyPLUS/SoyChlor
Swedish University of Agricultural Sciences
Varied Industries Corporation
Zook Nutrition & Management Inc.

Poultry Science Sponsors

Patrons

Ajinomoto Heartland LLC
Archer Daniels Midland Co.
Cobb-Vantress Inc.
Mosaic Feed Ingredients
Novus International Inc.
Tyson Foods, Inc.

Sustaining Members

Adisseo USA Inc.
Akey Inc.
Alpharma Animal Health
Aviagen Inc.
Cargill Animal Nutrition
Diamond V Technologies
Foster Farms
Huvepharma Inc.
Hy-Line International
Land O'Lakes/Purina Feeds LLC
Maple Leaf Farms Inc.

The Journal of Applied Poultry Research Sponsors

Gold

Alpharma Animal Health
Cobb-Vantress Inc.
Evonik Degussa Corporation
Novus International Inc.

Silver

AB Vista Feed Ingredients
ChemGen Corp.
Foster Farms
Griffin Industries Inc.
Hybrid Turkeys
Hy-Line International
Perdue Farms Inc.
Zinpro Corporation

Thank you for your support!

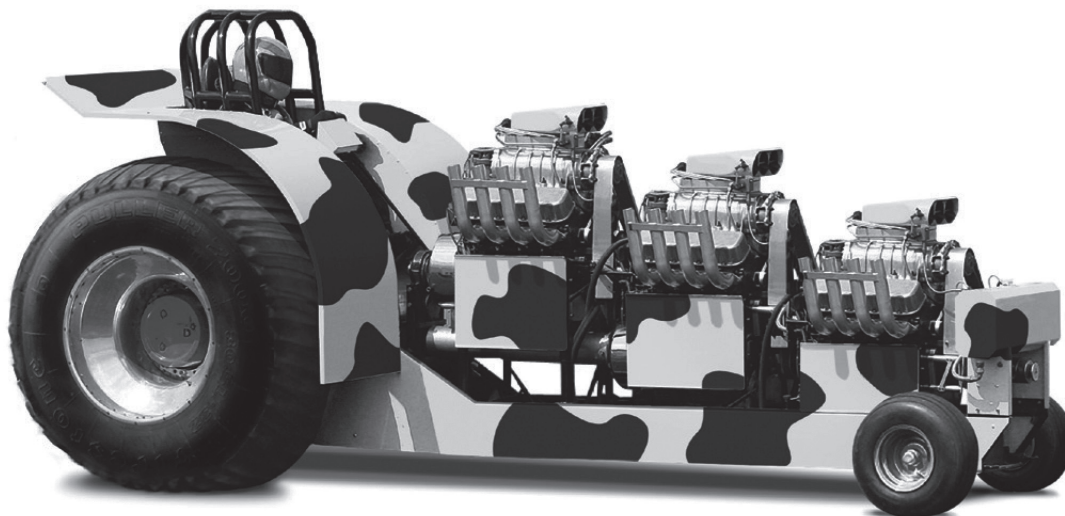

Triple your feeding power

Get the three-in-one power of yeast culture, yeast extract, and hydrolyzed yeast

By combining three yeast components into a single, convenient formulation, Vi-COR® delivers multiple benefits for cows and calves.

Celmanax contains guaranteed levels of metabolites proven in research results and on-farm use. It delivers improved palatability and feed intake. It also eliminates the need to buy, store, and mix several feed ingredients. Contact Vi-COR to learn more about the triple feeding power of Celmanax. Throttle up at www.vi-cor.com/celmanax.



www.vi-cor.com

641.423.1460 • 800.654.5617

Mason City, Iowa



Vi-COR® is a registered trademark of
Varied Industries Corporation, Mason City, IA, USA
©2010 Varied Industries Corporation.
All rights reserved.

Denver Street Map

1. Comfort Inn Downtown
2. Crowne Plaza
3. Denver Marriott City Center
4. Grand Hyatt Denver
5. Hilton Garden Inn
6. Hyatt Regency Denver at CCC
7. Residence Inn by Marriott

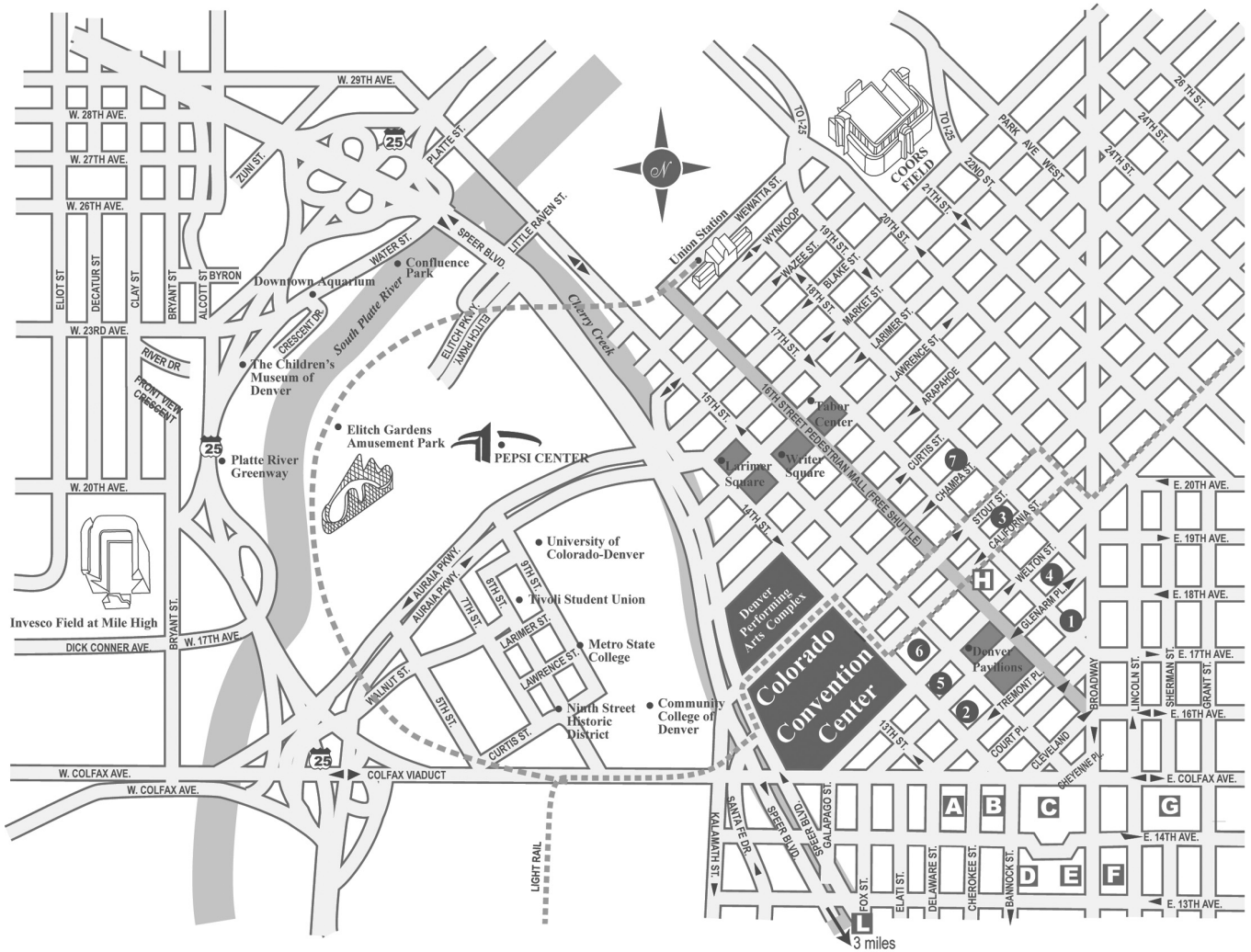

- | | | |
|--|----------------------------------|--|
| A U.S. Mint | D Denver Art Museum | G Colorado State Capitol Building |
| B Denver City & County Building | E Denver Public Library | H VISIT DENVER Information Center |
| C Civic Center Park | F Colorado History Museum | L Cherry Creek Shopping |

Colorado Convention Center

Level 1

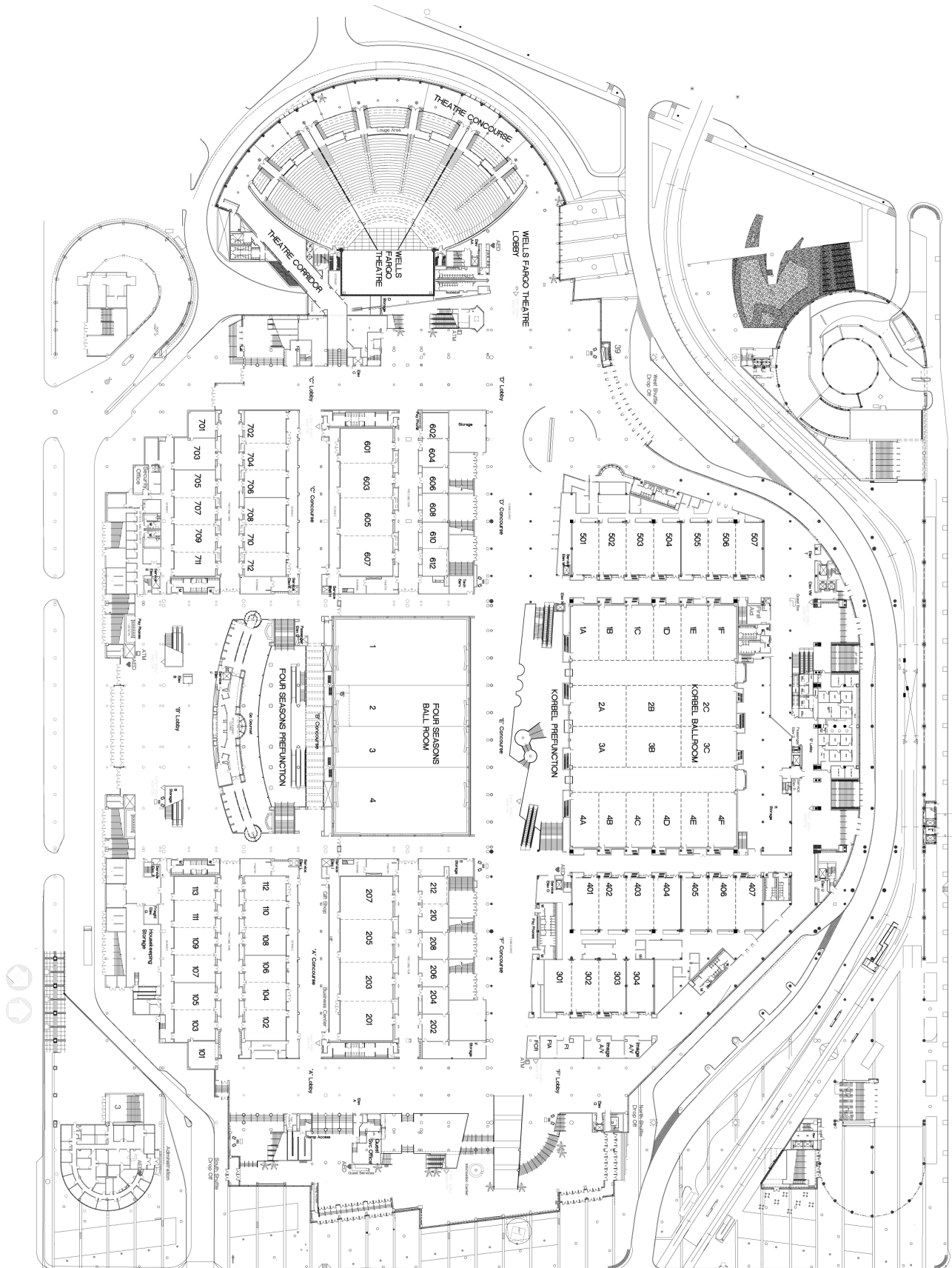
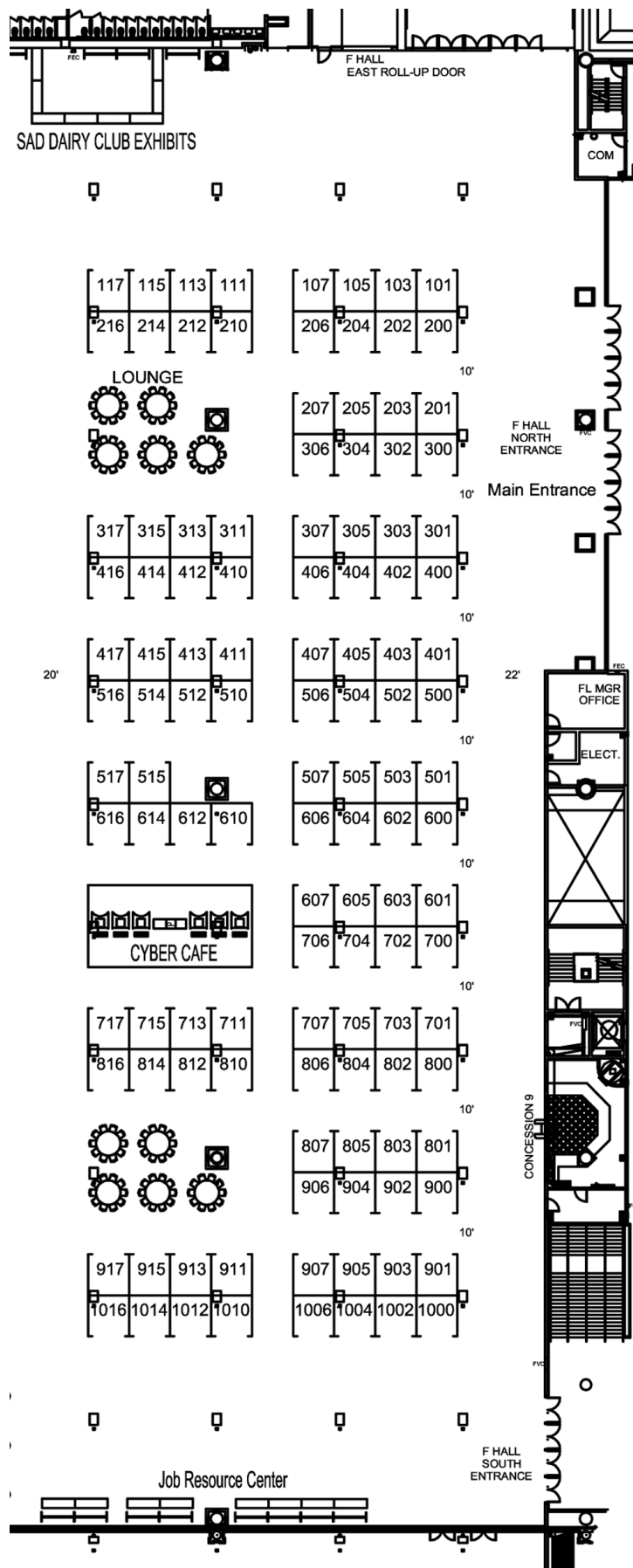

Exhibit Hall Floor Plan



Refer to page 16 for the Guide to Exhibitors

Hyatt Regency at the Colorado Convention Center (ASAS Headquarter Hotel)

Third Level

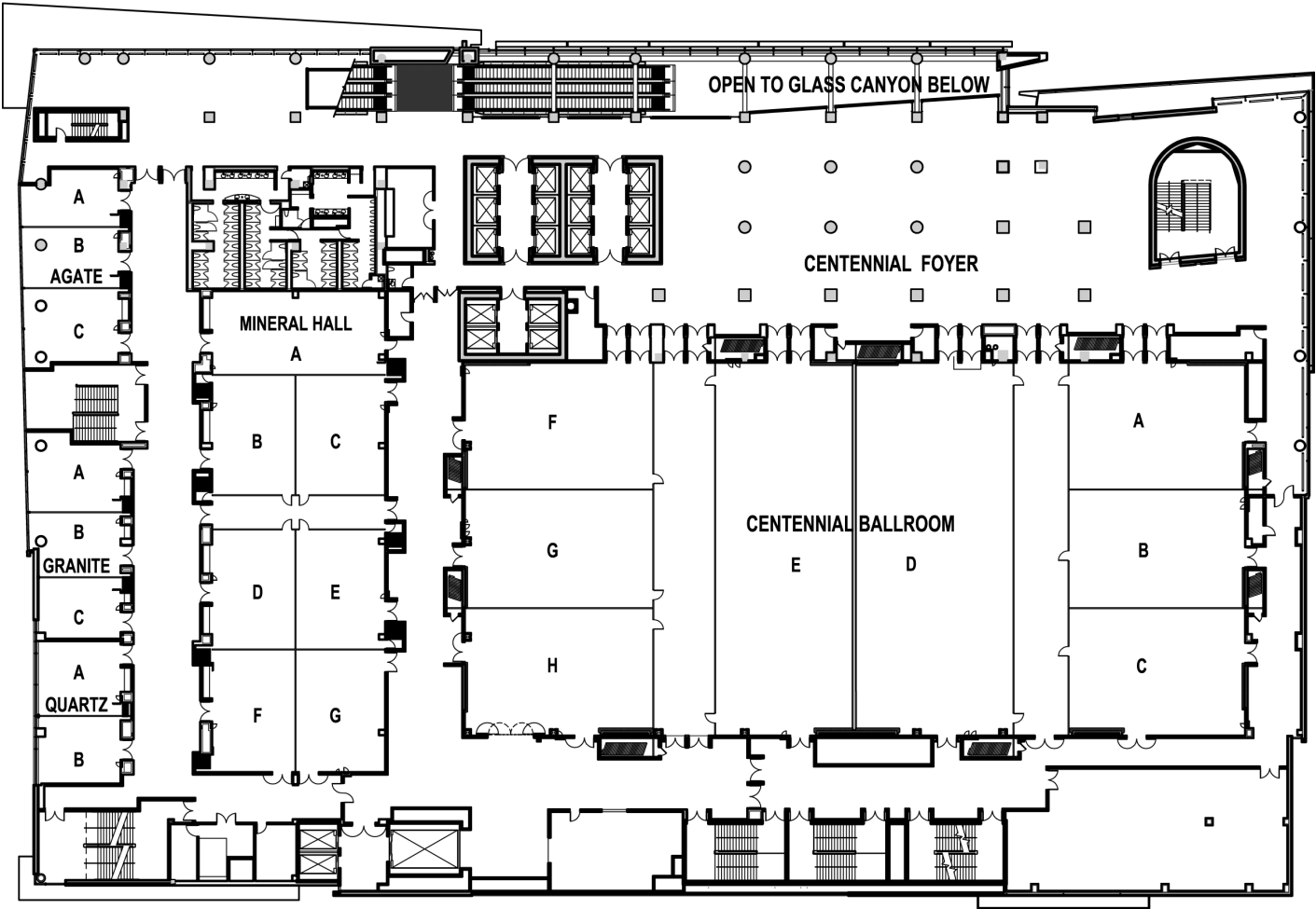

Grand Hyatt Denver (ADSA Headquarter Hotel)

SECOND FLOOR
BALLROOM

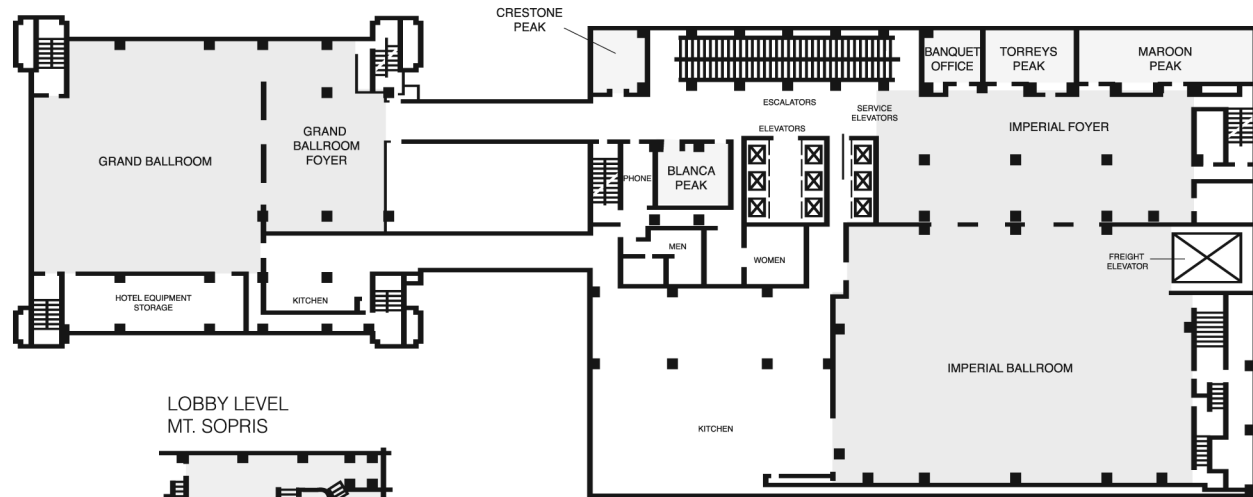

LOBBY LEVEL
MT. SOPRIS

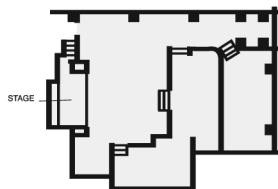

THIRD FLOOR
MEETING ROOMS

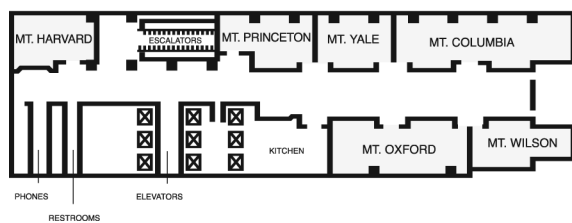

HYATT CONFERENCE CENTER

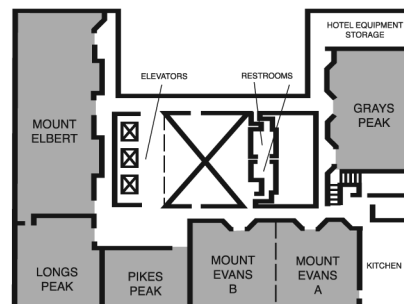

Crowne Plaza Denver (PSA Headquarter Hotel)

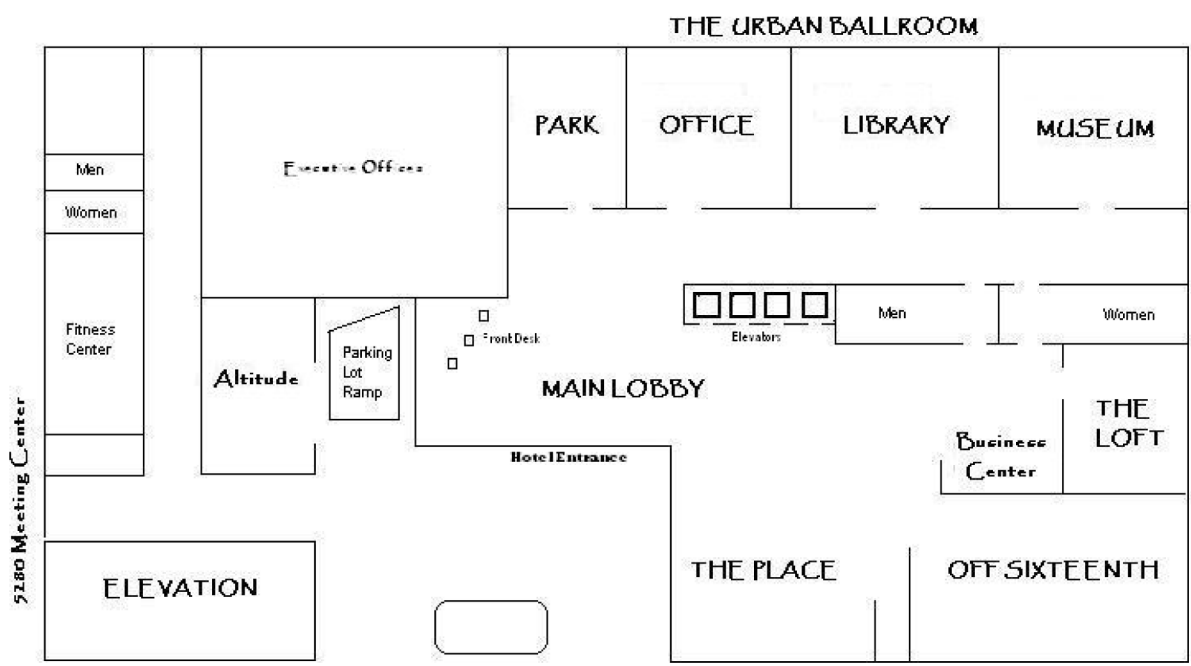

Marriott City Center Denver (CSAS Headquarter Hotel)



Thank you to the 2010 ADSA-PSA-AMPA-CSAS-WSASAS-ASAS Joint Meeting Sponsors!

Platinum Level

EAAP
Elanco Animal Health

Pfizer Animal Health

Gold Level

Alltech
Alpharma Animal Health
ASAS
ASAS Foundation
Danisco Animal Nutrition
Diamond V
Dairy Management Inc.

Kemin Industries Inc.
Monsanto Corp.
Novus International Inc.
Pancosma
USDA-NIFA
West Central
XY Inc.

Silver Level

Archer Daniels Midland
BASF Plant Science
ChemGen

DSM Nutritional Products
FASS
Jones Hamilton Co.

Bronze Level

AAALAC
AB Vista Feed Ingredients
ADSA
Ajinomoto Heartland LLC
Alberta Farm Animal Care
AMPA
Argentine Association of Animal Production
Cargill Animal Nutrition
Cobb-Vantress Inc.

CSAS
Evonik Degussa Corp.
Hill's Science Diet
Journal of Animal Science
Lallemand Animal Nutrition
Lucta
Maple Leaf Farms
P&G
Vetagro

Donor Level

Adisseo USA Inc.
American Sheep Industry Association
Aviagen Turkeys
Aviagen Inc.
Hendrix Genetics (Hybrid Turkeys and ISA)

Poultry Science Association
Southern Poultry Science Society
Tyson Foods Inc.
USDA-ARS Sheep Experiment Station
Zinpro Corp.

Contributor Level

Akey Inc.
Animal Transportation Association
Biomim America Inc.
BioResource International Inc.
Enzyvia LLC

Huvepharma
Johnes's Disease Integrated Program (JDIP)
Kerry Ingredients & Flavors
Pacific Vet Group
Quality Technology International

Schedule of Events

*Scheduling and locations are subject to change without notice.
Please check the onsite newsletter each morning for changes.*

Friday, July 9

Noon – 2:00 pm	PSA Finance Committee Meeting	Crowne Plaza, Park
2:00 pm – 6:00 pm	PSA Board of Directors Meeting	Crowne Plaza, Concierge Lounge

Saturday, July 10

7:30 am – 5:00 pm	ADSA Board of Directors Meeting	Grand Hyatt, Maroon Peak
8:00 am – 4:00 pm	PSA Board of Directors Meeting	Crowne Plaza, Concierge Lounge
12:00 pm – 4:00 pm	Student White Water Rafting Trip	Meet in Comfort Inn lobby
1:00 pm – 2:30 pm	ASAS New Board Orientation	Convention Center, 712
3:00 pm – 5:00 pm	ARPAS Board of Directors Meeting	Grand Hyatt, Mt. Princeton
3:00 pm – 5:00 pm	Registration Open (preregistered, badge and material pick-up only)	Convention Center, 1st Level lobby, outside Exhibit Hall F
3:30 pm – 9:00 pm	ASAS Board of Directors Meeting	Convention Center, 712
5:30 pm – 8:00 pm	Student Informal Mixer: Cowboy Lounge	Meet in the Comfort Inn lobby
7:30 pm – 9:00 pm	ARPAS Executive Committee Meeting	Grand Hyatt, Torrey Peak

Sunday, July 11

7:00 am – 7:00 pm	Registration Open	Convention Center, 1st Level lobby, outside Exhibit Hall F
7:00 am – 8:00 am	ASAS Membership Committee Meeting	Convention Center, 712
7:30 am – 10:00 am	ADSA New Board Orientation	Grand Hyatt, Mt. Harvard
8:00 am – 12:00 pm	PSA Board of Directors Meeting	Crowne Plaza, Concierge Lounge
8:00 am – 5:00 pm	ARPAS Governing Board Meeting	Grand Hyatt, Mt. Columbia
8:00 am – 5:00 pm	Triennial Growth Symposium	Convention Center, 303
8:30 am – 12:30 pm	ASAS Board of Directors Meeting	Convention Center, 712
9:00 am – 5:00 pm	WSASAS Student Competition	Convention Center, 401/402
9:30 am – 12:00 pm	National Extension Workshop	Convention Center, 304
10:00 am – 6:00 pm	Exhibit Setup	Convention Center, Exhibit Hall F
10:00 am – 6:00 pm	Student Dairy Clubs Exhibit Setup	Convention Center, Exhibit Hall F
10:00 am – 11:00 am	ADSA-SAD Officers and Advisor Meeting	Convention Center, 705
11:00 am – 12:00 pm	ADSA-SAD Quiz Bowl Officials Meeting	Convention Center, 705
11:30 am – 12:00 pm	ADSA-SAD Quiz Bowl Seating Test.	Convention Center, 707
11:30 am – 12:30 pm	Open Meeting: Becoming an ADSA Volunteer Leader	Grand Hyatt, Maroon Peak
12:00 pm – 1:00 pm	National Extension Workshop Lunch	Crowne Plaza, Office
12:00 pm – 1:00 pm	ADSA-SAD Midday Mixer and Pizza Party	Convention Center, 704/706
12:00 pm – 1:00 pm	JDS Editors and Journal Management Committee Luncheon	Grand Hyatt, Mt. Oxford
12:00 pm – 5:00 pm	Hospitality Lounge Open	Convention Center, 709
1:00 pm – 3:00 pm	2010 and 2011 Program Committee Meeting	Convention Center, 405
1:00 pm – 5:00 pm	Dalex User Training	Denver Marriott, Ballroom Suites I and II
1:00 pm – 5:00 pm	Informal Nutrition Symposium	Convention Center, Korbel Ballroom 1abc
1:00 pm – 5:00 pm	ADSA Journal Management Committee Meeting	Grand Hyatt, Mt. Oxford
1:00 pm – 5:00 pm	ADSA-SAD Dairy Quiz Bowl Seating/Preliminary Rounds	Convention Center, 705 and 707
1:00 pm – 6:00 pm	CSAS Executive Committee Meeting	Denver Marriott, Matchless
1:00 pm – 6:00 pm	Johne's Disease Integrated Program (JDIP) Workshop	Grand Hyatt, Mt. Sopris
2:00 pm – 3:00 pm	ADSA Production Division Council Meeting.	Convention Center, 501
2:00 pm – 4:00 pm	ADSA Foundation Board of Trustees Meeting.	Grand Hyatt, Mt. Princeton
3:00 pm – 4:00 pm	ADSA Production Division Nominating Committee.	Convention Center, 501

3:00 pm – 5:00 pm	Late-Breaking Original Research Session.	Convention Center, 304
5:00 pm – 6:00 pm	ADSA Dairy Foods Division Council Meeting	Convention Center, 712
5:30 pm – 6:00 pm	ADSA-SAD Dairy Quiz Bowl Final Round	Convention Center, 705
7:00 pm – 8:00 pm	2010 Joint Annual Meeting Opening Session.	Convention Center, Wells Fargo Theater
8:00 pm – 10:00 pm	2010 Joint Annual Meeting Opening Reception	Convention Center, Korbel Ballroom

Monday, July 12

6:30 am – 5:15 pm	Registration Open	Convention Center, 1st Level lobby, outside Exhibit Hall F
6:30 am – 8:00 am	ADSA Production Division Extension Breakfast.	Grand Hyatt, Longs Peak
7:00 am – 8:15 am	ADSA-SAD Exhibit Setup.	Convention Center, Exhibit Hall F
7:30 am – 9:30 am	Poster Presentations	Convention Center, Exhibit Hall F
7:30 am – 11:00 am	WSASAS Executive Meeting.	Convention Center, 711
8:00 am – 5:00 pm	Commercial Exhibits and ADSA-SAD Exhibits Open.	Convention Center, Exhibit Hall F
8:00 am – 5:00 pm	Job Resource Center	Convention Center, Exhibit Hall F
8:00 am – 5:00 pm	Hospitality Lounge Open	Convention Center, 709
8:30 am – 9:15 am	ADSA-SAD Business Meeting	Convention Center, 705, 707
9:30 am – 10:30 am	ADSA-SAD Judging of Yearbooks, Scrapbooks, Annual Reports	Convention Center, 704
9:30 am – 10:30 am	ADSA-SAD Interviews for Outstanding Student and Advisor Awards	Convention Center, 706
9:30 am – 10:45 am	ADSA-SAD Activities Symposium	Convention Center, 705
9:30 am – 5:00 pm	Scientific Sessions	Convention Center
10:30 am – 12:30 pm	ARPAS Exam	Convention Center, 701
11:00 am – 5:00 pm	ADSA-SAD Undergraduate Paper Presentations	Convention Center, 705, 707
12:30 pm – 1:30 pm	ASAS Graduate Student Open Forum.	Convention Center, Korbel Ballroom 2c
12:30 pm – 2:00 pm	ASAS Past Presidents' Luncheon	Hyatt Regency, Mineral Hall B–C
12:30 pm – 2:00 pm	ADSA Past Presidents' Luncheon	Grand Hyatt, Longs Peak
12:30 pm – 2:00 pm	American College of Animal Sciences (ACAS) Annual Meeting	Convention Center, 701
12:30 pm – 2:00 pm	PS and JAPR Editorial Lunch and Meeting	Crowne Plaza, Library
12:30 pm – 2:00 pm	National Poultry Extension Lunch	Crowne Plaza, Office
12:30 pm – 2:00 pm	PSA Past Presidents' Luncheon	Crowne Plaza, Park
2:00 pm – 3:00 pm	Discover Conference Steering Committee Meeting.	Convention Center, 711
2:00 pm – 4:00 pm	ARPAS Exam	Convention Center, 701
2:00 pm – 5:30 pm	Southern Branch ADSA Symposium and Business Meeting.	Convention Center, Korbel Ballroom 3a
4:00 pm – 6:00 pm	Exhibitor Reception	Convention Center, Exhibit Hall F
5:00 pm – 6:00 pm	Presentation by Dr. Roger Beachy, NIFA.	Convention Center, 403/404
5:00 pm – 6:00 pm	USDA-ARS Staff Update Session	Convention Center, 507
5:00 pm – 7:00 pm	Companion Animal Reception	Convention Center, 702
5:30 pm – 7:00 pm	ASAS Award Winners Dinner and Photo Session.	Convention Center, Korbel Ballroom 2c
5:30 pm – 7:30 pm	Informal Calf Gathering	Grand Hyatt, Mt. Sopris
6:00 pm – 8:00 pm	Student Informal Mixer: Lucky Strikes Lanes and Lounge	Meet in the Comfort Inn lobby
7:00 pm	Texas A&M (TAMU) Aggie "Breakfast"	Crowne Plaza, Library
7:00 pm – 8:30 pm	ASAS Awards Program	Convention Center, Korbel Ballroom 4abc
8:00 pm – 11:00 pm	Iowa State Reception	Hyatt Regency, Mineral Hall A
9:00 pm	Graduate Student Mixer	Blake Street Vault, LoDo Denver

Tuesday, July 13

6:30 am – 5:15 pm	Registration Open	Convention Center, 1st Level lobby, outside Exhibit Hall F
6:30 am – 8:00 am	Penn State Breakfast	Hyatt Regency, Mineral Hall D
6:30 am – 8:00 am	University of Illinois Breakfast.	Hyatt Regency, Mineral Hall A–C
6:30 am – 8:00 am	Kentucky Breakfast	Crowne Plaza, Library
6:30 am – 8:00 am	Virginia Tech Breakfast	Grand Hyatt, Mt. Oxford
6:30 am – 8:00 am	JDS Editorial Board Breakfast/Meeting	Grand Hyatt, Maroon Peak
6:30 am – 8:00 am	PSA Foundation Breakfast	Crowne Plaza, Altitude
6:30 am – 8:00 am	National Poultry Waste Management Breakfast	Crowne Plaza, Office
7:30 am – 8:30 am	Biomim America Inc. Breakfast Meeting.	Hyatt Regency, Mineral Hall E
7:30 am – 9:30 am	Poster Presentations	Convention Center, Exhibit Hall F
8:00 am – 9:00 am	ASAS Investment Committee Meeting	Hyatt Regency, Mineral Hall F–G
8:00 am – 11:30 am	Hospitality Lounge Open	Convention Center, 709
8:00 am – 5:00 pm	Commercial Exhibits and ADSA-SAD Exhibits Open.	Convention Center, Exhibit Hall F
8:00 am – 5:00 pm	Job Resource Center	Convention Center, Exhibit Hall F
8:30 am – 9:30 am	ADSA-SAD Business Meeting–Election of Officers.	Convention Center, 705
9:00 am – 1:00 pm	Spouse Event 1	Meet at Hyatt Regency
9:30 am – 11:00 am	ADSA-SAD Student Career Roundtable	Convention Center, 705
9:30 am – 11:30 am	ASAS Foundation Board of Trustees Meeting	Hyatt Regency, Mineral Hall A
9:30 am – 5:00 pm	Scientific Sessions	Convention Center
11:00 am – 12:00 pm	WPSA-USA Board Meeting.	Crowne Plaza, Park
11:30 am – 12:30 pm	ADSA Production Division Business Meeting	Convention Center, 505/506
11:30 am – 12:30 pm	ADSA Dairy Foods Division Business Meeting	Convention Center, 501/502
11:45 am – 2:00 pm	ADSA-SAD Awards Luncheon.	Convention Center, 704/706
12:30 pm – 1:30 pm	Michigan State University Luncheon	Convention Center, 709
12:30 pm – 2:00 pm	CSAS Annual General Meeting	Denver Marriott, Mattie Silks
12:30 pm – 2:00 pm	WPSA-USA Member Luncheon.	Crowne Plaza, Office
12:30 pm – 2:00 pm	ASAS Editors' Luncheon	Hyatt Regency, Mineral Hall A
12:30 pm – 2:00 pm	WSASAS Awards Luncheon	Convention Center, 708/710/712
12:30 pm – 2:00 pm	ASAS Foundation Emeritus/Retiree Lunch.	Convention Center, 702
12:30 pm – 2:00 pm	ADSA DF Division Milk Proteins and Enzyme Committee	Convention Center, 705
12:30 pm – 2:00 pm	ARPAS Business Meeting.	Convention Center, 301/302
12:30 pm – 2:00 pm	American Poultry Historical Society Luncheon	Crowne Plaza, Altitude
12:30 pm – 2:00 pm	ADSA DF Division Program Planning Lunch.	Convention Center, 701
12:30 pm – 2:00 pm	ASAS GS Lunch and Learn	Convention Center, 703
12:30 pm – 2:00 pm	PSA Student Luncheon.	Crowne Plaza, Library & Museum
12:30 pm – 2:00 pm	NE ASAS/ADSA Business Meeting & Awards Luncheon.	Convention Center, 711
2:00 pm – 3:00 pm	ADSA-SAD Award and Club Photos	Convention Center, 704
2:00 pm – 4:00 pm	ARPAS Exam	Convention Center, 701
2:30 pm – 3:30 pm	ADSA-SAD Committee Meeting–Old and New Officers and Advisors.	Convention Center, 705
3:00 pm – 5:00 pm	Hospitality Lounge Open	Convention Center, 709
3:30 pm – 4:30 pm	ASAS JAS Forum (Division/Associate Editors and Authors)	Convention Center, 707
4:30 pm – 5:00 pm	The ASAS Open Forum	Convention Center, 405
5:00 pm – 6:00 pm	FASS Update	Convention Center, 507
5:00 pm – 9:00 pm	CJAS Editorial Board Meeting	Denver Marriott, Matchless
5:00 pm – 6:30 pm	ADSA Award Donor Dinner	Grand Hyatt, Mt. Sopris
5:00 pm	Evonik Degussa Reception (invited guests)	Hyatt Regency, Capital Ballroom
7:00 pm – 8:00 pm	ADSA Awards Program	Grand Hyatt, Grand Ballroom
8:15 pm – 9:30 pm	ADSA-PSA-AMPA-CSAS-WSASAS-ASAS Ice Cream Social	Grand Hyatt, Imperial Ballroom
9:15 pm	PSA/WPSA-USA-Canada Student Mixer: Blake St. Vault	Meet in Crowne Plaza lobby

Wednesday, July 14

6:30 am – 5:15 pm	Registration Open	Convention Center, 1st Level lobby, outside Exhibit Hall F
6:30 am – 7:30 am	ASAS-PSA Joint Executive Committee Meeting	Convention Center, 711
6:30 am – 8:00 am	Purdue University Breakfast	Hyatt Regency, Mineral Hall A
7:30 am – 9:00 am	WSASAS Annual Business Meeting	Convention Center, 304
7:30 am – 9:30 am	S-PAC Conference Coordinators Meeting	Convention Center, 303
7:30 am – 9:30 am	Poster Presentations	Convention Center, Exhibit Hall F
8:00 am – 2:00 pm	Commercial Exhibits Open	Convention Center, Exhibit Hall F
8:00 am – 5:00 pm	Job Resource Center	Convention Center, Exhibit Hall F
8:00 am – 5:00 pm	Hospitality Lounge Open	Convention Center, 709
9:30 am – 10:30 am	WPSA Lecture.	Convention Center, Korbels Ballroom 1cd
9:30 am – 10:30 am	ASAS Business Meeting	Convention Center, 401/402
9:30 am – 10:30 am	ADSA Annual Business Meeting and Open Forum.	Convention Center, 403/404
10:00 am – 1:00 pm	Spouse Event 2	Meet at Convention Center
10:30 am – 12:30 pm	PSA Business Meeting	Convention Center, Korbels Ballroom 1cd
10:30 am – 5:00 pm	Scientific Sessions	Convention Center
11:30 am – 12:30 pm	ADSA-ASAS Joint Executive Committee Meeting	Convention Center, 711
12:30 pm – 2:00 pm	WSASAS Executive Post Conference Meeting.	Convention Center, 709
12:30 pm – 2:30 pm	Feed Analysis Consortium Annual Meeting	Convention Center 705
12:30 pm – 2:30 pm	ADSA Board of Directors Meeting	Grand Hyatt, Maroon Peak
12:30 pm – 2:00 pm	PSA New Board Luncheon.	Crowne Plaza, Park
2:00 pm – 4:00 pm	ARPAS Exam.	Convention Center, 701
2:00 pm – 5:00 pm	Commercial Exhibits Dismantle	Convention Center, Exhibit Hall F
2:30 pm – 4:30 pm	ASAS Board of Directors Meeting	Hyatt Regency, Mineral Hall B–C
3:00 pm – 5:00 pm	Hospitality Lounge Open	Convention Center, 709
3:00 pm – 8:00 pm	National Swine Nutrition Guide Training Conference.	Hyatt Regency, Mineral Hall F–G
4:00 pm – 5:00 pm	AMPA Business Meeting	Convention Center, 705
4:30 pm – 5:30 pm	2010 Global Networking Reception.	Convention Center, Korbels Ballroom 4abc
4:30 pm – 6:00 pm	Johne's Disease Interest Group.	Convention Center, 711
6:00 pm – 8:30 pm	CSAS Awards Banquet	Denver Marriott, Ballroom Suites I–III
6:00 pm – 10:00 pm	PSA Awards Banquet	Convention Center, Four Seasons 1&2
6:30 pm – 10:30 pm	AMPA Dinner	Convention Center, 708/710/712

Thursday, July 15

7:30 am – 8:30 am	ADSA-ASAS-PSA Joint Executive Committee Meeting	Convention Center, 303
8:00 am – 1:00 pm	Registration Open	Convention Center, 1st Level lobby, outside Exhibit Hall F
8:30 am – 11:30 am	Scientific Sessions	Convention Center
1:00 pm – 5:00 pm	NIFA NRI/AFRI Animal Growth & Nutrient Utilization PD Meeting	Hyatt Regency, Mineral Hall A
7:00 pm – 9:00 pm	NIFA NRI/AFRI Animal Growth & Nutrient Utilization PD Reception	Hyatt Regency, Mineral Hall B–C

Friday, July 16

7:30 am – 1:00 pm	NIFA NRI/AFRI Animal Growth & Nutrient Utilization PD Meeting	Hyatt Regency, Mineral Hall A
-------------------	---	-------------------------------

ADSA Student Affiliate Division Program

SAD Special Events

Saturday, July 10

Student White Water Rafting Trip on Clear Creek

12:00 – 4:00 pm

Bus departs from the Comfort Inn

Tickets: \$44

Prepare for the adventure of a lifetime! We'll do a beginner trip with Class I to III rapids, perfect for first-time paddlers but plenty of action for those seeking it. Participants must complete the necessary liability waivers and should bring rubber-soled foot gear (tennis shoes, river sandals, etc.); swimsuit or shirt and shorts that will dry quickly (nylon, fleece, other synthetics, or wool); sunscreen and lip balm; sunglasses with strap; bandanna or hat; bottled water; and personal necessities. Price includes round-trip transportation, rafting trip, equipment rental, and guide gratuity.

Student Informal Mixer: Cowboy Lounge

5:30 pm – 8:00 pm

Tickets: \$18

Meet in the lobby of the Comfort Inn at 5:30 and we'll walk as a group down 16th Street Mall to Cowboy Lounge at 1941 Market St. (near Coors Field). Cowboy Lounge is the only country and western bar in downtown Denver offering country and rock music. The atmosphere captures the true Wild West with its western cowboy flair, spacious dance floor, dance lessons, and movie screens. Ticket price includes Backyard Barbecue dinner.

Sunday, July 11

SAD Midday Mixer and Pizza Party

12:00 – 1:00 pm

Convention Center, 704/706

Tickets: \$5

Join your fellow dairy club members for a fun hour of getting reacquainted and making new friends. Lunch includes pizza, salad, and beverages. Registration is limited to undergraduate and graduate students and advisors.

SAD-Dairy Quiz Bowl Final Round

5:30 – 6:00 pm

Convention Center, 705

On Sunday, university teams from across the US will compete in the ADSA Dairy Quiz Bowl. The event gives schools an opportunity to demonstrate their knowledge about dairy production, processing, and ADSA history. The Student Affiliate Division (SAD) invites you to join them for the excitement of the final round of competition as the top two schools go head-to-head for the title of 2010 Dairy Quiz Bowl Winning Team.

Monday, July 12

Student Informal Mixer: Lucky Strike Lanes and Lounge

6:00 – 8:00 pm

No ticket required, meet in the lobby of the Comfort Inn to walk as a group.

Bowling, billiards, fun food, and drinks await at Lucky Strikes Lanes and Lounge on the 16th Street Mall. Enjoy the retro feel and experience the cool vibe. Premium, upscale bowling alleys with lane-side food service including a menu of appetizers, burgers, sandwiches, pizza, finger foods, salads, and desserts.

Tuesday, July 13

SAD Career Roundtable

9:30 – 11:00 am

Convention Center, 705

Students will have the opportunity to visit with industry professionals representing various facets of the animal agriculture industry. They will learn about careers in the industry, get useful tips on planning for their careers, and much more. Students are encouraged to dress professionally (business casual or better) and bring several copies of their resumes. Students should also plan time to visit industry reps in the exhibit hall for information about internships and job opportunities.

SAD Awards Luncheon

11:45 am – 2:00 pm

Convention Center, 704/706

Plan to attend this year's SAD awards luncheon. The afternoon will be capped with presentation of student awards and announcement of new SAD officers. Both students and professionals are encouraged to attend. This is a wonderful chance to get to know the next generation of the dairy industry.

SAD Schedule of Events

Scheduling and locations are subject to change without notice.

Please check the onsite newsletter each morning for changes.

Saturday, July 10

12:00 pm – 4:00 pm	Student White Water Rafting Trip	Meet in Comfort Inn lobby
3:00 pm – 5:00 pm	Registration Open (preregistered, badge and material pick-up only)	Convention Center, 1st Level lobby, outside Exhibit Hall F
5:30 pm – 8:00 pm	Student Informal Mixer: Cowboy Lounge	Meet in the Comfort Inn lobby

Sunday, July 11

7:00 am – 8:00 pm	Registration Open	Convention Center, 1st Level lobby, outside Exhibit Hall F
10:00 am – 6:00 pm	Student Dairy Clubs Exhibits Setup	Convention Center, Exhibit Hall F
10:00 am – 11:00 am	ADSA-SAD Officers and Advisor Meeting	Convention Center, 705
11:00 am – 12:00 pm	ADSA-SAD Quiz Bowl Officials Meeting	Convention Center, 705
11:30 am – 12:00 pm	ADSA-SAD Quiz Bowl Seating Test	Convention Center, 707
12:00 pm – 1:00 pm	ADSA-SAD Midday Mixer and Pizza Party	Convention Center, 704/706
1:00 pm – 5:00 pm	ADSA-SAD Dairy Quiz Bowl Seating/Preliminary Rounds	Convention Center, 705 and 707
5:30 pm – 6:00 pm	ADSA-SAD Dairy Quiz Bowl Final Round	Convention Center, 705
7:00 pm – 8:00 pm	2010 Joint Annual Meeting Opening Session	Convention Center, Wells Fargo Theater
8:00 pm – 10:00 pm	2010 Joint Annual Meeting Opening Reception	Convention Center, Korbel Ballroom

Monday, July 12

6:30 am – 5:15 pm	Registration Open	Convention Center, 1st Level lobby, outside Exhibit Hall F
7:00 am – 8:15 am	ADSA-SAD Exhibit Set-Up	Convention Center, Exhibit Hall F
7:30 am – 9:30 am	Poster Presentations	Convention Center, Exhibit Hall F
8:00 am – 5:00 pm	Commercial Exhibits and ADSA-SAD Exhibits Open	Convention Center, Exhibit Hall F
8:30 am – 9:15 am	ADSA-SAD Business Meeting	Convention Center, 705
9:30 am – 10:30 am	ADSA-SAD Judging of Yearbooks, Scrapbooks, Annual Reports	Convention Center, 704
9:30 am – 10:30 am	ADSA-SAD Interviews for Outstanding Student and Advisor Awards	Convention Center, 706

9:30 am – 10:45 am	ADSA-SAD Activities Symposium	Convention Center, 705
9:30 am – 5:00 pm	Scientific Sessions	Convention Center
11:00 am – 5:00 pm	ADSA-SAD Undergraduate Paper Presentations	Convention Center, 705, 707
4:00 pm – 6:00 pm	Exhibitor Reception	Convention Center, Exhibit Hall F
5:00 pm – 6:00 pm	Presentation by Dr. Roger Beachy, NIFA	Convention Center, 403/404
6:00 pm – 8:00 pm	Student Informal Mixer: Lucky Strikes Lanes and Lounge	Meet in the Comfort Inn lobby

Tuesday, July 13

6:30 am – 5:15 pm	Registration Open	Convention Center, 1st Level lobby, outside Exhibit Hall F
7:30 am – 9:30 am	Poster Presentations	Convention Center, Exhibit Hall F
8:00 am – 5:00 pm	Commercial Exhibits and ADSA-SAD Exhibits Open	Convention Center, Exhibit Hall F
8:30 am – 9:30 am	ADSA-SAD Student Business Meeting–Election of Officers	Convention Center, 705
9:30 am – 5:00 pm	Scientific Sessions	Convention Center
9:30 am – 11:00 am	ADSA-SAD Student Career Roundtable	Convention Center, 705
11:45 am – 2:00 pm	ADSA-SAD Awards Luncheon	Convention Center, 704/706
2:00 pm – 3:00 pm	ADSA-SAD Award and Club Photos	Convention Center, 704
2:30 pm – 3:30 pm	ADSA-SAD Committee Meeting–Old and New Officers and Advisors	Convention Center, 705
7:00 pm – 8:00 pm	ADSA Awards Program	Grand Hyatt, Grand Ballroom
8:15 pm – 9:30 pm	ADSA-PSA-AMPA-CSAS-WSASAS-ASAS Ice Cream Social	Grand Hyatt, Imperial Ballroom

Wednesday, July 14

6:30 am – 5:15 pm	Registration Open	Convention Center, 1st Level lobby, outside Exhibit Hall F
7:30 am – 9:30 am	Poster Presentations	Convention Center, Exhibit Hall F
8:00 am – 2:00 pm	Commercial Exhibits Open	Convention Center, Exhibit Hall F
9:30 am – 10:30 am	ADSA Annual Business Meeting and Open Forum	Convention Center, 403/404
10:30 am – 5:00 pm	Scientific Sessions	Convention Center
2:00 pm – 5:00 pm	Commercial Exhibits Dismantle	Convention Center, Exhibit Hall F
4:30 pm – 5:30 pm	2010 Global Networking Reception	Convention Center, Korbel Ballroom
4abc		

Thursday, July 15

8:00 am – 1:00 pm	Registration Open	Convention Center, 1st Level lobby, outside Exhibit Hall F
8:30 am – 11:30 am	Scientific Sessions	Convention Center

ADSA Dairy Foods Division Schedule of Events

Sunday, July 11

5:00 pm – 6:00 pm ADSA Dairy Foods Division Council Meeting, Convention Center, 712

Monday, July 12

7:30 am – 9:30 am Posters: National ADSA Dairy Foods Graduate Student Poster Competition, Convention Center, Exhibit Hall F
 7:30 am – 9:30 am Posters: Food Safety I, Convention Center, Exhibit Hall F
 9:30 am – 12:30 pm National ADSA Dairy Foods Oral: Dairy Foods Oral Student Competition, Convention Center, 501/502
 9:30 am – 12:30 pm Food Safety: Probiotics, Convention Center, 401/402
 11:00 am – 12:15 pm ADSA-SAD Undergraduate Paper Competition: Dairy Foods, Convention Center, 705
 2:00 pm – 5:00 pm SYMPOSIUM: Dairy Foods: Microbiology and Flavor of Cheese: Convention Center, Korbel Ballroom 2a
 2:00 pm – 5:00 pm Dairy Foods: Processing, Convention Center, 501/502

Tuesday, July 13

7:30 am – 9:30 am Posters: Dairy Foods: Cheese, Convention Center, Exhibit Hall F
 7:30 am – 9:30 am Posters: Dairy Foods: Chemistry, Convention Center, Exhibit Hall F
 7:30 am – 9:30 am Posters: Dairy Foods: Foods and Products, Convention Center, Exhibit Hall F
 9:30 am – 10:30 am Danisco International Dairy Sciences Award Lecture, Convention Center, 501/502
 9:30 am – 12:30 pm Food Safety: Poultry Aspects, Convention Center, Korbel Ballroom 4abc
 10:30 am – 11:30 am ADSA Foundation Scholar Lecture: Dairy Foods, Convention Center, 501/502
 11:30 am – 12:30 pm ADSA Dairy Foods Division Business Meeting, Convention Center, 501/502
 12:30 pm – 2:00 pm ADSA Dairy Foods Division Program Planning Lunch, Convention Center, 701
 12:30 pm – 2:00 pm ADSA DF Division Milk Proteins and Enzyme Committee, Convention Center, 705
 2:00 pm – 3:00 pm ADSA Foundation Scholar Lecture: Production, Convention Center, 301/303
 2:00 pm – 5:00 pm SYMPOSIUM: Dairy Foods: Towards a Mechanistic Understanding of Probiotic Function in Man and Animals, Convention Center, 501/502
 3:30 pm – 5:30 pm ADSA Production Division Symposium: Dairy Products and Human Health: The Facts, Convention Center, 301/303

Wednesday, July 14

7:30 am – 9:30 am Posters: Dairy Foods: Microbiology, Convention Center, Exhibit Hall F
 7:30 am – 9:30 am Posters: Dairy Foods: Processing, Convention Center, Exhibit Hall F
 7:30 am – 9:30 am Posters: Dairy Foods: Protein, Convention Center, Exhibit Hall F
 7:30 am – 9:30 am Posters: Food Safety 2, Convention Center, Exhibit Hall F
 10:30 am – 12:30 pm Dairy Foods: Cheese, Convention Center, 501/502
 10:30 am – 12:30 pm Dairy Foods: Chemistry-Protein, Convention Center, 503/504
 2:00 pm – 3:30 pm Dairy Foods: Foods and Products, Convention Center, 503/504
 2:00 pm – 5:00 pm Dairy Foods: Microbiology, Convention Center, 501/502

Thursday, July 15

8:30 am – 11:30 am Food Safety: General Aspects, Convention Center 505/506

Scientific Program Table of Contents

Sunday, July 11

SYMPOSIA AND ORAL SESSIONS

SYMPOSIUM: Triennial Growth Symposium: Dietary Regulation of Growth and Development	53
ASAS Western Section Graduate Paper Competition.	53
SYMPOSIUM: National Extension Workshop: The Impact of Major Food Policy Shifts on the US Food Supply and its Producers: Animal Welfare Issues	55
SYMPOSIUM: Informal Nutrition Symposium: Connecting Nutrition, Biochemistry, Genetics, Physiology, and Microbiology to Enhance Our Knowledge in Improving Animal Agriculture	56
Johne's Disease Integrated Program (JDIP) Meeting	56
Late Breaking/Original Research	56

Monday, July 12

POSTER PRESENTATIONS

Animal Behavior and Well-Being: Livestock.	57
Animal Health: Inflammation, Infection, and Stress	58
Animal Health-Johne's Disease (JDIP): Johne's Disease	60
Breeding and Genetics: Beef Cattle	61
Food Safety 1	63
Forages and Pastures: Dairy Forages and Forage Quality	63
Forages and Pastures: Grazing and Forage Management	65
Immunology and Pathology: Poultry Immunology and Pathology	66
Lactation Biology 1	66
Meat Science and Muscle Biology: Beef Quality	67
Graduate Student Poster Competition: National ADSA Dairy Foods Poster.	69
Graduate Student Poster Competition: National ADSA Production MS Poster.	70
Graduate Student Poster Competition: National ADSA Production PhD Poster	70
Nonruminant Nutrition: Amino Acids	71
Nonruminant Nutrition: Feed Ingredients	73
Physiology and Endocrinology: Nutritional Effects on Reproduction and Development	75
Physiology and Endocrinology: Pregnancy.	76
Physiology and Endocrinology: Reproductive Endocrinology	76
Physiology and Endocrinology: Reproductive Management.	77
Production, Management and the Environment: Microbiology	77
Production, Management and the Environment: Poultry	77
Production, Management and the Environment: Small Ruminant	79
Production, Management and the Environment: Swine	79

Ruminant Nutrition: Beef: Additives and Supplements	80
Ruminant Nutrition: Dairy: Forages, Fiber, Grazing	82
Ruminant Nutrition: Methods, Models, etc.	86
Small Ruminant: Sheep Production 1	87

SYMPOSIA AND ORAL SESSIONS

Graduate Student Paper Competition: ADSA Southern Section	89
Graduate Student Paper Competition: ADSA-ASAS Northeast Section	89
SYMPOSIUM: Alpharma Beef Cattle Nutrition Symposium: "Parameterizing" Health and Performance	
Expectations of Feedlot Cattle	90
SYMPOSIUM: Animal Behavior and Well-Being: Animal Welfare Assurance: Science and Application	90
Animal Health-Johne's Disease (JDIP): Basic Biology/Immunology/Vaccine Development	90
Breeding and Genetics: Feed Intake and Utilization	91
SYMPOSIUM: ASAS-EAAP Global Issues Symposium: Contemporary and Emerging Issues and International Animal	
Agriculture Joint Symposium: Global Livestock Production to 2050: Challenges and Opportunities	92
Extension Education 1	92
SYMPOSIUM: Food Safety: Potential Impact of Reduced Antibiotic Use and the Roles of Prebiotics, Probiotics,	
and Other Alternatives in Antibiotic-Free Broiler Production	93
Forages and Pastures: Grazing and Forage Management	93
SYMPOSIUM: Graduate Student Symposium: Transitions: Preparing for Your Future	94
Growth and Development: Regulatory Mechanisms in Growth and Development.	95
Horse Species 1	95
National ADSA Dairy Foods Oral: Dairy Foods Oral Student Competition.	96
Nonruminant Nutrition: Amino Acids 1	97
Nonruminant Nutrition: Dietary Fat	98
SYMPOSIUM: Nonruminant Nutrition: Nutrigenomics	99
Physiology and Endocrinology: Dairy Cow Synchronization and Fertility.	99
Production, Management and the Environment: Poultry 1	100
Production, Management and the Environment: Poultry 2	101
Ruminant Nutrition: Beef: By-Product Feeds	102
Ruminant Nutrition: Dairy: Protein and Fat	103
ADSA-SAD Undergraduate Competition: Dairy Foods	104
Teaching/Undergraduate and Graduate Education: Graduate and Undergraduate Teaching 1	104
SYMPOSIUM: ADSA Southern Section Dairy Cattle Grazing in the Southern USA.	104
ADSA-SAD Undergraduate Competition: Dairy Production	105
ADSA-SAD Undergraduate Competition: Undergraduate Original Research.	105
Animal Behavior and Well-Being: Poultry1: Ducks, Layers, and Turkeys.	106
Animal Health: Immunity, Probiotics and Health Status	107
Animal Health-Johne's Disease (JDIP): Epidemiology and Transmission.	108

SYMPOSIUM: Breeding and Genetics: Bridging the Gap Between Physiology and Genomics	109
SYMPOSIUM: Companion Animals: Microbes and Health	109
SYMPOSIUM: Dairy Foods: Microbiology and Flavor of Cheese: Impact of Lower Salt-In-Moisture Content of Low Fat and Reduced Sodium Cheeses	109
Dairy Foods: Processing	110
SYMPOSIUM: Growth and Development: Intestinal Development and Growth	110
SYMPOSIUM: Lactation Biology: Novel Mechanisms Regulating Milk Secretion and Mammary Involution	111
Meat Science and Muscle Biology: Fresh Meat Quality and Muscle Biology	111
Nonruminant Nutrition: Enzymes 1.	112
Nonruminant Nutrition: Health 1	113
SYMPOSIUM: Nonruminant Nutrition: Rethinking Equine Nutrition	114
Physiology and Endocrinology: Poultry Physiology	114
Processing and Products: Processing and Products.	115
Ruminant Nutrition: Beef: Additives	116
Ruminant Nutrition: Dairy: Calves.	117
Small Ruminant: Sheep and Goat Production 1	118

OTHER EVENTS

Presentation by Dr. Roger Beachy, NIFA	118
--	-----

Tuesday, July 13

POSTER PRESENTATIONS

Animal Behavior and Well-Being: Swine and Poultry	119
Animal Health: Viruses, Infections, and Immunity	120
Beef Species	120
Breeding and Genetics: Poultry and Small Ruminants	121
Companion Animals: Companion Animal Biology	122
Dairy Foods: Cheese	123
Dairy Foods: Chemistry	124
Dairy Foods: Foods and Products	125
Forages and Pastures: Forage Quality	126
Growth and Development 1	127
Immunology and Pathology	129
Meat Science and Muscle Biology: Fresh Meat Quality of Ruminants, Nonruminants and Poultry	129
Nonruminant Nutrition: DDGS.	131
Nonruminant Nutrition: Energy	131
Nonruminant Nutrition: Enzyme	132
Nonruminant Nutrition: Fat.	134
Nonruminant Nutrition: Feed Additive	134

Physiology and Endocrinology: Adipose and Leptin	135
Physiology and Endocrinology: Hormonal Regulation of the Estrous Cycle in Beef Cattle	136
Physiology and Endocrinology: Male Reproduction, Gamete Cryopreservation, and Embryos	137
Physiology and Endocrinology: Nutritional Physiology	137
Processing and Products	138
Production, Management and the Environment: Dairy	138
Ruminant Nutrition: Calves and Heifers	141
Ruminant Nutrition: Dairy: Rumen Metabolism	142
Ruminant Nutrition: Proteins and Fats	145
Small Ruminant: Goat Production.	148
Teaching/Undergraduate and Graduate Education: Teaching	149

SYMPOSIA AND ORAL SESSIONS

Danisco International Dairy Science Award Lecture	150
Animal Behavior and Well-Being: Sow Housing, Management, and Stress	150
SYMPOSIUM: Animal Health: Accounting for Diseased Animals in Research Trials (Outliers, Treatments, Interactions)/ Disease Induction by Treatment?	151
SYMPOSIUM: ARPAS-Ruminant Nutrition Joint Symposium: Nutrition Models – Where Are We Going in the Next Decade?	151
Breeding and Genetics: Crossbreeding	152
Food Safety: Poultry Aspects	152
Forages and Pastures: Harvested Forages and Forage Quality	153
SYMPOSIUM: Immunology and Pathology: Immunity, Nutrition, Genomics, and Gut Microbiota	154
Lactation Biology 1	155
SYMPOSIUM: Meat Science and Muscle Biology: How Does Pre- and Postnatal Muscle Development Affect Meat Composition, Quality and Value?	155
Graduate Student Paper Competition: National ADSA Production MS Oral	156
Nonruminant Nutrition: Amino Acids 2	156
Nonruminant Nutrition: Feed Ingredients	157
Nonruminant Nutrition: Mineral Nutrition	158
Physiology and Endocrinology: Animal Physiology.	159
SYMPOSIUM: Physiology and Endocrinology: Sperm-Oviduct Interactions in Livestock and Poultry.	160
Production, Management and the Environment: Environment 1	160
Ruminant Nutrition: Beef: Vitamins and Minerals	161
Ruminant Nutrition: Dairy: Forages and Heifers	162
SYMPOSIUM: Small Ruminant: “Going, Going, Gone!” How Curtailment of Livestock Grazing on Federal Lands Could Alter the US Sheep Industry	163
SYMPOSIUM: Teaching/Undergraduate and Graduate Education: Surviving Promotion and Tenure with a Teaching Appointment	163

ADSA Foundation Scholar Lecture–Dairy Foods	163
ADSA Foundation Scholar Lecture–Production	164
Animal Behavior and Well-Being: Poultry 2: Broilers	164
Animal Health: Management, Disease, and Performance	164
SYMPOSIUM: ASAS-ADSA Cell Biology Symposium: Receptors and Signaling	165
SYMPOSIUM: Bioethics: Should Animal Welfare be Law or Market Driven?	166
Breeding and Genetics: Whole Genome Selection	166
SYMPOSIUM: Dairy Foods: Towards a Mechanistic Understanding of Probiotic Function in Man and Animals.	167
SYMPOSIUM: Forages and Pastures: Environmental Impact of Forage-Based Livestock Production Systems.	167
Growth and Development: Early Development and Fetal Programming	168
Immunology and Pathology: Poultry Immunology and Diseases	168
Graduate Student Paper Competition: National ADSA Production PhD Oral	170
Nonruminant Nutrition: DDGS.	170
Nonruminant Nutrition: Energy and Dietary Fat.	171
SYMPOSIUM: Nonruminant Nutrition: Models for Disease × Nutrition Evaluation and the Impact of Nutrition on Health, Disease, and/or Recovery	172
Nonruminant Nutrition: Vitamins and Management	172
Physiology and Endocrinology: Neuroendocrinology and Hormone Receptors.	173
Production, Management and the Environment: Dairy 1	174
Ruminant Nutrition: Beef: Proteins and Carbohydrates	175
Ruminant Nutrition: Dairy: Rumen Metabolism	176
Small Ruminant: Sheep and Goat Production 2	177
Swine Species	177
SYMPOSIUM: ADSA Production Division Symposium: Dairy Products and Human Health: The Facts.	178

Wednesday, July 14

POSTER PRESENTATIONS

Animal Health: Probiotics and Diet	178
Breeding and Genetics: Dairy Cattle	179
Dairy Foods: Microbiology	181
Dairy Foods: Processing	182
Dairy Foods: Protein	183
Extension Education	183
Food Safety 2	184
Forages and Pastures: Harvested Forages.	185
Growth and Development 2	187
Horse Species	189
International Animal Agriculture 1	189
Lactation Biology 2.	190

Nonruminant Nutrition: Gastrointestinal Physiology	191
Nonruminant Nutrition: Health	191
Nonruminant Nutrition: Management	192
Nonruminant Nutrition: Mineral	192
Nonruminant Nutrition: Mineral and Sow Nutrition	195
Physiology and Endocrinology: Endocrinology and Metabolism	195
Physiology and Endocrinology: Hormonal Regulation of the Estrous Cycle in Dairy Cattle	196
Physiology and Endocrinology: Integrative Physiology and Endocrinology	197
Physiology and Endocrinology: Lactational Physiology	197
Production, Management and the Environment: Beef	198
Production, Management and the Environment: Environment	199
Production, Management and the Environment: Management	200
Ruminant Nutrition: Beef 1	200
Ruminant Nutrition: Beef: Feedlot	203
Ruminant Nutrition: Dairy 1	204
Small Ruminant: Sheep Production 2	207
Swine Species	208

SYMPOSIA AND ORAL SESSIONS

World's Poultry Science Association (WPSA) Lecture	209
Animal Health: Respiratory Health, Viruses	209
SYMPOSIUM: ASAS Western Section Symposium: Perinatal Programming of Offspring Quality 1:	
Basic Concepts and Experimental Evidence	210
Beef Species: Beef Management	210
Breeding and Genetics: Milk and Carcass Composition	211
Dairy Foods: Cheese	211
Dairy Foods: Chemistry-Protein	212
Extension Education 2	213
Forages and Pastures: Dairy Forages	213
Growth and Development: Regulation of Adipogenesis and Adipose Tissue Development	214
Horse Species 2	214
Immunology and Pathology	215
Physiology and Endocrinology: Hormonal Control of Estrus in Beef Cattle	215
Production, Management and the Environment: Beef 1	216
Production, Management and the Environment: Dairy 2	217
Production, Management and the Environment: Environment 2	217
Ruminant Nutrition: Dairy: Fats and Carbohydrates	218
Ruminant Nutrition: Dairy: Minerals, Vitamins and Misc.	218
SYMPOSIUM: Sexed Semen Symposium: Applying Sexed Semen in Cattle	219

Small Ruminant: Sheep Production	219
SYMPOSIUM: Teaching/Undergraduate and Graduate Education: Beyond PowerPoint:	
Use of Technology in the Classroom	220
Animal Behavior and Well-Being: Dairy, Sheep, and Beef	220
SYMPOSIUM: ASAS Western Section Symposium: Perinatal Programming of Offspring Quality 2: Evidence for Impacts of	
Maternal Nutrition on Livestock Production	221
SYMPOSIUM: Beef Species: Upcoming Environmental Policies and Their Effects on Beef Production	222
Breeding and Genetics: Functional Traits and Fitness	222
SYMPOSIUM: Companion Animals: Comparative Enrichment: Implications for Health and Behavior.	223
SYMPOSIUM: CSAS Symposium: Issues in North American Livestock Transport	223
Dairy Foods: Foods and Products	224
Dairy Foods: Microbiology	224
Lactation Biology 2.	225
SYMPOSIUM: Meat Science and Muscle Biology: Impact of Pre- and Post-Slaughter Handling on Meat Quality.	225
Nonruminant Nutrition: Feed Additives	226
Nonruminant Nutrition: Health 2	227
Physiology and Endocrinology: Sperm Fertility, Embryos and Development.	227
Production, Management and the Environment: Beef 2.	228
Production, Management and the Environment: General.	229
SYMPOSIUM: PSA Emerging Issues: Social Sustainability of Egg Production	230
Ruminant Nutrition: Beef 2	230
Ruminant Nutrition: Beef: Forages and Grazing	231
Ruminant Nutrition: Dairy 2	232
SYMPOSIUM: Swine Species: Optimizing Swine Production for Lactating Sows and Young Pigs	233
Teaching/Undergraduate and Graduate Education: Graduate and Undergraduate Teaching 2	233

Thursday, July 15

SYMPOSIA AND ORAL SESSIONS

Animal Health: Probiotics, Performance, and Antioxidants	234
Food Safety: General Aspects	235
SYMPOSIUM: Horse Species: Pathogenic and Reproductive Dysfunction in Horses	235
International Animal Agriculture 1	236
Nonruminant Nutrition: Enzymes 2.	236
SYMPOSIUM: Nonruminant Nutrition: Nutrient and Non-Nutrient Sensing and Signaling in the Gastrointestinal Tract	237
Physiology and Endocrinology: Feed Intake, Metabolism and Maternal Nutrition	238
Ruminant Nutrition: By-Products and Supplements	239
SYMPOSIUM: Ruminant Nutrition: Acidosis: New Insights into the Persistent Problem	240

NOTES