



ADSA • PSA • AMPA • ASAS

**2007 Joint Annual Meeting • San Antonio, TX
July 8-12 • 2007**

Conference Information and Scientific Program



This Program Book is Brought to You By:

**DSM Nutritional Products
Elanco Animal Health
Milk Products, Inc.
Monsanto
Novus International
Pfizer Animal Health**

<http://adsa.psa.ampa.asas.org/2007>

Helping shape the landscape since 1954



ELANCO

TM

For more than half a century, Elanco has helped shape the animal health industry around the world — from the pastures of Nebraska to the pampas of Argentina, and in dozens of nations spanning the global horizon.

Wherever they raise animals, food producers count on Elanco for groundbreaking products that keep animals comfortable and healthy so they can perform to their full potential. We are known for a service philosophy founded on integrity, and for sharing reliable advice based on decades of experience and exploration.

Looking ahead, we remain devoted to transforming animal agriculture through superior products and services—supported by people who care.

Welcome to the 2007 Joint Meeting of ADSA™-PSA-AMPA-ASAS



Gary Hartnell
ADSA President



Drew Giesen
PSA President



Claudio Arzola-Alvarez
AMPA President



Maynard Hogberg
ASAS President

We're pleased you've joined us here in San Antonio to see old friends and make new ones and to exchange information with other scientists. The program committee's intent is to provide the very best in professional networking and educational opportunities for dairy, poultry, and animal scientists. This joint meeting is the first four-society meeting for ADSA, PSA, AMPA, ASAS, and we encourage each attendee to take advantage of the numerous cross-species, cross-discipline, and cross-cultural opportunities available.

This year's program is outstanding and promises something for everyone, including two pre-meeting symposia: the Triennial Growth symposium and Informal Nutrition symposium. The opening session will highlight Trent Loos as he delivers his positive perspectives on the state of agriculture today. Trent is respected for his general agriculture knowledge as well as his enthusiasm and passion. You don't want to miss his unique presentation as he sets the stage for the remainder of the week. During the joint meeting there will be 999 oral presentations, 1,117 posters, and more than 40 symposia. Our program committees did a tremendous job organizing symposia covering a wide range of important topics including food safety; bioethics; foodstuffs; nutrition; teaching/undergraduate and graduate education; breeding and genetics; physiology and endocrinology; animal behavior and well-being; growth and development; international animal agriculture; production, management, and environment; and a session on ongoing changes in the ingredient arena.

Poster presentations will be held from 7:30 to 9:30 am on Monday, Tuesday, and Wednesday. Oral scientific sessions will follow from 9:30 am to 12:30 pm on Monday and Tuesday, 10:30 am to 12:30 pm on Wednesday, 8:30 am to 12:30 pm on Thursday, and from 2:00 to 5:00 pm on Monday, Tuesday, and Wednesday.

The award ceremonies are certain to be on the list of highlights again this year. Award ceremonies have been staged to avoid conflicts among the respective societies. The ASAS awards ceremony will be held on Monday, July 9, ADSA's ceremony will be held on Tuesday, July 10, and the PSA banquet and awards ceremony will be held on Wednesday, July 11. Ideally, this allows you to attend one or all award ceremonies. In addition, AMPA will have a dinner on Wednesday night. An old-fashioned ice cream social open to all attendees will be held on Tuesday night after the ADSA award ceremony. Be sure to join us.

We invite all meeting attendees and their families to attend the closing reception on Wednesday, July 11. The agenda for this year's meeting is a testament to the program organizers, who have invested enormous amounts of time and effort to bring distinguished scientists in animal agriculture and animal food products from around the world for this special event. Our thanks go out to the ADSA-PSA-AMPA-ASAS program committees and especially the staff of ADSA, PSA, ASAS, and FASS for their hard work. Our program committee, Murray Bakst (Chair), Maurice Eastridge, Ron Pearson, Steven Lonergan, Jim Oltjen, Muquarrab Qureshi, Mary Beck, and Claudio Arzola-Alvarez along with FASS staff members Jennifer Gavel, Joy McClaugherty, Keely Roy, Louise Audrieth, Louise Adam, Judy McClughen, Vicki Paden, Mary Swenson, Cara Tharp, Ted Veatch, Mark Budden, and Kevin Wolter (to name just a few), have done a fantastic job. As well, we must extend special thanks to the Executive and Associate Executive Directors of ADSA, PSA, and ASAS—Peter Studney, Jim Kessler, Meghan Wulster-Radcliffe, and Paula Schultz—for working hard to keep everything headed in the right direction.

Thank you for participating in the ADSA-PSA-AMPA-ASAS joint meeting and for making it a success.

Table of Contents

Welcome Letter	1
General Meeting Information	3
Headquarter Hotels	5
San Antonio Information	6
Transportation	12
Special Events	13
Award Donors	20
Exhibit Schedule and Floor Plan	21
Guide to Exhibitors	22
Exhibit Directory	24
Corporate Sustaining Members	43
Downtown San Antonio Housing Map	45
Convention Center and Hotel Maps	46
Meeting Sponsors	54
Schedule of Events	55
ADSA SAD Schedule of Events	59
Scientific Program Table of Contents	63
ADSA Dairy Foods Division Schedule of Events	72
Scientific Sessions	73
Author Index	233
Program at a Glance	262

<http://adsa.psa.ampa.asas.org/2007>

Important Message

In the event that protestors interrupt your meetings, please ignore them. Their goal is to attract attention. Any attention you give them will only help them. Please ignore them and continue your regular business. Convention staff has a plan in place to handle these situations and they depend on your cooperation. If the media approaches you for an interview, please politely refuse and direct them to the convention's media room, where spokespersons are available.

Thank you for your cooperation.

General Meeting Information

Location

The Henry B. Gonzalez Convention Center is nestled in the heart of historic downtown San Antonio along the banks of the world-famous River Walk. The River Walk has multiple personalities—quiet and park-like in some stretches and full of activity with European-style sidewalk cafés, specialty boutiques, nightclubs, and gleaming high-rise hotels in other areas. The River Walk stretches for approximately 2½ miles from the Convention Center on the north end to the King William Historic District on the south end. The River Walk offers attendees easy access to shopping, restaurants, and hotels.

Schedule of Events

The meeting will kick off Sunday evening with the opening session and reception and then continue with 3½ days of scientific sessions, ending at noon on Thursday. The 2007 opening session will feature Trent Loos as keynote speaker. The complete schedule of events can be found on page 55 of this program, or online at <http://adsa.psa.ampa.asas.org/2007>.

Program Format for 2007

Poster sessions:	7:30 am - 9:30 am
Scientific sessions:	9:30 am - 12:30 pm
Lunch breaks:	12:30 pm - 2:00 pm
Scientific sessions:	2:00 pm - 5:00 pm

Registration Hours

Registration will be located in front of Exhibit Hall C of the Henry B. Gonzalez Convention Center in San Antonio. Registration hours for the 2007 ADSA-PSA-AMPA-ASAS Joint Meeting, including special symposia and other events, will be as follows:

Saturday, July 7 (pre-registered only)	12:00 pm - 5:00 pm
Sunday, July 8	7:00 am - 7:00 pm
Monday, July 9	6:30 am - 4:00 pm
Tuesday, July 10	7:00 am - 3:30 pm
Wednesday, July 11	7:00 am - 3:00 pm
Thursday, July 12	8:00 am - 10:00 am

Important Phone Numbers

Registration Desk	210-582-7011
Drury Plaza Hotel	210-270-7799
Hilton Palacio del Rio	210-222-1400
Hotel Valencia	210-227-9700
Hyatt Regency	210-222-1234
Marriott Rivercenter	210-223-1000
Marriott Riverwalk	210-224-4555
Westin Riverwalk	210-224-6500
Henry B. Gonzalez Convention Center	210-207-8500
San Antonio Convention and Visitors Bureau	800-447-3372
Time, Temperature & Weather	210-225-0404
Online weather information is available at: http://www.sanantoniocvb.com/visitors/com_weather.asp	

Media Check-In

Please check in at the Registration Desk outside Exhibit Hall C of the Convention Center.

Speaker Ready Room

The Speaker Ready Room is located in Room 211 on the 2nd level of the Convention Center. This room will be available for speakers from 7:00 am to 5:00 pm on each day of the meeting.

Business Center

For your convenience, The UPS Store is located on the main level of the Convention Center between the lobby area and the registration area. The store is open Monday through Friday from 8:00 am to 6:30 pm and on Saturday from 9:00 am to 5:00 pm.

Hospitality Lounge

The Hospitality Lounge will be located in Room 208 on the 2nd level of the Convention Center. This lounge will offer attendees an area to relax, network, and catch up with old friends.

Notice to Oral Presenters and Invited Speakers

Please note that all session rooms will be equipped with a computer and LCD projector. All oral presentations and invited speaker presentations will be preloaded before the meeting.

Poster Presentations

We have dedicated a two-hour block each morning to poster presentations. The “open posters” will be from 7:30 am to 9:30 am on Monday, Tuesday, and Wednesday in the Convention Center, Exhibit Hall C. Oral sessions will begin at 9:30 am on Monday and Tuesday, 10:30 am on Wednesday, and 8:30 am on Thursday.

Each poster presentation will be available for public viewing for the entire day, with the presenting authors present during the “open posters” time (7:30 am to 9:30 am). All posters must be mounted on the board 30 minutes before the beginning of the day’s session (**poster sessions open at 7:30 am, so posters must be mounted on boards by 7:00 am**). The exhibit hall will open at 6:15 am, Monday through Wednesday. **Posters must be removed between 5:00 pm and 5:30 pm each day.** Any posters remaining after 5:30 pm will be removed by the convention center staff and discarded.

The poster board surface area is 48 inches high and 96 inches wide; use of this space is dictated by the presenter with the following exceptions: the top of the poster space should include the abstract number, title, authors, and affiliations. The lettering for this section should be at least 1 inch high.

Locating the Correct Poster Board

Each poster board number corresponds to the abstract number as noted in the program. Monday posters will have an “M”, Tuesday posters a “T”, and Wednesday posters a “W” preceding the board number.

Camera, Video Camera, and Cell Phone Policy (NEW)

Use of cameras, video cameras, and cell phones (for calls or as cameras) is prohibited during oral and poster presentations to minimize disruption and unauthorized dissemination of data. Anyone found in violation of this policy will be asked to leave the session.

ARPAS Continuing Education Units

The 2007 ADSA-PSA-AMPA-ASAS Joint Annual Meeting has been approved for up to 21 continuing education units (CEUs) for the American Registry of Professional Animal Scientists certification requirements. Check the schedule of events for times and location of the ARPAS exams.

Continuing Education Credits for Veterinarians – RACE

Many of the symposia at the 2007 ADSA-PSA-AMPA-ASAS Joint Annual Meeting will be approved for RACE credits. Symposia approved for RACE credits will be posted online at <http://adsa.psa.ampa.asas.org/2007>. Information regarding the RACE program can be found at www.aavsb.org.

Job Resource Center

The ADSA-ASAS-PSA Job Resource Center is located in Exhibit Hall C. Job announcements and resumes will be organized into the following categories for posting and distribution: Animal Behavior & Well-Being, Animal Health, Animal Breeding, Companion Animals, Extension, Food Safety, Food Science, Forages & Pastures, Genetics, Growth & Development, International Animal Agriculture, Lactation, Meat Science & Muscle Biology, Nonruminant Nutrition, Nutrition, Pharmacology & Toxicology, Physiology & Endocrinology, Poultry, Production & Management, Ruminant Nutrition, and Teaching.

Cyber Café

Keep in touch with work, family, and friends during the ADSA-PSA-AMPA-ASAS Joint Annual Meeting at the Cyber Café. Located in Exhibit Hall C of the Henry B. Gonzales Convention Center, the Cyber Café is available to all meeting attendees.

Official Meeting Hotels

Hilton Palacio del Rio – PSA HQ

200 South Alamo Street
San Antonio, Texas 78205
Phone: 210-222-1400; Fax: 210-270-0761

Westin Riverwalk – overflow hotel

420 W Market Street
San Antonio, Texas 78205
Phone: 210-224-6500; Fax: 210-444-6000

Marriott Rivercenter – ADSA/ASAS HQ

101 Bowie Street
San Antonio, Texas 78205
Phone: 210-223-1000; Fax: 210-223-6239

Drury Plaza Hotel – overflow hotel

105 S. St. Mary's Street
San Antonio, Texas 78205
Phone: 210-270-7799; Fax: 210-222-8863

Marriott Riverwalk – ADSA/ASAS HQ

711 East Riverwalk
San Antonio, Texas 78205
Phone: 210-224-4555; Fax: 210-224-2754

Hotel Valencia Riverwalk – overflow hotel

150 E. Houston Street
San Antonio, Texas 78205
Phone: 210-227-9700; Fax: 210-227-9701

Hyatt Regency San Antonio – Student HQ

123 Losoya
San Antonio, Texas 78205
Phone: 210-222-1234; Fax: 210-227-4925

Welcome to San Antonio

San Antonio captures the spirit of Texas. Now the eighth-largest city in the United States, the city has retained its sense of history and tradition, while carefully blending in cosmopolitan progress. Sounds and flavors of Native Americans, Old Mexico, Germans, the Wild West, African-Americans, and the Deep South mingle and merge. Each year, almost twenty million visitors delight in the discovery of San Antonio's charms.

Texas History 101

For history buffs, San Antonio is a mecca. Native Americans first lived along the San Antonio River, calling the area "Yanaguana," which means "refreshing waters," or "clear waters." A band of Spanish explorers and missionaries came upon the river in 1691, and because it was the feast day of St. Anthony, they named the river "San Antonio."

The actual founding of the city came in 1718 by Father Antonio Olivares, when he established Mission San Antonio de Valero, which became permanently etched in the annals of history in 1836 as the Alamo, where 189 defenders held the old mission against some 4,000 Mexican troops for 13 days. The cry "Remember the Alamo!" became the rallying point of the Texan revolution against Mexico. Located in the heart of downtown, today the Alamo is a shrine and museum.



**Visit us at
booth #211**

For just about everyone.

There's not an animal you work with that we can't help. Beef cattle, horses, poultry, hogs, aquaculture, dairy cows and more benefit from Diamond V Yeast Culture.™ Yeast culture is recognized the world over for optimizing digestion and maximizing animal performance. Years of research demonstrate that it works. Nutritionists and veterinarians trust it to perform. Producers around the world have seen the results. Trust Diamond V Yeast Culture to help your clients' animals. Learn more at www.diamondv.com or call 1-800-373-7234.

Diamond V is a registered trademark and Diamond V Yeast Culture and Research Tested. Performance Proven. are trademarks of Diamond V Mills, Inc.
©2007 Diamond V Mills, Inc. All rights reserved.



Diamond V
Research Tested. Performance Proven.™

The Alamo

300 Alamo Plaza, San Antonio

Phone: 210-225-1391 x34

www.thealamo.org

On the east side of Alamo Plaza is the most famous spot in Texas, where 189 defenders fell on March 6, 1836, after repeated attacks by Mexican General Santa Anna's army. Mission San Antonio de Valero (the Alamo) was established in 1718 as the city's first mission. The chapel, one of the most photographed façades in the nation, and the Long Barracks are all that remain of the original fort. Hours: 9 am to 5:30 pm, Monday to Saturday; 10 am to 5:30 pm, Sunday. Admission free; donations accepted.

Aztec on the River

201 E. Commerce Street, Suite 300, San Antonio

Phone: 210-227-3930; Toll free: 800-432-9832

www.aztecontheriver.com

The Aztec On The River™ is the River Walk's newest and most exciting attraction. This historic 1926 movie palace has been meticulously restored, complete with a Mighty Wurlitzer theatre organ. Enjoy a free multi-million dollar special effects show in the Grand Lobby every 90 minutes, a giant screen theatre with incredible surround-sound, plus unique shopping and dining. Open daily; call for show times. Group, senior, and military discounts available. On the River Walk at the corner of E. Commerce and N. St. Mary's Streets.

La Villita

418 Villita #900, San Antonio

Phone: 210-207-8612

www.lavillita.com

A unique arts and crafts community with shops, working artists, restaurants, and a post office. The Old San Antonio Exhibit (located in Bolivar Hall) houses a collection of art objects, artifacts, and symbols relevant to the history. Shops open daily 10 am to 6 pm; closed on holidays. Free admission.

Market Square-El Mercado

514 W. Commerce, San Antonio

Phone: 210-207-8600

www.marketsquaresa.com

From early morning until late at night, Market Square is alive with activity. Visitors browse through the 32 shops at "El Mercado," an area patterned after an authentic Mexican market. In addition, there are 80 specialty shops in Farmer's Market Plaza. Hours: 10 am to 8 pm. Free admission.

River Walk (Paseo Del Rio)

110 Broadway, Suite 440, San Antonio

Phone: 210-227-4262

www.thesanantonioriverwalk.com

Lush green foliage lines the banks of this peaceful, historic river. Cobblestone walkways lead visitors to the river-level restaurants and shops. The river bubbles to the surface on the grounds of the University of the Incarnate Word and flows to downtown, threading its way through the city one level below the hustle and bustle of city streets.

San Antonio Botanical Garden

555 Funston, San Antonio

Phone: 210-207-3250

www.sabot.org

At this 33-acre living museum, one can enjoy colorful seasonal floral displays, a serene native forest walk, exotic plant specimens from around the world, modernistic glass pyramids, and even an authentic log cabin. The historic Carriage House, your entry point to the garden, also includes the gift shop and restaurant (kitchen closed on Mondays). Garden is open every day from 9 am to 5 pm. Admission: adults \$6.00; children (3-13) \$3.00; seniors (55 and up) \$4.00; student/military (with ID card) \$4.00.

San Antonio IMAX Theatre Rivercenter

849 E Commerce, #285, San Antonio

Phone: 210-247-4629; Toll free: 800-354-4629

www.imax-sa.com

"Alamo-The Price of Freedom," is a 45-minute docudrama about the 13-day siege and fall of the Alamo. Watch the battle unfold, where 189 defenders who fought and died for the cause of Texas liberty. Other IMAX features, including IMAX 3D, also show. Shows daily from 9 am to 10 pm. Admission: adults \$9.25; children (3-11) \$6.24; senior (65+) and youth (12-17) \$8.33 (plus tax). Advance reservations and assigned seating are available.

ANKOM
TECHNOLOGY

Wireless Gas Production Measurement



ANKOM^{RF}
GAS PRODUCTION SYSTEM
Low Cost Starter Kit

- Easily measure kinetics of microbial metabolism
- Continuous computer control of each module
- Modular and Expandable (up to 50 modules)

See it in action at booth: 417 / 516

For more info:
Visit: www.ANKOM.com
Email: gaspro2@ankom.com
Phone: 315 986 8090

Tastes change.

That's where we come in.

Change is constant. And custom designed flavors for feed can help optimize performance whenever feed formulations and product lines change. Our cutting-edge research and flavor technology, allows us to create individualized flavors ideally suited for new feed formulations. Ask how.

Lucta

Custom flavors for improved performance.

Lucta USA, Inc. • 1-800-323-5341 • email: usa@lucta.com
www.lucta.com • 1829 Stanley St., Northbrook, IL 60062

San Antonio Missions National Historical Park

2202 Roosevelt Ave., San Antonio

Phone: 210-534-8833

www.nps.gov/saan

Representing both church and state, these missions were charged with converting the local Native Americans, collectively called Coahuiltecans, into devout Catholics and productive members of Spanish society. This was the greatest concentration of Catholic missions in North America. The visitor center is located next to Mission San Jose and includes a theater showing a 20-minute depiction of early life at the mission as well as a museum and book shop. Hours: 9 am to 5 pm daily. Free admission.

San Antonio Zoological Gardens and Aquarium

3903 N. St. Mary's St., San Antonio

Phone: 210-734-7184

www.sazoo-aq.org

Ranked as one of the best zoos in the nation exhibiting more than 3,500 animals of 750 species. At the headwaters of the San Antonio River, the zoo encompasses 35 landscaped acres and includes one of the largest bird collections in the world. The zoo has a magnificent mini-zoo designed specifically for children under 5. Open 365 days a year. Hours: 9 am to 6 pm. Admission: adults \$9; seniors (62+) and children (3-11) \$7; military \$8; under 2 free.

Cooperative State Research, Education, and Extension Service U.S. Department of Agriculture

www.csrees.usda.govnricgp@csrees.usda.gov

Animal Genome • Animal Growth & Nutrient Utilization
Animal Protection & Biosecurity • Animal Reproduction



NRI National Research Initiative Competitive Grants Program

CSREES' mission is to advance knowledge for agriculture, the environment, human health and well-being, and communities.

Spanish Governor's Palace

105 Plaza de Armas, San Antonio

Phone: 210-224-0601

www.sanantonio.gov/sapar

A national historic landmark labeled “the most beautiful building in San Antonio” by the National Geographic Society, the palace once housed the officials of the Spanish Province of Texas. Hours: 9 am to 5 pm, Monday to Saturday; 10 am to 5 pm, Sunday. Admission: adults \$1.50, children (7-13) 75 cents.

Sunset Station

1174 E Commerce, San Antonio

Phone: 210-474-7640

www.sunset-station.com

Sunset Station, nestled in the historic St. Paul district, offers you a unique experience in downtown San Antonio. Enjoy dining at Aldaco's Mexican Cuisine or Ruth's Chris Steak House or experience a self-paced walking tour to marvel at the turn-of-the-century architecture. Free evening shuttle service is available (just ask your concierge), and Sunset Station is also a stop on the yellow trolley line. Sunset Station blends the romance of the Hispanic culture with the charm of South Texas.

LIV-PRO®

A good offense...Promoting digestive health

TOXISCREEN™

A good defense...Detecting feed toxicity



MLF Biotech, Inc.®
Improving Health and Food Safety, Naturally®

MLF Biotech Inc. offers a great, well-balanced team in **LIV-PRO®** and **ToxiScreen™**. Improve your birds' performance and increase your profits with these great products today! Visit **www.mlfbiotech.com** for more information.



Rhodimet®

Methionine in Both Powder & Liquid Analog Forms



Rovabio®

Enzymes in Both Liquid & Powder Forms



Microvit®

Full Line of Vitamins



MetaSmart® & Smartamine®

Ruminant Methionine

Visit our website at www.adisseo.com for more information
One Point Royal | 4400 North Point Parkway
Suite 275 | Alpharetta, GA 30022
USA - Tel: 678-339-1500 or 800-727-1019 - Fax: 678-339-1600
Canada - Tel: 905-659-9555 or 800-387-2123 - Fax: 888-821-7726

ADISSEO
A Bluestar Company

Adding Difference

Tower of the Americas

600 HemisFair Park, San Antonio

Phone: 210-223-3101

www.toweroftheamericas.com

Built in honor of the 1968 World's Fair celebrating San Antonio's 250th anniversary, the 750-foot-tall Tower of the Americas has offered residents and tourists of San Antonio the most breathtaking view of the Alamo City for more than 35 years.

- The Eyes Over Texas restaurant treats guests to pure dining pleasure with a delectable menu, sophisticated atmosphere, and 360-degree revolving vistas.
- The Skies Over Texas is a sophisticated ride that takes visitors on a high-flying trip across the Lone Star State. The 4-D theater zooms in on such scenes as a Friday night high-school football game, a space shuttle at NASA, and more.

A ground-level café and retail shop give visitors more ways to enjoy their day. Additional amusements, attractions, and food vendors greet guests at the base of the Tower.



**A New Class of Yeast Culture
Now with Metabolites
Qualified and Quantified!**

Better Products Through Better Science!



**Come see us at
booth 336 and 338!**

**Research proven shows milk production
2.7 lbs. above competitor!**

Organic Approved!

THE NEW EVOLUTION IN YEAST CULTURE



VI-COR®
Varied Industries Corporation

905 South Carolina Ave. • Mason City, IA 50401
Phone: 641-423-1460 • www.vi-cor.com

Currency Exchange

Bank of America

300 Convent, San Antonio

Phone: 800-299-2265

Hours: 9 am - 4 pm, Monday to Thursday; 9 am - 5 pm, Friday

Languages: English and Spanish

Currencies: major

Traveler's checks: accept foreign up to \$500; sell foreign in exchange for US currency only (ask for guidelines).

Frost Bank

100 W. Houston, San Antonio

Phone: 210-220-5651

Hours: 9 am - 4 pm, Monday to Thursday; 9 am - 5 pm, Friday

Languages: English and Spanish

Currencies: 18

Traveler's checks: accept and sell selected foreign traveler's checks.

Transportation

Accessibility

San Antonio is accessible by car from three major interstate highways: I-35, I-10, and I-37. The San Antonio International Airport is approximately eight miles from downtown and is directly linked via US Hwy 281.

Transportation in San Antonio

Shuttle service from the airport to downtown San Antonio is available for \$14 one-way and \$24 round-trip through SATRANS Airport Shuttle (phone: 210-281-9900; <http://www.saairportshuttle.com/>).

Cab fare between the airport and downtown San Antonio is approximately \$20 each way. The trip takes approximately 15 to 20 minutes. Taxicabs can be hailed at the airport or from your hotel in minutes.

Downtown travel is a breeze on the VIA Streetcar, an open-air authentic reproduction of a rail streetcar that traveled the streets of San Antonio more than 50 years ago. There is convenient access to all routes from the downtown streetcar station on Convention Plaza. Fare is \$1.00.

Special Events

Scheduling and locations are subject to change without notice.

William Chalupa Recognition Symposium, Reception & Dinner*

Saturday, July 7

1:00 pm - 6:00 pm Symposium

Convention Center, 006CD

6:00 pm -10:00 pm Reception & Dinner

Convention Center, Grotto & 008AB

****Pre-registration required for these events***

Throughout his 40-year career in academia and the pharmaceutical industry, Dr. Chalupa has made important contributions to the dairy industry. Join us for the afternoon symposium, which will cover highlights of his career presented by colleagues and industry associates, and then stay for the evening reception and dinner for an enjoyable opportunity to mix and mingle with the many friends and fans of Dr. Chalupa.

Dairy Quiz Bowl

Sunday, July 8

5:00 pm - 5:30 pm

Convention Center, 007D

On Sunday, university teams from across the US will compete in the ADSA Dairy Quiz Bowl. The event gives schools an opportunity to demonstrate their knowledge about dairy production, processing, and ADSA history. The Student Affiliate Division invites you to join them for the excitement of the final round of competition as the top two schools go head-to-head for the title of 2007 Dairy Quiz Bowl Winning Team.

Opening Session

Sunday, July 8

7:00 pm - 8:00 pm

Convention Center, Ballroom C

Join us for an unforgettable opening session as Trent Loos delivers his positive perspectives on the state of agriculture today. Host of the daily radio programs "Loos Tales" and "Rural Route" as well as other broadcasts, Trent is well-known for his agricultural activism. He has traveled the United States (and, cyberly, the world) to share his passion for an industry he truly believes in. This program serves as the perfect upbeat lead-in to the informative and challenging sessions ahead.

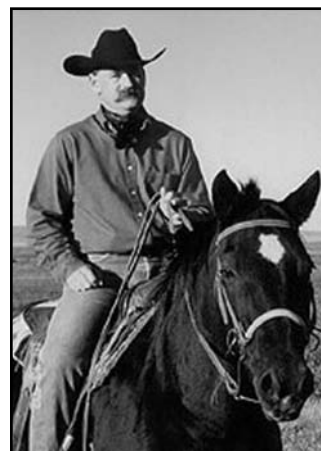

Opening Reception
Sunday, July 8
8:00 pm - 10:00 pm
Convention Center, Ballroom C

Wind down the evening by joining us in the Ballroom foyer after the opening session for some long-awaited socializing with colleagues and friends.

ASAS Graduate Student Business Meeting
Monday, July 9
12:30 pm - 1:00 pm
Convention Center, 207A

The ASAS Graduate Directors invite all ASAS graduate student members to a business meeting on Monday, July 9, from 12:30 pm to 1:00 pm. This business meeting has been established in response to a direct request from several graduate student members. It serves as an opportunity for graduate students to voice their opinions and concerns. The ASAS Graduate Directors are seeking graduate student members' opinions on the direction of ASAS and how the society can meet their needs. All registrants interested in opportunities for ASAS and graduate students are welcome to attend.

ADSA Town Hall Meeting
Monday, July 9
5:00 pm - 6:00 pm
Convention Center, 206A

The ADSA Board of Directors invites attendees to a town hall meeting on Monday, July 9, from 5:00 pm to 6:00 pm in the Convention Center. This year's meeting will focus on progress made in implementing ADSA's 2006 Strategic Plan. A report on the ADSA Foundation will also be made. All registrants interested in ADSA are welcome.

ASAS Awards Program
Monday, July 9
7:00 pm - 8:30 pm
Marriott Rivercenter, Salon E

All meeting participants, families, and friends are welcome to attend the 2007 ASAS Awards Program. Please join us at this special event to recognize and congratulate the 2007 ASAS award winners at the Marriott Rivercenter on Monday, July 9.

Graduate Student Mixer*
Monday, July 9
9:00 pm - Closing
Steers & Beers Steakhouse & Saloon
Rivercenter Mall
****Pre-registration recommended***

Join your fellow graduate students from ASAS, ADSA, PSA, and AMPA at a mixer at Steers & Beers steakhouse and saloon (<http://www.steersandbeers.net>). Located on the River Walk in the heart of the entertainment district, Steers & Beers is a down-home Texas establishment where you can kick back and relax in a Western environment. This event will provide an opportunity to catch up with old friends and make new ones, so don't miss it. Pre-registration is highly recommended.

Exhibitor Reception

Monday, July 9

4:00 pm - 6:00 pm

Convention Center, Exhibit Hall C

Relax after a high-energy first day of meeting with drinks and snacks in the Exhibit Hall. While there, take some time to peruse the exhibits to learn more about the latest products and services in our industries.

5K Fun Run*

Tuesday, July 10

6:15 am

Meet at the San Antonio Convention Center

****Pre-registration required***

Join in the fun on Tuesday, July 10, at 6:15 am. Enjoy beautiful downtown San Antonio while running this 5-km course. T-shirts and refreshments will be provided.

ASAS Centennial 2008

*Play your part in
the next 100 years.*



*Join the celebration
July 7-11, 2008
Indianapolis, IN*

<http://www.asas.org>

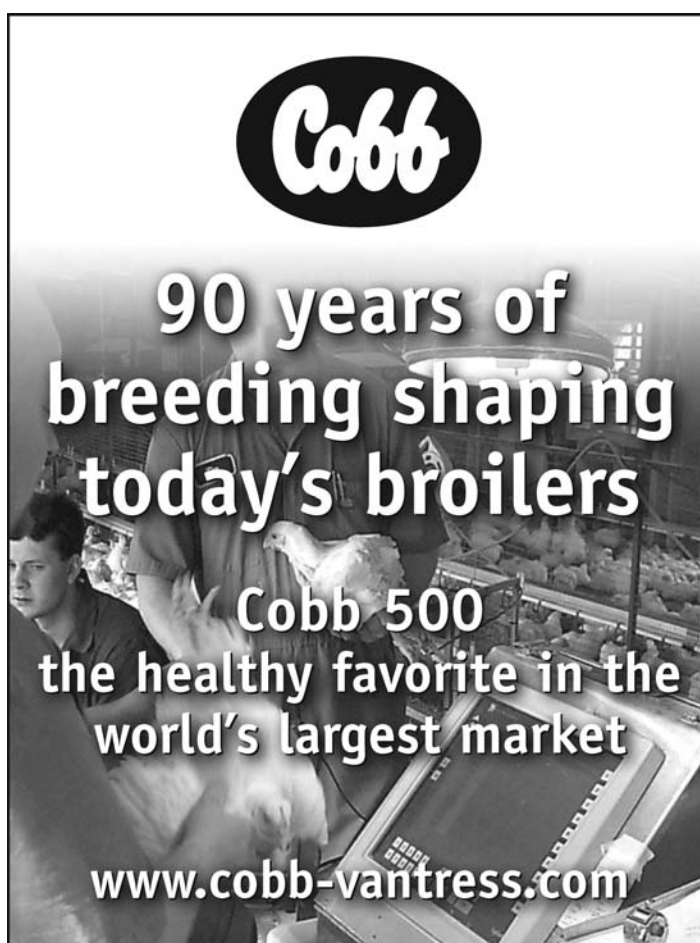

Cobb

**90 years of
breeding shaping
today's broilers**

Cobb 500
**the healthy favorite in the
world's largest market**

www.cobb-vantress.com

Spouse Events*
Tuesday, July 10

10:30 am - 11:30 am

City Trolley Tour, meet in front of the Alamo

****Pre-registration required; attendance is limited***

See the San Antonio sites as they did in days gone by—with a view from the Alamo Trolley. Beginning at the Alamo, this fully narrated one-hour trolley tour takes you through the heart of San Antonio's historic and cultural districts to give you an insider's perspective on this Texas landmark city.

11:30 am - 1:30 pm

Luncheon at the historic Menger Hotel; meet in the Menger lobby

****Pre-registration is required; attendance is limited***

At the conclusion of the trolley tour, step next door to experience the unique charms of the Menger Hotel. You'll enjoy a satisfying buffet lunch while a long-time hotel employee regales you with fascinating stories from the hotel's past...including a few ghost sightings.

SAD Awards Luncheon*

Tuesday, July 10

11:45 am - 2:00 pm

Convention Center, 008AB

****Pre-registration required***

Plan to attend this year's SAD Awards Luncheon. The afternoon will be capped with presentation of student awards and announcement of the new SAD officers. Both students and professionals are encouraged to attend. This is a wonderful chance to get to know the next generation of the dairy industry.

Poultry Science Student Luncheon*

Tuesday, July 10

12:30 pm - 2:00 pm

Hilton Palacio del Rio, El Mirador

****Pre-registration required***

Poultry science students—don't miss this opportunity to meet and interact with your peers from other universities while creating your own "taste of San Antonio" taco extraordinaire! Hang out, make friends, and enjoy the company of the future of poultry science.

NE ASAS/ADSA Business Meeting & Awards Luncheon***Tuesday, July 10****12:30 pm - 2:00 pm****Convention Center, 007B*****Pre-registration required**

The ASAS Northeast Section and ADSA Northeast Branch will hold their annual business meeting and awards luncheon on Tuesday, July 10. Members are invited to attend and catch up with other members of the section. This is a good time to honor the NE award winners and the Graduate Student Competition winners.

San Antonio River Talk: The ASAS Open Forum**Tuesday, July 10****5:00 pm - 6:00 pm****Convention Center, 203**

Attendees are invited to the San Antonio River Talk: The ASAS Open Forum on Tuesday, July 10, from 5:00 pm to 6:00 pm in Room 203 of the Convention Center. You will have the opportunity to join in on discussions on current ASAS issues including Open Access and on the new ASAS Strategic Plan that is scheduled to be presented to the membership in 2008.

The Dairy Research You Need

**DMI at
ADSA****Symposium**

The Dairy Management Inc.™ (DMI)
National Dairy Foods Research Center Program:
Responding to Industry Needs for New
Technologies, Products and Markets

1:30-5 pm • Monday, July 9
Henry B. Gonzales Convention Center, Room 202

ADSA Awards Program
Tuesday, July 10
7:00 pm - 8:00 pm
Marriott Rivercenter, Salons A-B

All meeting participants, families, and friends are welcome to attend the 2007 ADSA Awards Program. Please join us at this special event to recognize and congratulate the 2007 award winners at the Marriott Rivercenter.

2007 ADSA-PSA-AMPA-ASAS Ice Cream Social
Tuesday, July 10
8:15 pm - 9:30 pm
Marriott Rivercenter, Salon I

Ice cream—we're going to eat ice cream! All meeting participants, families, friends, and award donors are invited to join us for the time-honored Ice Cream Social.

ADSA Foundation Auction and Raffle
Tuesday, July 10
8:15 pm - 9:30 pm
Marriott Rivercenter, Salon E

This year, the ADSA Foundation Auction and Raffle will offer a wide array of items including dairy antiques, valued collectibles, trips, and much more. To donate an item or view the latest list of items, visit the auction web site at: <http://www.adsa.org/FoundationAuction2007/>

Closing Reception
Wednesday, July 11
4:30 pm - 6:00 pm
Convention Center, 006

All meeting participants, families, and friends are welcome to attend the closing reception, highlighting this year's involvement of AMPA, on Wednesday evening. Again this year, attendees will have the opportunity to indicate their home affiliation on a world map; check the Exhibit Hall for the poster board before the reception.

PSA Awards Banquet*
Wednesday, July 11
6:00 pm - 10:00 pm
Hilton Palacio del Rio, Salon del Rey
****Pre-registration required***

Please join us for a celebratory evening honoring the 2007 award winners. All meeting participants, spouses, and friends are welcome at this event. The banquet will be at the Hilton Palacio del Rio (the PSA headquarters hotel). The evening is sure to be a good time for all. Please make sure to purchase your ticket in advance; a limited number of tickets will be available for purchase at the registration desk.

AMPA Dinner*

Wednesday, July 11

6:30 pm - 10:30 pm

Marriott Rivercenter, Conference Rooms 17-18

***Pre-registration required**

Please join us and visit with Mexican friends. All meeting participants, spouses, and friends are welcome at this event. Please make sure to purchase your ticket in advance. A limited number of tickets will be available for purchase at the registration desk.

**AMPA welcomes you to
its annual meeting**



<http://www.agropecstar.com/usuarios/ampa/index.htm>



Sometimes,
what's inside
just isn't what
you'd hoped for.

Quantum
Phytase



NOT COATED—BECAUSE IT DOESN'T HAVE TO BE.
Only Quantum™ Phytase was designed to deliver consistently superior animal performance and to be inherently thermo-tolerant—eliminating the compromises traditionally associated with heavy coatings. Quantum Phytase is active at the right time, in the right place and at the right temperature so your animals benefit from a stable and immediately active product with no barriers to effectiveness.

syngenta
animal nutrition

www.syngentaanimalnutrition.com

Quantum Phytase is currently approved for sale in Brazil, Canada, Malaysia, Mexico, Pakistan, South Africa and Thailand. Quantum™, the Quantum logo and the Syngenta Animal Nutrition logo are trademarks of a Syngenta Group Company. © 2007 Syngenta Animal Nutrition, Inc.

2007 ADSA Award Donors

Alltech, Inc.	International Dairy Foods Association
ABS Global, Inc.	Land O'Lakes
ADSA Foundation	Land O'Lakes, Purina Feed LLC
American Dairy Science Association	Merial Limited, Inc.
American Feed Industry Association	Milk Industry Foundation
Cargill Animal Nutrition, Inc.	National Milk Producers Federation
DMI Inc.	Nutrition Professionals, Inc.
Danisco USA, Inc.	Pfizer Animal Health, Inc.
DeLaval Inc.	Pioneer Hi-Bred International, Inc.
Elanco Animal Health	West Agro, Inc.
Hoard's Dairyman	

2007 ASAS Award Donors

ABS Global, Inc.	Merial Limited
American Feed Industry Association	Monsanto Company
American Society of Animal Science	Morrison Award Fund
American Society of Animal Science Foundation	Omega Protein Corporation
Center for Regulatory Services, Inc.	Pfizer Animal Health
DSM Nutritional Products, Inc.	The Iams Company
Elanco Animal Health	
Land O'Lakes, Purina Mills LLC	

2007 PSA Award Donors

Alltech, Inc.	Merial Select, Inc.
American Egg Board	National Chicken Council
American Feed Industry Association	Nicholas Turkey
Embrex, Inc.	Phibro Animal Health
Hy-Line International	Poultry Science Association, Inc.
Land O'Lakes, Purina Feed LLC	Poultry Science Foundation
Maple Leaf Duck Farm	Tyson Foods, Inc.
Merck & Co., Inc.	United Egg Producers

2007 AMPA Award Donors

Fundacion Produce Nuevo Leon A. C.	Universidad Autónoma de Chapingo
Fundacion Produce Chihuahua A. C.	AGROPEC Star
Consortio Técnico del Noreste de México A. C.	

Exhibit Schedule

Exhibit Hours:

Sunday, July 8	Exhibit Setup	8:00 am - 5:00 pm
Monday, July 9	Exhibits Open	7:30 am - 6:00 pm
Monday, July 9	Exhibitor Reception	4:00 pm - 6:00 pm
Tuesday, July 10	Exhibits Open	7:30 am - 5:00 pm
Wednesday, July 11	Exhibits Open	7:30 am - 3:00 pm
Wednesday, July 11	Exhibit Teardown	3:00 pm - 6:00 pm

Exhibit Hall Floor Plan

ADSA-PSA-AMPA-ASAS 07
July 8-12, 2007
Henry B Gonzales Convention Center
Hall C
San Antonio, Texas

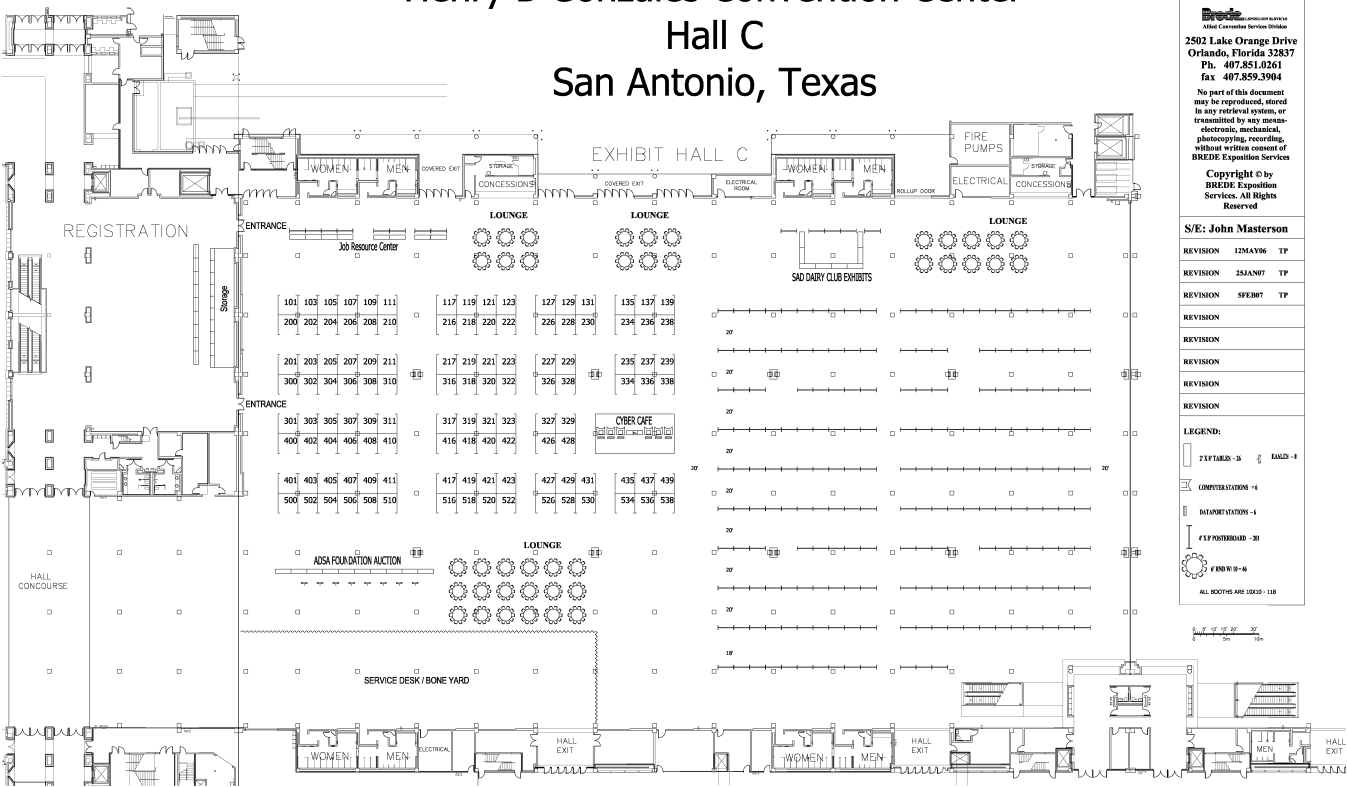

Guide to Exhibitors/Booth Numbers

2008 ADSA-ASAS Joint Meeting/Indianapolis . . .	403	Elsevier	201
AAALAC International	309	FASS (Federation of Animal Science Societies)	407, 409
Acadian AgriTech	109	Feed Management Systems	510
Adisseo	117, 119, 216, 218	FeedAC (Feed Analysis Consortium)	504
ADM Alliance Nutrition	208	Feedstuffs	121
ADSA (American Dairy Science Association) . . .	402	GrowSafe Systems	230
Ag Processing	518	GTC Nutrition	103
Agri-Nutrients Technology Group	206	H.J. Baker & Bro.	223
Albion Advanced Nutrition	326	IceRobotics	236, 238
Alltech	435, 437, 439, 534, 536, 538	ICFIE (International Center Food Industry Excellence)	419
Aloka Ultrasound	334	IIC (International Ingredient Corporation)	500
Alternative Design Mfg.	235	ILSI (International Life Sciences Institute)	220
AMPA (Asociación Mexicana de Producción Animal)	408	Lallemand Animal Nutrition	131
Analab	318	MSC Specialty Nutrition	322
Ankom Technology	417, 516	National Institute for Animal Agriculture	306
APC	111	Novus International	229, 328
Arm & Hammer Animal Nutrition	526, 528	Omega Protein	307
ARPAS (American Registry of Professional Animal Scientists)	502	PetAg	300
ASAS (American Society of Animal Science) . . .	404	Pfizer Animal Health	427
ASAS Centennial 2008	411	Poultry Protein & Fat Council	210
ASAS <i>Journal of Animal Science</i>	405	Prentice Hall	107
Balchem Corporation	311, 410	Prince Agri Products	317, 416
Bar Diamond	137	Pro-Biotech International	139
Biomim America	421, 423, 520, 522	PSA (Poultry Science Association)	406
Blackwell Publishing	101	Quality Technology International	327
Brilliant Alternatives	135	Remote Animal Monitoring Solutions	234
CABI (Commonwealth Agricultural Bureaux International)	329	Renewable Fuels Association	205
CAST (Council for Agricultural Science & Technology)	203	Ross University School of Veterinary Medicine . .	304
Chr. Hansen	217, 219	S.A.E. Afikim	530
Classic Ultrasound Equipment	207	Saf-Agri/Lesaffre Feed Additives	302
Cumberland Valley Analytical Services	105	Soy Best	301, 400
Dairy Records Management Systems	401	Soybean Meal INFOcenter	303
Dalex Livestock Solutions	227	SoyPLUS, SoyChlor (West Central)	200
DASCOR	305	Trouw Nutrition USA	123, 222
Degussa Corporation	237, 239	Unity Scientific	431
DHHS-FDA-CVM	426	USDA-Agricultural Research Service	508
Diamond V	209, 211, 308, 310	USDA-Animal Welfare Information Center	506
Distillers Grain Technology Council	429	Varied Industries Corporation	336, 338
DSM Nutritional Products	316	Western Yeast Company	428
Elanco Animal Health	202, 204	Zinpro	321, 323, 420, 422

**A special thank you to our
2007 ADSA-PSA-AMPA-ASAS
Joint Annual Meeting Exhibitors!**

Wireless Gas Production Measurement



Introducing...
ANKOM^{RF}
GAS PRODUCTION SYSTEM

- Easily measure kinetics of microbial metabolism
- Continuous computer control of each module
- Modular and Expandable (up to 50 modules)
- High Sensitivity Pressure Measurement
- Remotely controlled pressure release
- Data interface with Excel[®] for graphing
- Gas sampling capability

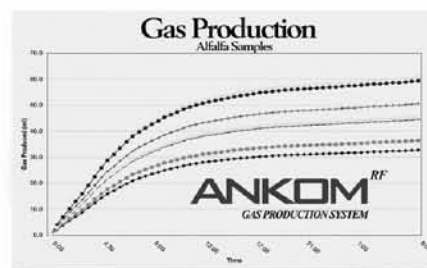

**Easy Data Conversion to
Gas Production Curves**



Low Cost Starter Kit

**RF Data Collection
up to 100'**

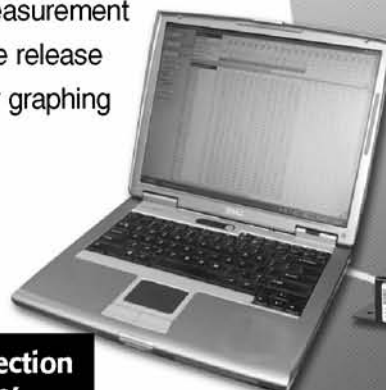

**2- Way
RF Communication**

See it in action at booth: 417 / 516

For more info:

Visit: www.ANKOM.com

Email: gaspro2@ankom.com

ANKOM Technology
2052 O'Neil Road
Macedon, NY 14502

315.986.8090 phone

315.986.8091 fax

Exhibit Directory

2008 ADSA-ASAS Joint Annual Meeting
July 7–11, Indianapolis, IN
www.adsa.org; www.asas.org
Booth(s): 403

Discover the fun that awaits you in Indy during the 2008 Joint Annual Meeting. A representative from the city of Indianapolis will be on hand to give you the inside scoop. Don't wait until the last minute—start planning next year's trip now!

AAALAC International
5283 Corporate Drive, Suite 203
Frederick, MD 21703
Phone: 301-696-9626; fax: 301-696-9627
www.aaalac.org
Booth(s): 309

AAALAC International offers accreditation, assessment and education services for agricultural animal research programs. Earning accreditation demonstrates dedication to responsible animal care, and assures research partners, funding sources, and the public of a commitment to quality research and good science. More than 700 institutions in 29 countries have earned AAALAC accreditation.

Acadian AgriTech
30 Brown Avenue
Dartmouth, Nova Scotia, B3B 1X8, Canada
Phone: 902-468-2840; fax: 902-468-3474
www.tasco.ca
Booth(s): 109

Tasco is a natural feed ingredient made of proprietary processed *Ascophyllum nodosum*. Tasco is generally regarded as safe (GRAS) in animal feeds and it is legal to feed in all classes of livestock. Over 15 years of research shows that feeding Tasco to livestock can improve production and producer profitability.

Adisseo
One Point Royal
4400 North Point Parkway, Ste. 275
Alpharetta, GA 30022
Phone: 678-339-1500; fax: 678-339-1600
www.Adisseo.com
Booth(s): 117, 119, 216, 218

Adisseo offers a wide range of feed additives in various forms, adapted for all types of feed and for all species. Our products include Microvit (full line of vitamins), Rhodimet (methionine in both powder and liquid analog forms), MetaSmart and Smartamine (ruminant methionine), and Robabio (enzymes in both liquid and powder forms).

ADM Alliance Nutrition
1000 North 30th
Quincy, IL 62301
Phone: 800-775-3295; fax: 217-222-9278
www.admani.com
Booth(s): 208

ADM Alliance Nutrition, a wholly owned subsidiary of the global Archer Daniels Midland Company (ADM), is a provider of custom blending services and natural-source ingredients. ADM is recognized as an industry leader in the research, development, and manufacturing of innovative products and providing solution-based ingredients. ADM Alliance Nutrition is your source for feed ingredient solutions.

ADSA (American Dairy Science Association)
1111 N. Dunlap Ave.
Savoy, IL 61874
Phone: 217-356-5146; fax: 217-398-4119
www.adsa.org
Booth(s): 402

Established in 1906, ADSA is an international organization of educators, scientists, industry, and government representatives who are committed to advancing the dairy industry. All are keenly aware of the vital role the dairy sciences play in fulfilling the economic, nutritive, and health requirements of the world's population. Together, ADSA members have discovered new methods and technologies that have revolutionized the dairy industry. Please visit www.adsa.org for more information.

Ag Processing, Inc.
PO Box 2047
Omaha, NE 68103
Phone: 402-492-3309; fax: 402-496-6686
www.agp.com
Booth(s): 518

AminoPlus is a natural all soybean based ingredient used to enhance the productivity of dairy cattle. This bypass protein provides dairy producers a feed source that can help ensure superior performance and yield. Our patented technology takes advantage of palatable soy proteins to supply a high level of highly digestible essential amino acids to the small intestine without the addition of chemicals or any non-soybean components. AminoPlus appearance is that of a toasted soybean meal with a reddish-brown color and a sweet, toasted aroma. Flowability, handling, and storage characteristics of the product are excellent.

Agri-Nutrients Technology Group
23011 Air Park Drive
Petersburg, VA 23803
Phone: 804-732-6551; fax: 804-733-1368
Booth(s): 206

Agri-Nutrients Technology Group (ANTG) is a research and development and process engineering company that serves a variety of industries. ANTG develops novel life-science products encompassing granulation, encapsulation, and controlled-release technologies, manipulates physical and chemical properties of products through proprietary technologies, and designs or improves production processes. Pilot plant, laboratory, consulting, project design and review, process engineering, and patent services are available.

Albion Advanced Nutrition
101 N. Main Street
Clearfield, UT 84015
Phone: 801-773-4631; fax: 801-773-4633
www.albion-an.com
Booth(s): 326

Albion Advanced Nutrition is the pioneer in development of metal amino acid chelates, (highly absorbable chelated minerals). Albion's first patent was granted in 1965. Albion continues to provide chelated minerals with high bioavailability, the ability to avoid common nutritional interferences, and the ability to improve biological efficiency of supplemental minerals.

Alltech, Inc.
3031 Catnip Hill Pike
Nicholasville, KY 40356
Phone: 859-885-9613; fax: 859-885-6736
www.alltech.com
Booth(s): 435, 437, 439, 534, 536, 538

For more than 25 years, Alltech has been researching and providing all-natural nutritional solutions that benefit animal health, performance, and productivity. Alltech's cutting-edge brands—Yea-Sacc, Sel-Plex, Bio-Mos, MTB-100, Bioplex, and Sil-All—set a unique example of how all-natural technologies backed by dedicated research can move the industry forward. Alltech is the proud and first-ever title sponsor of the World Equestrian Games. The Alltech FEI World Equestrian Games 2010 will be held in Lexington, Kentucky, September 25-October 10, 2010. These world-class events showcase the world's most exceptional equine athletes at the zenith of their performance. For more information, visit www.alltech.com.

The natural way.

≡ **Biomin** ≡

BIOMIN Natural Growth Promoters

have proven effective in many commercial and scientific trials.

- *Better FCR in piglets than with AGPs*
Kansas State University, USA, 2007
- *Improved nutrient digestibility*
Univ. of Natural Resources and Applied Life Science, Austria 2007
- *ROI of more than 1:9*
Farmers cooperative, Bretagne, France, 2006

**New trial
results available**

BIOMIN USA Inc. 1846 Lockhill Selma, Suite 101, San Antonio, TX 78213 U.S.A.
Tel: +1 210 342 9555, Fax: +1 210 342 9575, e-Mail: office.usa@biomin.net

www.biomin.net

Aloka Ultrasound
10 Fairfield Boulevard
Wallingford, CT 06942
Phone: 203-269-5088; 800-872-5652; fax: 203-269-6075
e-mail: inquiry@aloka.com
www.aloka.com
Booth(s): 334

Aloka, the innovator in ultrasound, offers a full line of veterinary ultrasound systems. The Alpha 10 and Alpha 5 offer superb image quality for the most challenging cases. More cost-effective solutions are the SSD-3500 and SSD-4000. Our two portables, the SSD-500 and SSD-900, are reliable and rugged systems.

Alternative Design Mfg.
PO Box 6330
Siloam Springs, AR 72761
Phone: 479-524-4343; fax: 479-524-4125
www.altdesign.com
Booth(s): 235

Alternative Design Mfg. manufactures a complete line of caging systems for the research and commercial poultry industry. Super brooders, brood grow, laying hen, and artificial insemination cages are available in various sizes and configurations. ALTDESIGN produces a feed bin lid that permits feed truck drivers to open, fill, and close feed bins from inside the vehicle for convenience. The company also makes a replacement heater system for Petersime brooders.

AMPA (Asociación Mexicana de Producción Animal)
Facultad de Zootecnia, Universidad Autónoma de Chihuahua
Periférico Fco. R. Almada km. 1
Apartado Postal 4-28
Chihuahua, Chihuahua CP 31031, México
Phone: 01-614-434-0303
www.agropecstar.com/usuarios/ampa/index.htm
Booth(s): 408

AMPA aspires to be the national association in animal production that has the highest technical interaction with national and international scientists and producers. The organization's mission is to promote animal science research and education through the exchange of scientific and technical information and applications to animal agriculture, public policy, and public understanding.

Analab
18246 Waller Rd., PO Box 208
Fulton, IL 61252
Phone: 800-435-9560; fax: 815-589-4565
www.analabtest.com
Booth(s): 318

Analab Laboratory had been providing testing services since 1972. As a fully certified laboratory, Analab offers a full range of chemical, biological, and microbiological testing to the livestock and seed industries. Samples tested at Analab include animal feeds, forages, silages, grains, manure, and urine. Analab is dedicated to satisfying our clients through accurate, precise, and timely analysis.

Ankom Technology
2052 O'Neil Road
Macedon, NY 14502
Phone: 315-986-8090; fax: 315-986-8091
www.ankom.com
Booth(s): 417, 516

Ankom Technology is known for the development of filter bag technology for simplifying the determination of fiber and fat content in feeds and foods. Ankom will highlight the new radio frequency gas production system during the joint meeting. This system provides an easy method to monitor and record gas production during fermentation.

APC, Inc.
2425 SE Oak Tree Court
Ankeny, IA 50021
Phone: 515-289-7600; fax: 515-289-4360
www.functionalproteins.com
Booth(s): 111

APC Inc. is a world leader in the development of functional proteins for animal health and nutrition. For 25 years, APC's research investments have yielded safe and effective products to improve animal performance in the swine, ruminant, aquaculture, companion animal, and poultry industries.

Arm & Hammer Animal Nutrition
469 North Harrison St.
Princeton, NJ 08543
Phone: 800-526-3563; fax: 609-497-7176
www.ahdairy.com
Booth(s): 526, 528

Arm & Hammer Animal Nutrition is a leading supplier of innovative dairy feed ingredients that affect each phase of a cow's life cycle. The products in our "Portfolio for Profitability" have been specially formulated to give you more profit per cow. Trust Arm & Hammer Animal Nutrition for innovative, proven, and trusted nutritional solutions.

ARPAS (American Registry of Professional Animal Scientists)
1111 N. Dunlap Ave.
Savoy, IL 61874
Phone: 217-356-5390; fax: 217-398-4119
www.arpas.org
Booth(s): 502

ARPAS is the organization that provides certification of animal scientists through examination, continuing education, and commitment to a code of ethics. Continual improvement of individual members is catalyzed through publications (including the *Professional Animal Scientist* journal) and by providing information on educational opportunities.

ASAS (American Society of Animal Science)
1111 N. Dunlap Ave.
Savoy, IL 61874
Phone: 217-356-9050; fax: 217-398-4119
www.asas.org
Booth(s): 404

Established in 1908, ASAS is a professional organization for animal scientists designed to help members provide effective leadership through research, extension, teaching, and service for the dynamic and rapidly changing livestock and meat industries. Please visit www.asas.org for more information.

ASAS Centennial Celebration 2008
Joint Annual Meeting, July 7-11, 2008,
Indianapolis, Indiana
Phone: 217-356-9050; fax: 217-398-4119
<http://www.asas.org/100years/>
Booth(s): 411

100 years of service through Animal Agriculture. *Play your part in the next 100 years.*

ASAS Journal of Animal Science
1111 N. Dunlap Ave.
Savoy, IL 61874
Phone: 217-356-3182; fax: 217-398-4119
jas.fass.org
Booth(s): 405

The *Journal of Animal Science* (JAS) is the premier journal for animal science and serves as the leading source of new knowledge and perspective in this area. JAS publishes more than 400 peer-reviewed research articles, invited reviews, technical notes, and letters to the editor each year. According to the Institute for Scientific Information (ISI), JAS consistently ranks as one of the top journals (among 43 titles) in the category of Agriculture, Dairy, and Animal Sciences in terms of impact factor, immediacy index, and cited half-life and is in the top 1% of STM publishing (50,000+ titles) by total ISI citations.

Advancing Nutrition for Healthy Animals for 150 Years

The year was 1858. While the animal nutrition products industry was not then our core business, it was still the beginning for Prince Agri Products.

With advances in the science of animal nutrition, we entered the nutrition business with a few mineral products. Today, we offer one of the largest selections of basic animal nutrition

ingredients and a growing line of specialty nutrition products. And, we're just getting started.

Other things have grown too, like long term business partnerships and strong customer service relationships throughout the animal industry we have so proudly served for 150 years.

15TH ANNIVERSARY

1858

2008



PRINCE AGRI PRODUCTS, INC.

Advancing Nutrition for Healthy Animals™

MS010507

Balchem Corporation
52 Sunrise Park Road
PO Box 600
New Hampton, NY 10958
Phone: 845-326-5600; fax: 845-326-5742
www.balchem.com
Booth(s): 311, 410

Balchem's Animal Nutrition and Health Division brings the benefits of patented proprietary encapsulation and chelated trace mineral technology to the livestock, poultry, and companion animal industries. Encapsulation and chelation technologies offer "protection nutrition" to sensitive compounds. Hence, these compounds become available when and where they offer the most benefit to the animal. Thanks to quality research, product testing, and manufacturing, these technologies are available today.

Bar Diamond, Inc.
PO Box 60
Parma, ID 83660
Phone: 208-722-6761; fax: 208-722-6686
www.bardiamond.com
Booth(s): 137

Bar Diamond, Inc. provides the world with rumen cannulae and accessories. New in 2007 is a 5-inch (center diameter) rumen cannula for use when the fistula just continues to stretch.

Biomin America, Inc.
1846 Lockhill-Selma Road, Suite 101
San Antonio, TX 78213
Phone: 210-342-9555; fax: 210-342-9575
www.biomin.net
Booth(s): 421, 423, 520, 522

Biomin is a leader in healthy animal nutrition. We use state-of-the-art research and technology to produce natural feed additives that enhance productivity and unlock the performance potential of livestock the natural way. Biomin is a customer-oriented company that has a significant market share in more than 100 countries worldwide.

Blackwell Publishing
2121 State Avenue
Ames, IA 50014
Phone: 515-292-0140; fax: 515-292-3348
www.blackwellpublishing.com
Booth(s): 101

Blackwell Publishing Professional is one of the world's leading publishers in animal science, veterinary medicine, agriculture, and food science. We have a vast selection of books, manuals, and references, which cover every area.

Dietary Cation-Anion Difference AKA DCAD
FYI sufficient K is MIA & your SOS cows
need more K ASAP. To be PC forage
alone is OK but for XL TLC add DCAD Plus®
to TMR for increased DMI. With
this SOP count on healthy ROI—no BS!
TBA: volatility is AWOL. Cl⁻ & other anions
RIP and DCAD Plus is AC for heat stress
For VIP cows feed DCAD Plus 24/7/365
You'll get lots of R&R!

A tutorial on DCAD for those who speak Acronym

Here's something the rest of us can understand.

DCAD Plus® Feed Grade Potassium Carbonate provides what forage alone can't. For details, contact your ARM & HAMMER Dairy Nutrition Specialist, your nutritionist, call 1-800-526-3563 or visit www.DCADbalance.com.

DCAD plus
The Plus Forage Needs



© 2007 Church & Dwight Co., Inc. ARM & HAMMER®, the ARM & HAMMER logo and DCAD Plus® are registered trademarks of Church & Dwight Company.



**CABI (Commonwealth Agricultural
Bureaux International)**
Nosworthy Way
Wallingford, OX10 8DE, United Kingdom
Phone: +44 (0) 1491 829374; fax: +44 (0) 1491 832111
www.cabi.org
Booth(s): 329

CABI is a leading publisher of authoritative and unbiased scientific information on agriculture and the environment. Our products include the world-renowned CAB Abstracts along with other specialist databases, encyclopedic compendia, journals, and books.

CAST (Council for Agricultural Science & Technology)
4420 W. Lincoln Way
Ames, IA 50014
Phone: 515-292-2125; fax: 515-292-4512
www.cast-science.org
Booth(s): 203

CAST is a nonprofit organization composed of 37 scientific societies and many individual, student, company, nonprofit, and associate society members. CAST's Board of Directors is composed of 38 representatives of the scientific societies and individual members representing over 170,000 member scientists, and an eight-member Executive Committee. Established in 1972, the primary work of CAST is the publication of task-force reports, commentary papers, and issue papers written by scientists from many disciplines.

Chr. Hansen, Inc.
9015 W. Maple St.
Milwaukee, WI 53214
Phone: 414-607-5800; fax: 414-607-5701
www.chr-hansen.com
Booth(s): 217, 219

Chr. Hansen Animal Health & Nutrition has been ranked by dairy nutritionists as the most trusted direct-fed microbial source. As the "World's Microbial Experts," Chr. Hansen has been the leading supplier of lactic acid bacteria and other ingredients since 1874. A history rich in science, research, and quality has produced products such as Probios, Biomate, Biomax, and BioPlus.

Classic Ultrasound Equipment
19900 Mona Road, Suite 105
Tequesta, FL 33469
Phone: 800-722-6838; fax: 561-746-4212
www.classicmedical.com
Booth(s): 207

Classic Ultrasound introduces a new notebook computer-based ultrasound system. The TelaVet 1000, now with the 17-cm animal science probe, also features the new ultra-portable Palm Scan Enhanced and the self-contained Classic InSight for external ruminant imaging. Visit www.classicmedical.com for the latest information on our new portable and notebook ultrasound systems.

EAAP is the European Federation for Animal Science federating national member organisations from 40 countries in Europe and the Mediterranean area. The member organisations represent the professional interests of scientists, academics, professionals and producers, technicians, extension officers, government departments and farmer organisations.

Invitation

On behalf of the Irish Organising Committee, we are pleased to invite you to the 58th Annual Meeting of the European Association for Animal Production in Dublin from the **26th to the 29th August 2007**.

The main theme of the meeting is: "Sustainable Animal Production-Meeting the Challenges for Quality Food"

We are aware of the prominence of the EAAP meeting in the calendar of agri-food research events and will ensure that the 2007 meeting is keenly focused and topical. Our industry must continue to meet new challenges and opportunities in which we all have significant roles to play. We have planned a very extensive Conference Programme and assembled an excellent panel of Guest Speakers to examine the issues and plot a course for the future.

Ireland last hosted the EAAP Annual Meeting in 1989. Since then, many changes have taken place on Irish farms and in particular relating to animal production. We look forward to showing you the state of animal production in Ireland in 2007 and indeed have planned field excursions that we hope you will enjoy and benefit from. Ireland is known as the "Country of one hundred thousand welcomes Cead Míle Failte" and we look forward to enabling you to sample the social side of Dublin and indeed Ireland. We have planned a special programme of social events and events for accompanying persons.

We look forward to seeing you in Dublin in August 2007



Cumberland Valley Analytical Services, Inc.
14515 Industry Drive
Hagerstown, MD 21742
Phone: 301-790-1980; fax: 301-790-1981
www.foragelab.com
Booth(s): 105

Cumberland Valley Analytical Services, Inc. is a full-service forage testing laboratory that serves clients nationally and internationally. We are one of the largest providers of chemistry services including in vitro fiber digestibility, in situ evaluations, and forage fermentation analysis. We routinely perform work on research samples for universities and private companies, including plot evaluation work for hybrid evaluation.

Dairy Records Management Systems
313 Chapanoke Rd., Suite 100
Raleigh, NC 27603
Phone: 919-661-3100; fax: 919-661-3145
www.drms.org
Booth(s): 401

DRMS' PCDART software has served the nation's most intensively managed dairy farms for over 25 years. With features like timed AI, a comprehensive protocols/chores system

with treatment regimes, RFID, handheld input and review, and real-time networking, PCDART delivers well-designed solutions for herd managers and consultants. DRMS provides top-notch support by animal and dairy science graduates with on-farm experience at no additional charge.

Dalex Livestock Solutions, LLC
240 Industrial Blvd.
Waconia, MN 55387
Phone: 800-421-3834; fax: 952-442-2543
www.dalex.com
Booth(s): 227

Dalex Livestock Solutions provides ration formulation, feeding management, animal performance, and nutrient management solutions for the livestock industry. Dalex has long been synonymous with ration balancing and is the home of the "consulting nutritionist." Using the most up-to-date scientific data and models, we provide a complete solution to formulate, monitor, and assess accurate livestock feeding situations.

A Cool Fat For A Hot Cow!

Energy Booster 100® vs. Calcium Soaps
 Research shows Energy Booster 100 improves dry matter intake versus calcium soaps containing high levels of unsaturated free fatty acids. Because Energy Booster 100 contains mostly saturated free fatty acids, cows fed Energy Booster 100 consumed an average of 2.5% more dry matter for **21% MORE ENERGY**. Gains like this boost your herd performance and profitability.
 For more answers about Energy Booster 100, call **1-800-323-5424** or visit us online at **www.msc-sn.com**.

MSC Specialty Nutrition

© 2007 MSC Specialty Nutrition. ENERGY BOOSTER 100 is a registered trademark of MSC.

degussa.
creating essentials

Simply AMINO™
 – Check your specs

Make More Money with Degussa's Feed Formulation Concepts

Check your specs, contact us.

www.simplyamino.com

Degussa Feed Additives – amino acids and more. | feed.additives@degussa.com | www.aminoacidsandmore.com

North America | Degussa Corporation | 1701 Barnett Lakes Blvd., Suite 340 | Kennesaw, GA 30144, USA | Tel: +1-478-797-4310 | Fax: +1-478-797-4311

DASCOR, Inc.
PO Box 462885
Escondido, CA 92046
Phone: 760-796-7788; fax: 760-796-7785
www.dascor.com
Booth(s): 305

DASCOR specializes in the design, development, and production of custom instrumentation and control products for OEM and private-label clients as well as marketing a proprietary line of data loggers, signal conditioners, and related products. Working closely with Sensorex as a distributor of their pH and ORP sensors, and with eminent researchers with the University of Alberta and Lethbridge Research Centre, DASCOR has developed an autonomous datalogger for monitoring rumen pH, ORP, and temperature for extended periods in cannulated cattle. Systems in development will include provisions for additional sensors (such as pressure or motion), true wireless communication, extended memory, and reduced size for esophageal insertion. On-going field investigations are also leading to a custom pH sensor designed specifically for long-term survivability in the rumen. Please visit DASCOR at booth 305.

Degussa Corporation
1701 Barrett Lakes Blvd., Suite 340
Kennesaw, GA 30144
Phone: 678-797-4311; fax: 678-797-4313
www.aminoacidsandmore.com
www.makemilknotmanure.com
Booth(s): 237, 239

Degussa is the only company in the world to supply, from a single source, all four of the important amino acids for animal nutrition: DL-methionine, L-lysine (Biolys), L-threonine, and L-tryptophan. Mepron, a rumen-protected DL-methionine, rounds off the company's product range as part of its "one-source" strategy.

DHHS-FDA-CVM
7519 Standish Place, Suite #3508
Rockville, MD 20855
Phone: 240-276-9301; fax: 240-276-9115
www.fda.gov/cvm
Booth(s): 426

The US Food and Drug Administration, Center for Veterinary Medicine is a public health consumer protection organization. We foster public and animal health by approving safe and effective drugs, devices, and food additives given to over one hundred million companion animals, and millions of poultry, cattle, swine, and minor animal species.

Diamond V
838 1st St. NW
Cedar Rapids, IA 52407
Phone: 319-366-0745; fax: 319-366-6333
www.diamondv.com
Booth(s): 209, 211, 308, 310

Diamond V is the world's leading manufacturer of fermented yeast culture products. For over 60 years, we have provided customers with YC, XP, XPC Concentrate, and XP DFM (a direct-fed microbial blend for ruminants). SelenoSource AF is our premier organic selenium yeast. We now introduce DV Aqua, our premier yeast culture designed and manufactured specifically for aquaculture.

Distillers Grains Technology Council (DGTC)
University of Louisville
435 Lutz Hall
Louisville, KY 40292
Phone: 800-759-3448; fax: 502-852-1577
www.distillersgrains.org
Booth(s): 429

DGTC is a non-profit association that has been in existence since 1945. At the DGTC booth, we will have information on feeding wet and dry distillers grains to dairy and beef cattle, calves, sheep, goats, and horses as well as information on combining it with other feed ingredients to reduce corn usage and costs.

DSM Nutritional Products
45 Waterview Blvd.
Parsippany, NJ 07054
Phone: 800-677-6243; fax: 971-257-8653
www.nutraaccess.com
Booth(s): 316

DSM Nutritional Products is the global leader in micro-ingredients solutions. DSM Nutritional Products is proud to offer the most comprehensive line of vitamins available in the marketplace, along with enzymes and direct-fed microbi-als. With our network of 34 premix plants globally, DSM Nutritional Products can deliver customized nutrition solutions anywhere in the world.

Elanco Animal Health
2001 West Main Street, PO Box 708
Greenfield, IN 46140
Phone: 317-276-4124; fax: 317-276-4471
www.elanco.com
Booth(s): 202, 204

Elanco is a global research-based company that develops and markets products to improve the health and production of animals in more than 100 countries. Elanco is a division of Eli Lilly and Company, a leading innovation-driven pharmaceutical corporation. Elanco products enhance animal health, wellness, welfare, and performance to help the food industry produce an abundant supply of safe and affordable food.

Elsevier
1600 John F. Kennedy Blvd., Suite 1800
Philadelphia, PA 19103
Phone: 215-239-3491; fax: 215-239-3494
www.elsevierhealth.com
Booth(s): 201

Elsevier is the leading publisher in veterinary medicine and animal science, and publishes journals such as *Livestock Science*, *Applied Animal Behaviour Science*, and *Animal Feed Science and Technology*. Visit our exhibit booth for sample copies and more information on these and our other journals.

FASS (Federation of Animal Science Societies)
1111 N. Dunlap Ave.
Savoy, IL 61874
Phone: 217-356-3182; fax: 217-398-4119
www.fass.org
Booth(s): 407, 409

FASS was formed on January 1, 1998, by mutual consent and for the mutual benefit of three founding member societies: the American Dairy Science Association (ADSA), the American Society of Animal Science (ASAS), and the Poultry Science Association (PSA). Currently, FASS provides services to more than 10,000 professionals from animal agriculture. The Congressional Science Fellowship Program was established by FASFAS in 1990 and continued by FASS. Each year, PhD scientists in animal science compete for the opportunity to represent FASS in Congress. Many of these individuals stay on the Washington scene after their fellowship year and continue to serve animal agriculture in significant ways.

Feed Management Systems
6120 Earle Brown Drive, Suite #300
Brooklyn Center, MN 55430
Phone: 763-560-8139; fax: 763-560-8160
www.feedsys.com
Booth(s): 510

Feed Management Systems is the leading software solutions provider linking critical information for feed manufacturers with our Feed Mill Manager, Brill Formulation, Feed Ration Balancer, and Feed Tags software. Ensure the safety, quality, and affordability of your feed supply by automating and optimizing formulas, pricing, ordering, labeling, delivery, and compliance.

FeedAC (Feed Analysis Consortium)
1111 N. Dunlap Ave.
Savoy, IL 61874
Phone: 217-356-3182, x28; fax: 217-398-4119
FeedAC@assoqh.org
Booth(s): 504

The Feed Analysis Consortium, Inc. (FeedAC) is a membership-based nonprofit organization dedicated to the advancement of feed analysis and nutritional modeling. The mission of FeedAC is to serve the animal feed industry by building and maintaining a Feed Information System for all farm animals, developing improved methods of feed analysis, and encouraging the development of improved diet formulation and evaluation models. FeedAC replaces the previously established Ruminant Feed Analysis Consortium (RFAC). Please visit www.feedac.org for membership information.



TRYING TO HIT AN
ESSENTIAL AMINO
ACID REQUIREMENT
WITH CRUDE PROTEIN?

Poultry have essential digestible amino acid requirements and not a crude protein requirement.

Properly formulating on individual digestible amino acids eliminates the need for a minimum constraint on crude protein.

Reducing excess crude protein lowers cost and promotes consistent performance.

Want to learn more? For additional information on digestible amino acids and formulating your poultry feeds on an ideal amino acid ratio basis call:

AJINOMOTO HEARTLAND LLC
www.lysine.com | 773.380.7000
 ISO 9001:2000
 ISO 14001:2004



Feedstuffs
12400 Whitewater Dr., Suite #160
Minnetonka, MN 55343
Phone: 952-931-0211; fax: 952-938-1832
www.feedstuffs.com
Booth(s): 121

Feedstuffs is the only weekly paid news source for agribusiness. Every week, we keep our subscribers informed on the important issues affecting the business of producing food for the world.

GrowSafe Systems, Ltd.
280105 Range Road 22, RR#1, Site #1, Box 19
Airdrie, Alberta, T4B 2A3, Canada
Phone: 403-912-1879; fax: 403-398-1327
Booth(s): 230

GrowSafe technology continuously measures individual animal feed intake, weight, and feeding behavior in research and commercial environments. This year we began piloting new "in-pen" technology to manage feedlot cattle. We will release preliminary results during the 2007 ADSA-PSA-AMPA-ASAS Joint Annual Meeting in San Antonio. Visit us at Booth 230 to receive an invitation to this presentation.

GTC Nutrition
600 Corporate Circle, Suite H
Golden, CO 80401
Phone: 303-216-2489; fax: 303-216-2477
www.gtcnutrition.com
Booth(s): 103

GTC Nutrition is a recognized leader in providing innovative, science-based ingredient solutions for the pet food and animal feed industries. The company's flagship animal ingredient, FortiFeed short-chain fructooligosaccharides (scFOS) prebiotic fiber, offers numerous health and functional benefits. For more information, call 800-522-4682 or visit www.fortifeed.com.

Our Scientists Monitor OREGANO QUALITY At The Source And EVERY STEP Along The Way.

Regano®
A SOURCE YOU CAN TRUST.™

How do you tell the real thing from the copycats? Our 100% natural Regano™ grows in a 7,000-acre production system—the only organized production system of its kind—where the pure extract of oregano is closely scrutinized from planting through steamed distillation.

Along the way, we assay and select for key aromatic hydrocarbons Carvacrol (80% to 84%) and Thymol (1% to 4%). The result is a pure, consistent, standardized product which, as verified by university research, produces consistent results.



Ralco Nutrition
800 533 5306
www.ralco nutrition.com

THE SCIENCE OF ANIMAL NUTRITION

Creating Opportunities, Adding Value to Dairy



The California Dairy Research Foundation promotes
research and development activities benefiting
California's dairy producers, processors and consumers.



Dr. Joseph O'Donnell
Executive Director
Davis, CA
(530) 753-0681 • info@cdrf.org
www.CDRF.org

Sponsoring member of the
International Milk Genomics Consortium
www.milkgenomics.org • www.imgconsortium.org

Sponsored sites: www.cdqa.org • www.ediblefilms.org
www.healthywhey.org • www.usprobiotics.org
www.dairyfoodsafety.com



H.J. Baker & Bro., Inc.
 228 Saugatuck Ave.
 Westport, CT 06880
 Phone: 203-682-9200; fax: 203-227-8351
www.bakerbro.com
 Booth(s): 223

PRO-LAK, from H.J. Baker & Bro, Inc., is a multi-source marine and animal by-pass protein designed to complement the protein from rumen microbial activity and is specially formulated for today's high-producing dairy cow. The desired nutrient balance is accomplished by 72% of the protein bypassing rumen degradation and delivering the essential amino acid profile to support maximum milk production. Research has been conducted to evaluate milk production, digestibility, and feed efficiency of PRO-LAK and can be found on our website (www.bakerbro.com).

IceRobotics
 Logan Building
 Roslin BioCentre
 Roslin, Midlothian, EH25 9TT, Scotland
 Phone: +44 (0)131 527 4380; fax: +44 (0)131 527 4381
www.icerobotics.co.uk
 Booth(s): 236, 238

IceRobotics develops and manufactures the IceTag and IceSampler devices for use in livestock research. The IceTag activity monitor enables second-by-second recording of animal activity, recording both step count and lying time. The IceSampler blood-sampling device enables automated collection of blood samples from cattle.

ILSI (International Life Sciences Institute)
 One Thomas Circle NW, 9th floor
 Washington, DC 20005
 Phone: 202-659-0074; fax: 202-659-3859
www.ils.org
 Booth(s): 220

The ILSI International Food Biotechnology Committee (IFBiC) supports the worldwide development and harmonization of science-based regulations and safety assessment of biotechnology-derived food and feed products, including best practices for animal nutrition studies. IFBiC provides access to critical, up-to-date scientific information to key public and private stakeholders.

ICFIE (International Center for Food Industry Excellence)
 Texas Tech University, Box 42141
 Lubbock, TX 79409-2141
 Phone: 806-742-2805, x283; fax: 806-742-4003
www.orgs.ttu.edu/icfie
 Booth(s): 419

Texas Tech University's International Center for Food Industry Excellence (ICFIE) provides systematic development and evaluation of food products from farm to table and addresses consumers' food safety concerns. ICFIE provides expertise in beef, cattle, nutrition, food safety, and meat and poultry processing. For information, visit us at www.orgs.ttu.edu/icfie.

NEW DATA! PRO-LAK IMPROVES FEED EFFICIENCY!



- University Research shows Pro-Lak improves Feed Efficiency by an average of 8.05%.
- **Dr. Mike Hutjens**, University of Illinois states "A move from 1.5 to 1.6 (0.1 change in FE) equals \$.20 / cow / day"
- What would 8.05% improvement in Feed Efficiency save you in feed costs?

*Call your feed supplier, nutritionist
 or H.J. Baker today!*

For more information:

H.J. Baker & Bro., Inc • 228 Saugatuck Avenue, Westport, CT 06880 USA
 Phone (203) 682-9200, Telex ITT 42-0944, Fax (203) 227-8351
 Email: salesinfo@bakerbro.com • Website: <http://www.bakerbro.com>

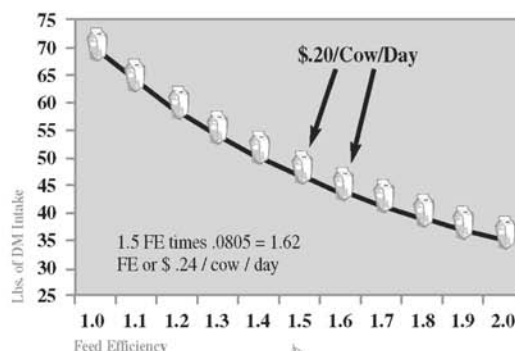

H.J. BAKER & BRO., INC.
 Quality Products Since 1850
 Our Difference is Dependability

Kevin Maloney, Western Regional Sales 707-753-1039
Ed Gilman, Central Regional Sales 417-725-1961
Dan Wright, National Sales 770-458-7658

International Ingredient Corporation
150 Larkin Williams Ind. Ct.
Fenton, MO 63026
Phone: 636-343-4111; fax: 636-349-4845
www.iicag.com
Booth(s): 500

International Ingredient Corporation (IIC) is a manufacturer of high-quality ingredients for the feed, pet food, and aquaculture industry. IIC has nine plant locations and a dedicated staff to meet your quality standards and expectations.

Lallemand Animal Nutrition
6120 W. Douglas Ave.
Milwaukee, WI 53218
Phone: 414-464-6440; fax: 414-464-6430
www.lallemand.com
Booth(s): 131

Lallemand Animal Nutrition is the only major supplier of yeast and bacteria that is a primary producer of both. Core products for dairy cattle are Levucell SC and SB (probiotic active dry yeasts), Alkosel mineral-enriched yeast, Agrimos (a manno-oligosaccharide), and Biotol forage inoculants. For more information, visit www.qualitysilage.com.

MSC Specialty Nutrition
PO Box 278, Illinois & Water St.
Dundee, IL 60118
Phone: 847-426-3411; fax: 847-426-3636
www.msccompany.com
Booth(s): 322

MSC Specialty Nutrition is a leading, research-driven supplier of nutrition and health products designed to optimize animal performance. Major brands for dairy producers include Excelerate and KwikMix (calf milk replacers) and Energy Booster 100 (rumen inert-fat). MSC Specialty Nutrition serves both national and international customers. For more information, visit www.msspecialtynutrition.com or call 1-800-343-4274.

National Institute for Animal Agriculture (NIAA)
1910 Lyda Ave.
Bowling Green, KY 42104
Phone: 270-782-9798; fax: 270-782-0188
www.animalagriculture.org
Booth(s): 306

The NIAA is a forum for building consensus and advancing solutions for animal agriculture and for providing continuing education and communications linkages to animal agriculture professionals. Our mission truly reflects NIAA—where it's been, where it is, and where it's going. NIAA is the only forum where producers/owners (cattle, equine, poultry, small ruminants, and swine), scientists (corporate, academic, and government), veterinarians (private practice, industrial, and government), regulators (state and federal), and business executives (corporate and association) meet in a common effort to deal with shared issues and opportunities. Visit our web site at www.animalagriculture.org.

Novus International, Inc.
530 Maryville Centre Drive
St. Louis, MO 63141
Phone: 314-576-8441; fax: 314-576-4635
www.novusint.com
Booth(s): 229, 328

Novus International is a global leader in the animal health and nutrition industries. Through a worldwide network, Novus markets more than 60 products in six key categories: amino acids, nutrition and health, minerals, energy metabolism, specialty products, and feed quality. Brand names include Alimet, Mintrex, Agrado, Activate, Cryspan, and Zorien.

Omega Protein, Inc.
2101 CityWest Blvd., Bldg. 3, Suite 500
Houston, TX 77042
Phone: 800-345-8805, fax: 713-940-6169
www.omegaproteininc.com
Booth(s): 307

Omega Protein is the nation's largest producer of omega-3 fish oil, protein-rich fishmeal, and fish solubles. The company markets a variety of products derived from menhaden, an inedible fish found in abundant quantities in coastal waters off the US mid-Atlantic and Gulf coasts.

PetAg, Inc.
255 Keyes Ave.
Hampshire, IL 60140
Phone: 847-683-2288; fax: 847-683-2343
www.petag.com
Booth(s): 300

Fermacto is an aspergillus mycelium product for monogastrics. It has been shown in poultry to demonstrate increased maturity levels of the gastrointestinal tract of the immature bird. During the first three weeks, the gastrointestinal tract matures both microbiologically as well as physically, including villi length, short-chain fatty acid concentrations, and motility to maximize uniformity in flock development. Of critical importance is the increase in lactocin-producing lactobacilli, which tend to reduce the foci of pathogen development. Please stop by and meet us.

Pfizer Animal Health
150 East 42nd Street
New York, NY 10017
Phone: 800-733-5500
www.pfizerah.com
Booth(s): 427

For farm animals such as cattle and swine, Pfizer Animal Health offers the broadest line of products in the world to improve their health and quality of life. We are also pleased to provide outstanding technical support and service throughout the United States to help beef, dairy, and pork producers (and their veterinarians) improve the safety, quality, and productivity of their livestock by taking full advantage of Pfizer Animal Health products. Because our goal is to do more than any other company to further animal health, we are the worldwide leaders in animal health research.

Poultry Protein & Fat Council
1530 Cooledge Road
Tucker, GA 30084
Phone: 770-493-9401; fax: 770-493-9257
www.poultryegg.org
Booth(s): 210

The Poultry Protein & Fat Council is a consortium of 13 member companies that produce high-quality poultry meal, feather meal, and poultry fat. Request our free video or CD at www.poultryegg.org.

Prentice Hall
One Lake Street
Upper Saddle River, NJ 07458
Phone: 201-236-5889; fax: 201-236-5888
www.prenhall.com
Booth(s): 107

Prentice Hall is proud to be the leading provider of educational products for your agriculture courses. Please stop by our booth or visit our website at www.prenhall.com to see what is new and to see what we have planned.

Prince Agri Products
PO Box 1009
Quincy, IL 62306
Phone: 217-222-8854; fax: 217-222-5098
www.princeagri.com
Booth(s): 317, 416

A global provider of proven and science-based ingredients for the animal feed industry, Prince Agri Products has long been successful by helping customers meet their goals through product solutions and innovation, the highest standards for quality and credibility, and with unmatched customer service and dedication. Put the Prince team to work for you by calling 217-222-8854.

Probiotech International, Inc.
6225 Choquette Street
St-Hyacinthe, Quebec, J2S 8L2, Canada
Phone: 450-771-7252; fax: 450-771-4509
www.probiotech.com
Booth(s): 139

Probiotech International, Inc. develops and provides the animal nutrition industry with natural solutions. Our line of products was designed using the principles of biotechnology to promote animal health and maximize agriculture production with the respect of our environment in mind. Products range from patented rumen-protected choline for dairy cows to organic acidifiers for swine and poultry.

PSA (Poultry Science Association)
1111 N. Dunlap Ave.
Savoy, IL 61874
Phone: 217-356-5285; fax: 217-398-4119
www.poultryscience.org
Booth(s): 406

PSA is a professional organization consisting of approximately 3,500 educators, scientists, extension specialists, administrators, and producers committed to advancing the poultry industry. The association is dedicated to discovery and dissemination of knowledge generated by poultry research that enhances human and animal health and well-being and provides for the ethical and sustainable production of food. Since 1908, the PSA has maintained a level of prestige that ranks it among the top professional organizations in the field. Please visit www.poultryscience.org for more information.

Quality Technology International, Inc.
2250 Point Blvd., Suite #322
Elgin, IL 60123
Phone: 217-847-9300
www.qtitech.com
Booth(s): 327

Quality Technology International (QTI) specializes in innovative technologies and solutions for the agricultural marketplace. It is a leader in ethanol co-products, identity preserved grains, and animal health. QTI markets and distributes Calsporin, the world's leading *Bacillus*-based direct-fed microbial for the poultry industry.

Remote Animal Monitoring Solutions, LLC (RAMS)
Box 1361
Starkville, MS 39760-1361
Phone: 662-312-1795; fax: 662-323-3293
www.rams-online.com
Booth(s): 234

RAMS strives to provide exceptional service to our clientele through advanced imaging capabilities and is working to become a recognized leader in the marketing and development of unique sampling and monitoring devices for both research and field-based large animal applications.

Renewable Fuels Association
One Massachusetts Ave., NW, Suite 820
Washington, DC 20001
Phone: 202-289-3835; fax: 202-289-7519
www.ethanolrfa.org
Booth(s): 205

As the national trade association for the US ethanol industry, the Renewable Fuels Association (RFA) promotes policies, regulations, and research and development initiatives that will lead to the increased production and use of fuel ethanol. RFA membership includes a broad cross-section of businesses, individuals, and organizations dedicated to the expansion of the US fuel ethanol industry.

Ross University
School of Veterinary Medicine
499 Thornall St., 10th floor
Edison, NJ 08837
Phone: 877-ROSS-EDU; fax: 732-978-5304
www.rossu.edu
Booth(s): 304

Ross University offers doctor of medicine and doctor of veterinary medicine degree programs. Ross University School of Medicine was founded in 1978 and is located in the Caribbean country of Dominica. Ross University School of Veterinary Medicine was founded in 1982 and is located on the Caribbean island of St. Kitts.

S.A.E. Afikim
Kibbutz Afikim
Jordan Valley 15148
Israel
Phone: 972-4-6754812; fax: 972-4-6751862
www.afimilk.com
Booth(s): 530

S.A.E. Afikim was founded in the early 1970s and was a pioneer in introducing electronics into the milking parlor. Since then, S.A.E. Afikim has been committed to develop, manufacture, and market computerized dairy management systems. The Afimilk brand name consists of milk meters, individual cow identification, pedometers, and management and analysis software.

Saf Agri/Lesaffre Feed Additives
7475 W. Main St.
Milwaukee, WI 53214
Phone: 414-615-4138; fax: 414-615-4003
www.saf-agri.com
Booth(s): 302

Saf Agri provides innovative products produced by the Lesaffre Group, the world's oldest and largest yeast manufacturer, to livestock feed producers and pet food manufacturers throughout the Americas. The product line includes active dry yeast for pelleted and nonpelleted feeds, inactive dry yeast, mineral yeast (Se, Cr, Mn, Zn), enzymes, and mannan oligosaccharides.

Soy Best
PO Box 157
West Point, NE 68788
Phone: 402-372-2429; fax: 402-372-3305
www.soybest.com
Booth(s): 301, 400

Soy Best High Bypass Soybean Meal is bypass protein for dairy cows. Manufactured by a mechanical process, it contains no chemical solvents and is all natural. Soy Best now includes fresh soy gums with lecithin and phosphatidylcholine. Research shows these nutrients behave like rumen-protected fat, resulting in even more bypass protein with excellent intestinal digestibility.

Soybean Meal INFOcenter
4554 NW 114th St.
Urbandale, IA 50322-5410
Phone: 515-251-8640; fax: 515-251-8657
www.soymeal.org
Booth(s): 303

Soybean Meal INFOcenter provides technical information on soybean meal to the feed manufacturer, professional nutritionist, feed formulator, livestock and poultry producer, and the public. Its website (www.soymeal.org), fact sheets, and bimonthly newsletters highlight new information on this important supplemental protein for livestock, poultry, aquaculture, and companion animals.

SoyPLUS/SoyChlor (West Central)
406 First Street, PO Box 68
Ralston, IA 51459
Phone: 712-667-3200; fax: 712-667-3215
www.soyplus.com; www.soychlor.com
Booth(s): 200

For decades, SoyPLUS and SoyChlor have stood as the gold standards of dairy feed ingredients. SoyPLUS is a bypass industry leader, consistently delivering dairy bypass protein and demonstrating unbeatable protein quality and intestinal digestibility. SoyPLUS contains research-proven higher energy and rumen-inert fat than its competition. SoyChlor has proven itself as a valuable tool in efficiently and effectively balancing DCAD in herd health. SoyChlor's key ingredient, hydrochloric acid, is the most palatable source of chloride available. SoyChlor offers dairy cows low 19% protein, low potassium and sodium, low phosphorus, beneficial amounts of calcium and magnesium, and consistent flowability.

Trouw Nutrition USA
115 Executive Dr.
Highland, IL 62249
Phone: 618-654-2070; fax: 618-654-6700
www.trouwnutritionusa.com
Booth(s): 123, 222

Trouw Nutrition USA offers innovative nutrition solutions, specialty products, and premixes for the livestock, poultry, and pet food industries, including Optimin Chelated Minerals, Protimax Specialized Egg Globulin, ^{TNI}betain, Selko Mold Inhibitors/Preservatives, and NovaSil Plus. Trouw offers custom blending and manufacturing of premixes, trace mineral packs, vitamin packs, supplements, and customer formula products.

Unity Scientific, Inc.
PO Box 1030
Purcellville, VA 20134
Phone: 540-338-8991; fax: 540-338-8992
www.unityscientific.com
Booth(s): 431

Unity Scientific manufactures and sells a complete line of cost-effective, network-ready NIR (near infrared) and NIT analyzers for a wide variety of laboratory at-line and process applications. Unity offers a wide range of applications for the food, feed, pet food, dairy, tobacco, pharmaceutical, and general industrial markets. Unity also offers a complete line of sample preparation equipment that includes auto distillation, solvent extraction, and block digestion.

USDA - Agricultural Research Service (ARS)
5601 Sunnyside Ave.
Beltsville, MD 20705-5144
Phone: 301-504-3271; fax: 301-504-1740
www.ars.usda.gov
Booth(s): 508

ARS is the principal in-house research agency of USDA responsible for solving problems of national importance related to food agriculture. ARS employs about 8,000 people at more than 100 research facilities strategically located in major farm and rangeland ecosystems throughout the US and in several foreign countries.

USDA - Animal Welfare Information Center
10301 Baltimore Ave, Room 410
Beltsville, MD 20705
Phone: 301-504-6212; fax: 301-504-7125
awic.nal.usda.gov
Booth(s): 506

The Animal Welfare Information Center (AWIC) teaches a one-and-a-half-day workshop at the National Agricultural Library in Beltsville, Maryland, for individuals who are responsible for providing information to meet the requirements of the Animal Welfare Act (AWA).

BMD[®] improves farrowing performance and economic return.

Increased weaning weights.
More pigs weaned per litter.
BMD takes control.

BMD, fed at 250 grams/ton of feed two weeks before farrowing through lactation, has proven effective in heading off *Clostridium perfringens*. It also improves pig weaning weight, increases weaned pigs per litter, and allows less sow weight loss.¹

Contact your Alpharma Animal Health representative for additional details on how BMD can benefit your bottom line.

BMD[®]

¹ Wolff, T. 2005. An overview of research on bacitracin methylene disalicylate (BMD) in sow diets. AASV Proceedings, 101-105.

 **ALPHARMA.**
Animal Health

Alpharma Inc. 440 Route 22, Bridgewater, NJ 08807
BMD[®] is a registered trademark of Alpharma, Inc.

www.alpharma.com

Varied Industries Corporation
905 S. Carolina Ave., PO Box 1483
Mason City, IA 50401
Phone: 641-423-1460; fax: 641-423-0832
www.vi-cor.com
Booth(s): 336, 338

In 1974, a patent was issued to a small company in Mason City, Iowa, for a fermentation process for animal feeds. This process became the foundation technology upon which Varied Industries Corporation (Vi-COR) was founded. Vi-COR has expanded to a company with a global focus, a manufacturer of world-class fermentation products providing custom manufacturing services.

Western Yeast Company
305 W. Ash St.
Chillicothe, IL 61523
Phone: 309-274-3160; fax: 309-274-5393
www.westernyeast.com
Booth(s): 428

Western Yeast Company was founded in 1932 and uses the Newhaven process for making yeast culture. Western Yeast Culture is an active, all-natural feed supplement designed to improve animal nutrition. It consists of live yeast cells plus the media on which they were grown, carefully dried to maintain the fermentation activity of the cells.

Zinpro
10400 Vicking Drive, Suite 240
Eden Prairie, MN 55344
Phone: 800-445-6145; fax: 952-944-2749
www.zinpro.com
Booth(s): 321, 323, 420, 422

Zinpro Performance Minerals, the premier source of trace minerals in the industry, deliver consistent, performance-driven results. Performance minerals must meet essential, measurable criteria based on return, response, repeatability, research, and reassurance.

EXCEDE
SINGLE DOSE



TRADITIONAL TREATMENTS
MULTIPLE DOSES

EXCEDE®. **MORE THAN BETTER SCIENCE,** **IT'S BETTER MATH.**

In a single dose, EXCEDE (ceftiofur crystalline free acid) Sterile Suspension delivers the kind of BRD therapy that used to require 3 to 5 doses.

- Powerful, sustained-release, broad-spectrum antibiotic performance
- Extended therapy in a single dose for greater compliance, fewer dosing errors
- Zero-day milk discard for 100% peace of mind
- All with simple, base of ear injection

Ask about EXCEDE. No matter how you add it up, it equals more disease treatment with less handling.

As with all drugs, the use of EXCEDE is contraindicated in animals previously found to be hypersensitive to the drug. Though safe in cattle when properly given, inadvertent intra-arterial injection in the ear is possible and is fatal. EXCEDE has a pre-slaughter withdrawal time of 13 days.



Pfizer Animal Health

EXCEDE®
(Ceftiofur Crystalline Free Acid)
Sterile Suspension

No other dose goes so far.™

EXCEDE is a registered trademark of Pharmacia and Upjohn Company LLC, a division of Pfizer Inc. No other dose goes so far is a trademark of Pfizer Inc. ©2007 Pfizer Inc. All rights reserved. EXD06157

www.excede.com 1-866-387-2287





For subcutaneous injection in the posterior aspect of the ear where it attaches to the head (base of the ear) in lactating dairy cattle. For subcutaneous injection in the middle third of the posterior aspect of the ear or in the posterior aspect of the ear where it attaches to the head (base of the ear) in beef and non-lactating dairy cattle.

CAUTION

Federal (USA) law restricts this drug to use by or on the order of a licensed veterinarian.

INDICATIONS

EXCEDE Sterile Suspension is indicated for treatment of bovine respiratory disease (BRD, shipping fever, pneumonia) associated with *Mannheimia haemolytica*, *Pasteurella multocida*, and *Histophilus somni* in beef, non-lactating dairy, and lactating dairy cattle. EXCEDE Sterile Suspension is also indicated for the control of respiratory disease in beef and non-lactating dairy cattle which are at high risk of developing BRD associated with *M. haemolytica*, *P. multocida*, and *H. somni*.

CONTRAINDICATIONS

As with all drugs, the use of EXCEDE Sterile Suspension is contraindicated in animals previously found to be hypersensitive to the drug.

WARNINGS

**FOR USE IN ANIMALS ONLY. NOT FOR HUMAN USE.
KEEP OUT OF REACH OF CHILDREN.**

Penicillins and cephalosporins can cause allergic reactions in sensitized individuals. Topical exposures to such antimicrobials, including ceftiofur, may elicit mild to severe allergic reactions in some individuals. Repeated or prolonged exposure may lead to sensitization. Avoid direct contact of the product with the skin, eyes, mouth and clothing. Sensitization of the skin may be avoided by wearing latex gloves.

Persons with a known hypersensitivity to penicillin or cephalosporins should avoid exposure to this product.

In case of accidental eye exposure, flush with water for 15 minutes. In case of accidental skin exposure, wash with soap and water. Remove contaminated clothing. If allergic reaction occurs (e.g., skin rash, hives, difficult breathing), seek medical attention.

The material safety data sheet contains more detailed occupational safety information. To obtain a material safety data sheet (MSDS) please call 1-800-733-5500. To report any adverse event please call 1-800-366-5288.

Injection of EXCEDE Sterile Suspension into the arteries of the ear is likely to result in sudden death to the animal.

RESIDUE WARNINGS

- Following label use as a single treatment, a 13-day pre-slaughter withdrawal period is required.
- Following label use as a single treatment, no milk discard period is required for this product.
- Use of dosages in excess of 6.6 mg CE/kg or administration by unapproved routes (subcutaneous injection in the neck or intramuscular injection) may cause violative residues.
- A withdrawal period has not been established for this product in pre-ruminating calves.
- Do not use in calves to be processed for veal.

PRECAUTIONS

Following subcutaneous injection in the middle third of the posterior aspect of the ear, thickening and swelling (characterized by aseptic cellular infiltrate) of the ear may occur. As with other parenteral injections, localized post-injection bacterial infections may result in abscess formation. Attention to hygienic procedures can minimize their occurrence.

Following injections at the posterior aspect of the ear where it attaches to the head (base of the ear), areas of discoloration and signs of inflammation may persist at least 13 days post administration resulting in trim loss of edible tissue at slaughter. Injection of volumes greater than 20 mL, in the middle third of the ear, may result in open draining lesions in a small percentage of cattle.

The effects of ceftiofur on bovine reproductive performance, pregnancy, and lactation have not been determined.

ADVERSE EFFECTS

Administration of EXCEDE Sterile Suspension into the ear arteries is likely to result in sudden death in cattle. During the conduct of clinical studies, there was a low incidence of acute death (nine out of approximately 6000 animals). Three of these deaths were confirmed to be the result of inadvertent intra-arterial injection. No other adverse systemic effects were noted for either the antibiotic or formulation during any of the clinical and target animal safety studies.

STORAGE CONDITIONS

Store at controlled room temperature 20° to 25°C (68° to 77°F) [see USP]. Shake well before using. Contents should be used within 12 weeks after the first dose is removed.

HOW SUPPLIED

EXCEDE Sterile Suspension is available in the following package size: 100 mL vial

U.S. Patent No. 5,721,359 and other patents pending.

NADA #141-209, Approved by FDA

Distributed by:



Pharmacia & Upjohn Company
Division of Pfizer Inc, NY, NY 10017

www.EXCEDE.com or call 1-866-387-2287

818 188 004
692432
4725-23-000



Archer
Daniels
Midland
Company

is a proud partner

of the 2007

ADSA-PSA-AMPA-ASAS

Joint Annual Meeting.



RESOURCEFUL BY NATURE™

ADM
800-637-5824
www.admworld.com



**Support the ASAS Foundation
through the Next Century Fund:
Promoting**

****Membership **New programs
Continued sustainability

Contact ASAS@assochq.org for more information



PERFORMANCE MINERALS®

To be classified as Performance Minerals, products must meet essential measurable criteria based on the following principles:

- Return
- Response
- Repeatability
- Research
- Reassurance

If you're not sure what level of performance your current mineral program provides, talk to your feed supplier or nutritionist and ask for Zinpro Performance Minerals®.

800-445-6145 | www.zinpro.com

NOT ALL TRACE MINERALS ARE CREATED EQUAL.

The most effective source of organic minerals available today!

Kem TRACE®
brand Organic Trace Minerals

Micro-minerals are essential nutrients in all livestock diets. They act in distinct ways to help affect animal growth and immune functions for better performance.

Kemin offers the range of popular organic trace minerals all based on the propionate molecule – more bioavailable and thus more effective than any other source. Zinc, cobalt, copper, manganese and chromium. Contact us to learn why! Call Kemin Customer Service at **800-752-2864** for the name of your nearest Kemin representative!



Kemin AgriFoods North America, Inc.
2100 Maury Street, PO Box 70 Des Moines, IA, USA 50306-0070
phone: 515.559.5100 fax: 515.559.5232
www.kemin.com

TM Trademarks & Registered by Kemin Industries, Inc., USA. © 2007 Kemin Industries, Inc., USA

Milk Products
The Milk Replacer Source™

Outstanding Nutrition. Proven Performance.

Your source for specialized private-labeled milk replacers and Sav-A-Caf® brand products.

Customizing Relationships

Expert advice & service
Calf program planning
Support & training

Optimizing Growth

Superior mixability
Patented manufacturing
Excellent performance



An ISO-9001:2000
Certified Company

Milk Products, LLC
Chilton, WI 53014
1-800-657-0793
www.milkproductsinc.com

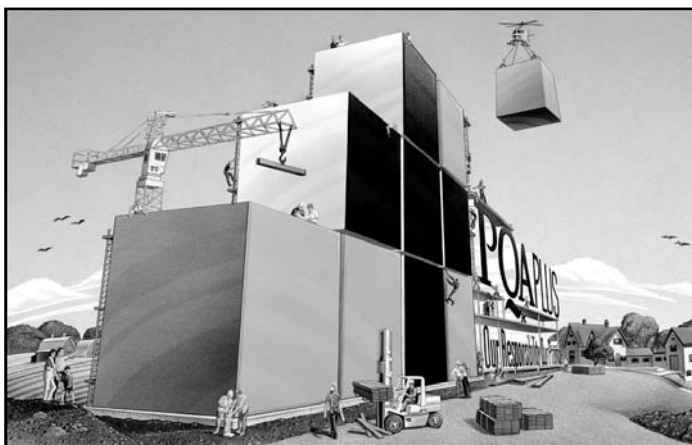

A strong foundation for a stronger future.



**pork
checkoff.**

visit pork.org or call the Pork Checkoff Service Center @ (800) 456-PORK

2007 ADSA-ASAS Corporate Sustaining Members (as of May 10, 2007)

ADSA

Adisseo
Ag Processing Inc.
Akey
Alltech Biotechnology Center
Arm & Hammer Animal Nutrition
BioZyme Incorporated
Cargill Animal Nutrition
Custom Dairy Performance, Inc.
Danisco USA Inc.
Darling International Research
Diamond V Mills Inc.
DSM Nutritional Products
Elanco Animal Health
Fort Dodge Animal Health
Grande Cheese Company
Kent Feeds, Inc.
Kraft Foods
Land O'Lakes Inc.
MIN-AD, Inc.
Monsanto Corporation
Novus International
Performance Products, Inc.
Pioneer, A DuPont Company
Prince Agri Products, Inc.
Pfizer Animal Health
Varied Industries Corporation
Westfalia Surge Inc.
Zook Nutrition & Management Inc.

ASAS

Ajinomoto Heartland LLC
Akey
Albion Advanced Nutrition
Archer Daniels Midland Co.
Babcock Genetics, Inc.
Darling International, Inc.
Diamond V Mills, Inc.
Elanco Animal Health
Global Pig Farms Inc.
International Ingredient Corporation
Kent Feeds Inc.
Land O'Lakes, Purina Feed LLC
MIN-AD, Inc.
Monsanto Company
National Pork Board
Nutra-Flo Protein and Biotech Products
PCS Sales (USA) Inc.
Pfizer Animal Health
PIC North America
Pioneer, A DuPont Company
Ralco Nutrition, Inc.
Trouw Nutrition USA
Zinpro Corporation

Thank you for your support!

2007 POULTRY SCIENCE JOURNAL SPONSORS

PATRONS

Archer Daniels Midland Co.
Ajinomoto Heartland, LLC
Cobb-Vantress, Inc.
Mosaic
Novus International, Inc.
Prince Agri Products, Inc.
Tyson Foods, Inc.

SUSTAINING MEMBERS

Adisseo USA, Inc.
Alpharma
Akey, Inc.
Aviagen
Cargill Animal Nutrition
Diamond V Mills, Inc.
Foster Farms
Huvepharma, Inc.
Hy-Line International
Land O'Lakes / Purina Feed, LLC
Lohmann Tierzucht GmbH
Nicholas Turkey Breeding Farms

2007 THE JOURNAL OF APPLIED POULTRY RESEARCH SPONSORS

GOLD PATRONS

Alpharma
Cobb-Vantress, Inc.
Degussa Corporation
Novus International, Inc.
Syngenta Animal Nutrition

SILVER PATRONS

ChemGen Corp.
Foster Farms
Griffin Industries, Inc.
Hybrid Turkeys
Hy-Line International
Perdue Farms, Inc.
Zinpro Corporation

Thank you for your support!

Downtown San Antonio

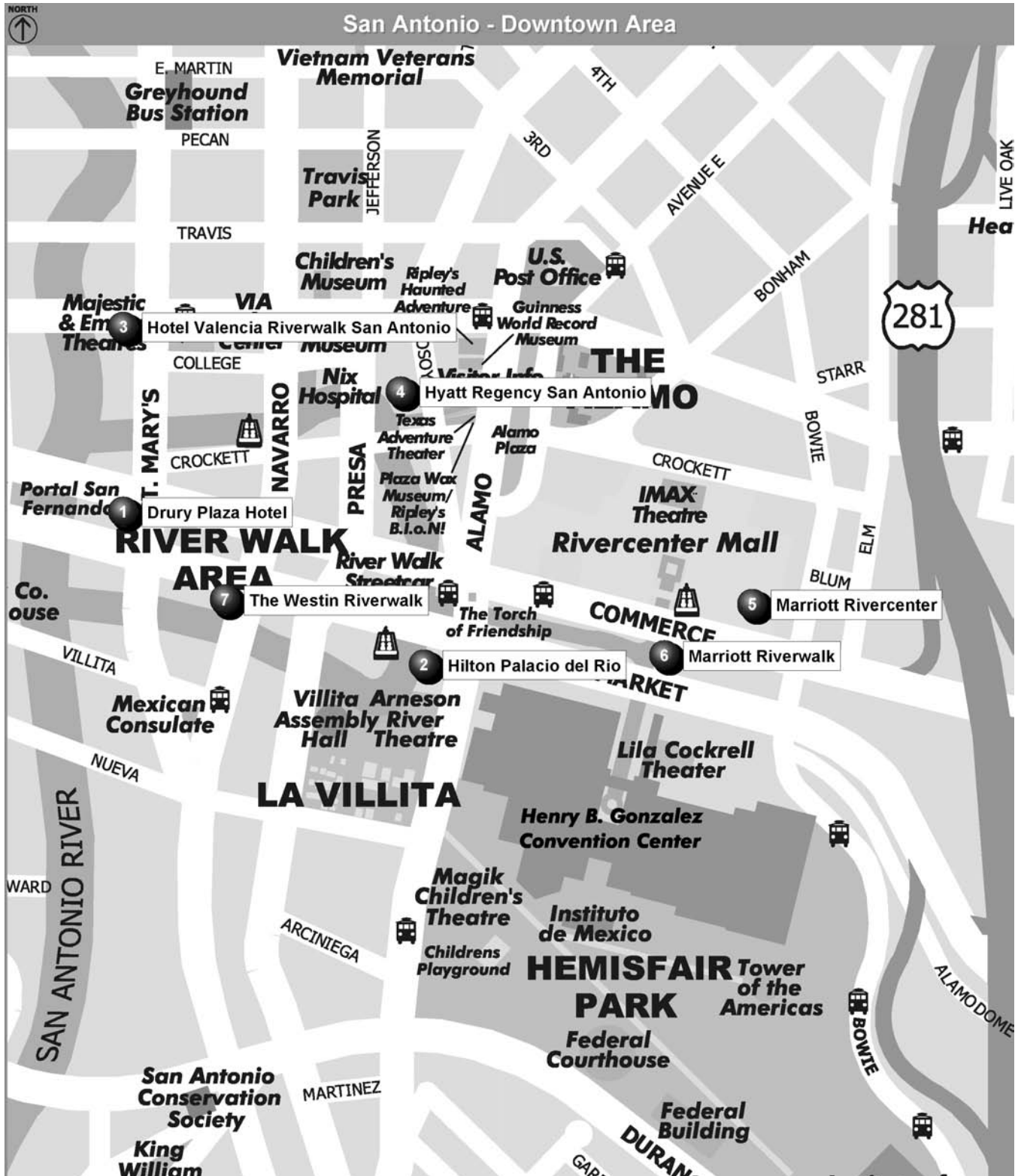

Henry B. Gonzales Convention Center

River Level

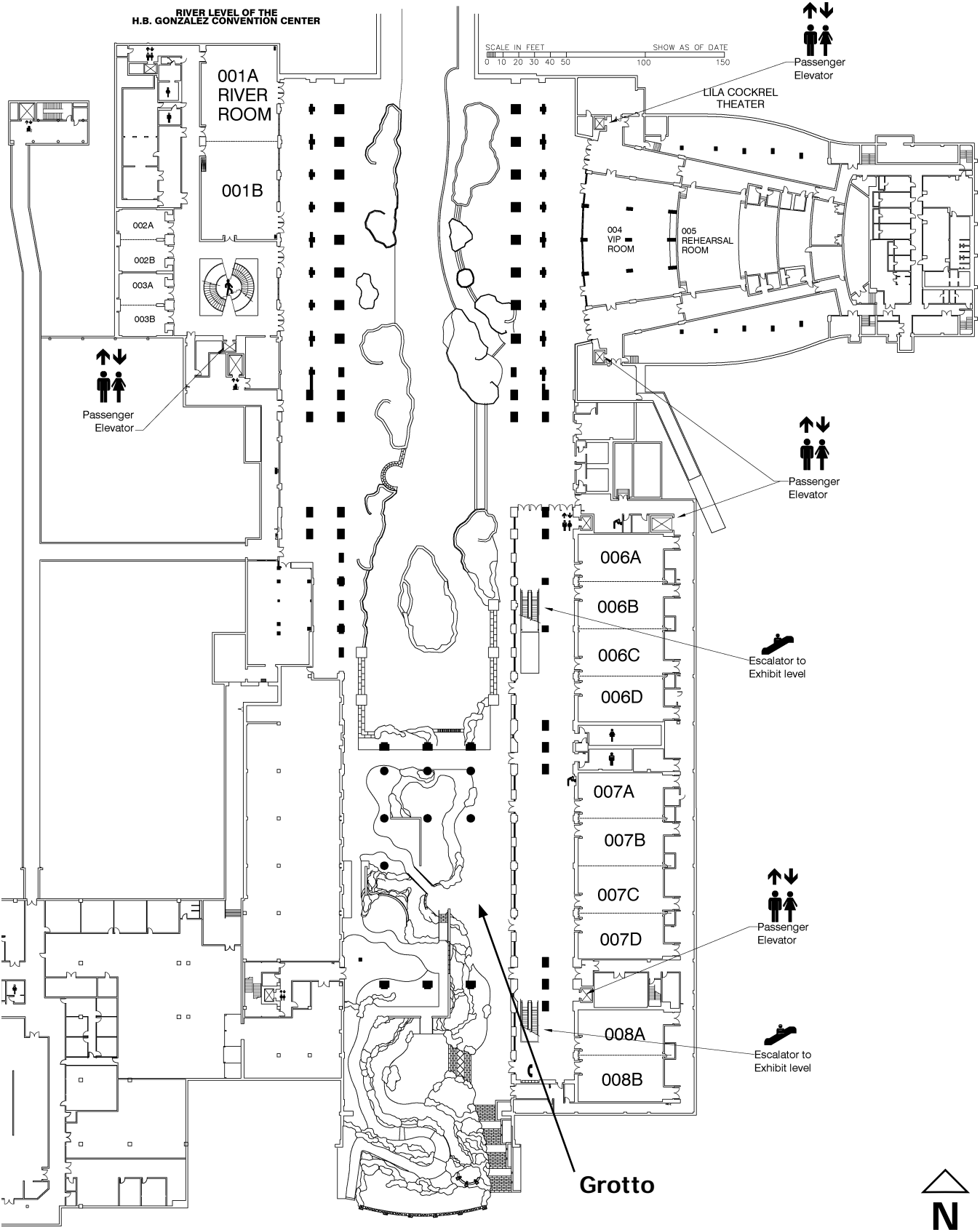

Henry B. Gonzales Convention Center

Street Level

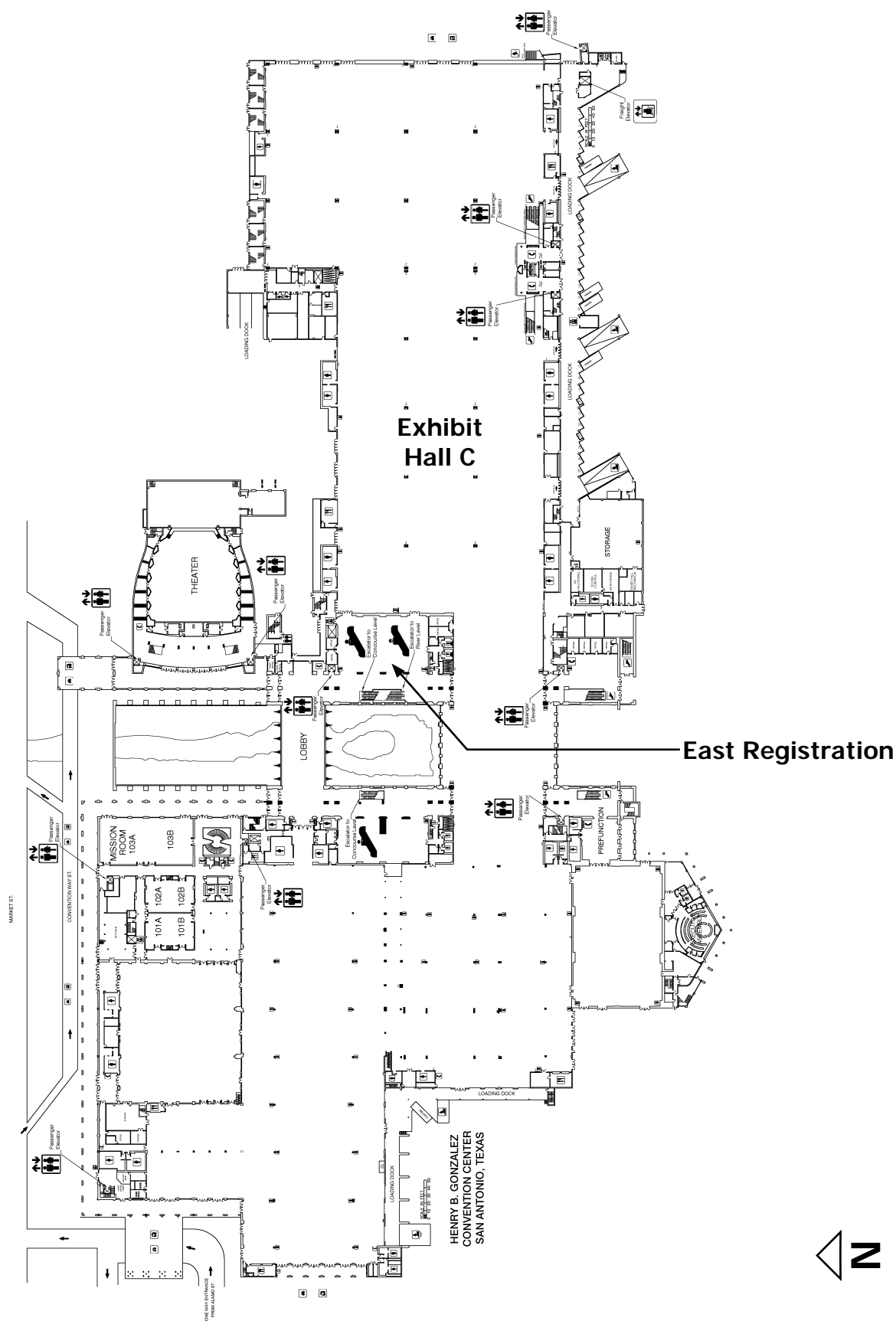

Henry B. Gonzales Convention Center

Exhibit Hall C

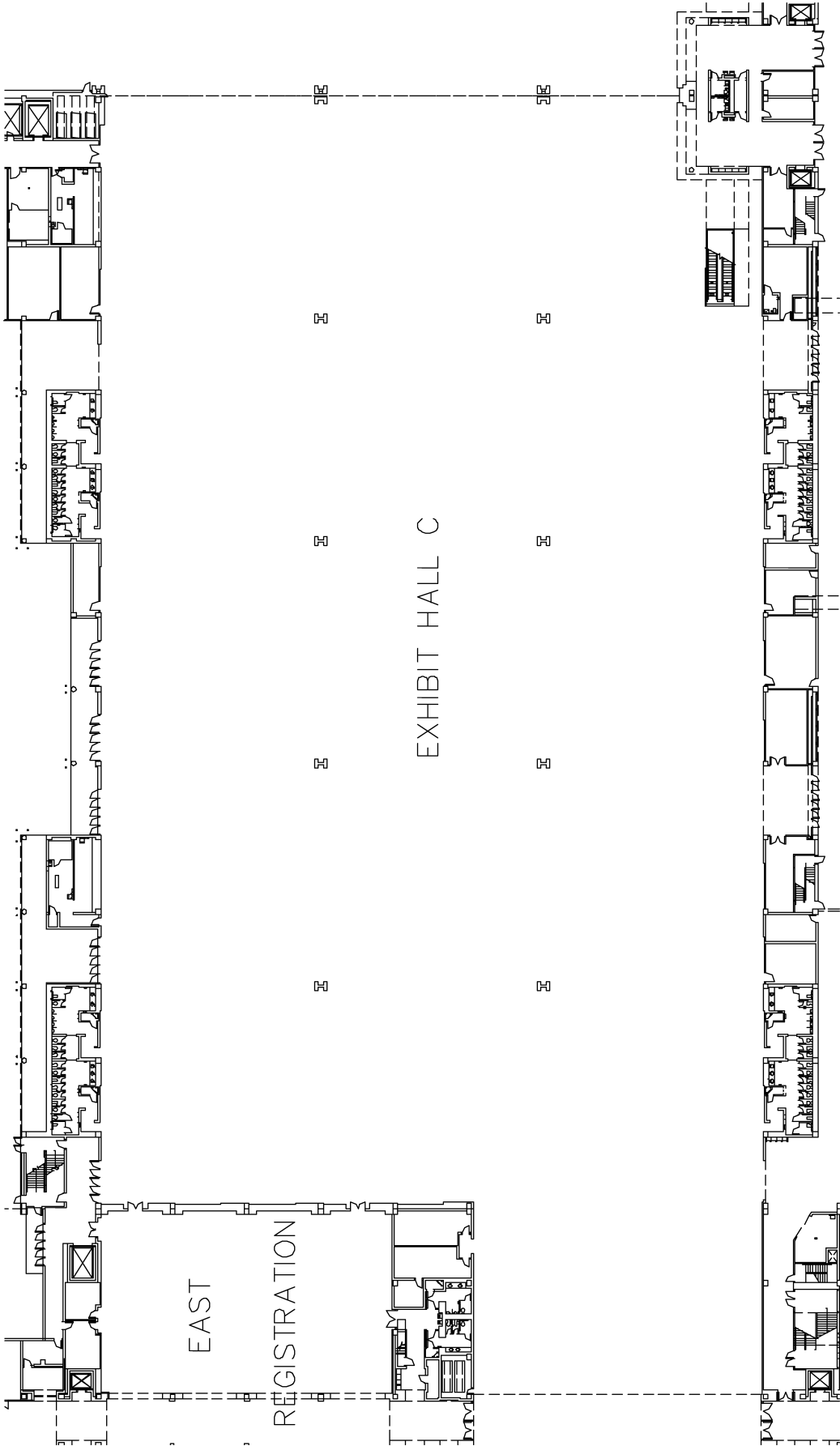

Maps



Henry B. Gonzales Convention Center

Ballroom C

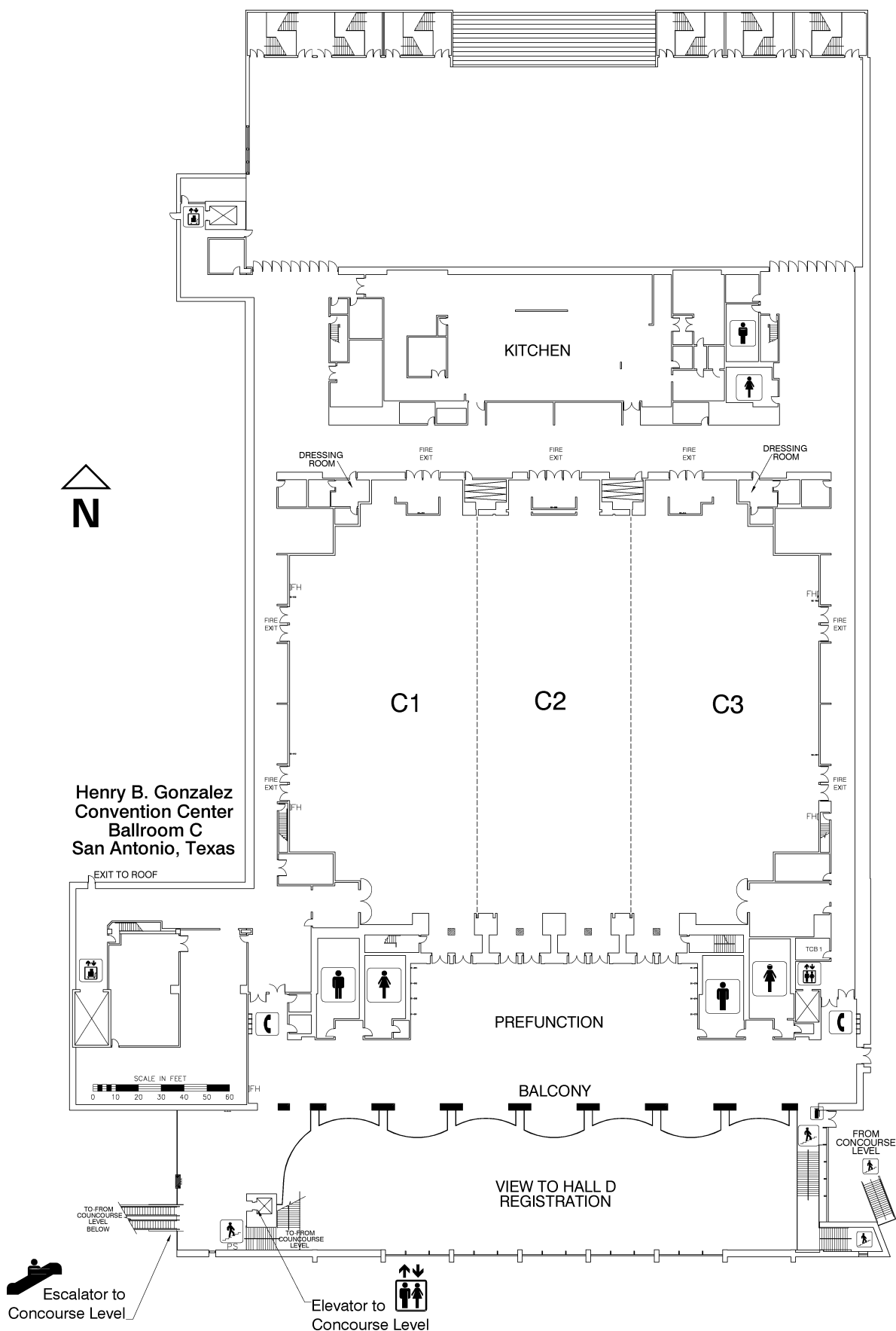

Hilton Palacio del Rio

Conference Center

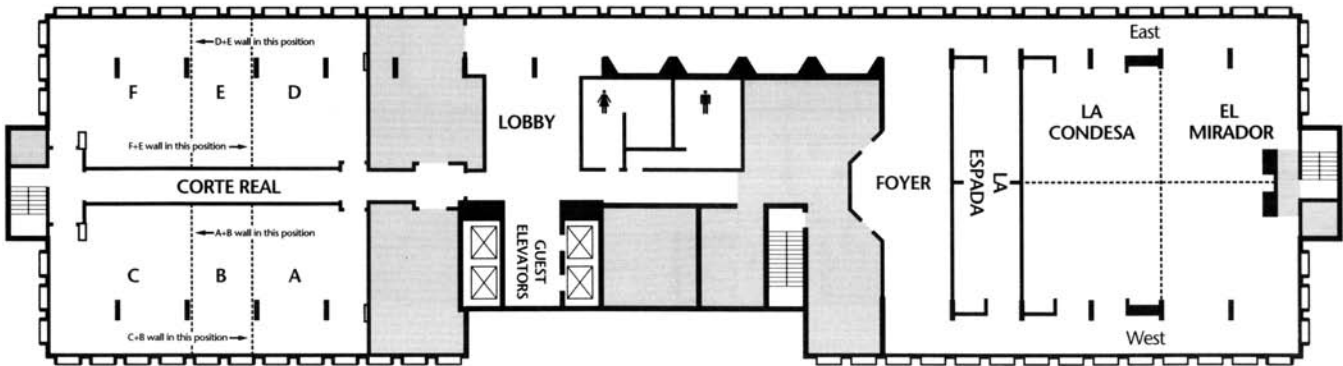

Mezzanine

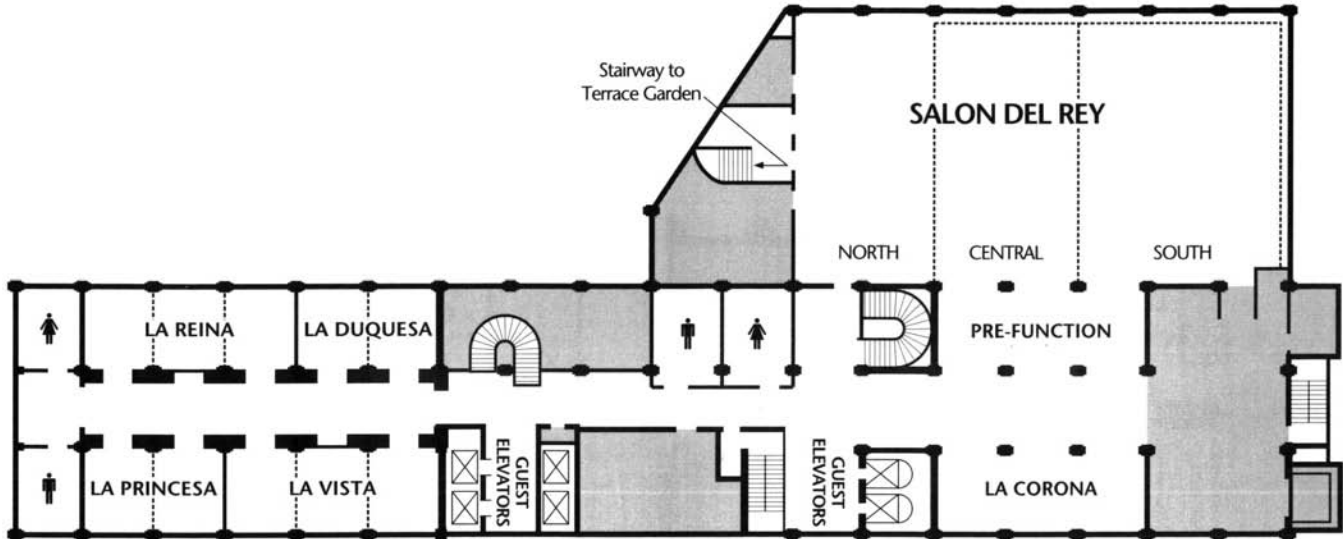

Lobby

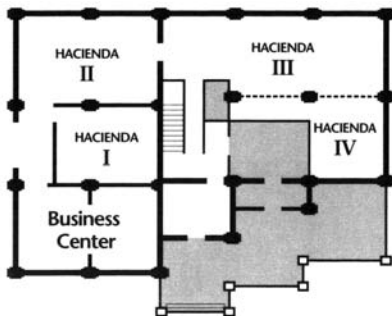

Marriott Rivercenter

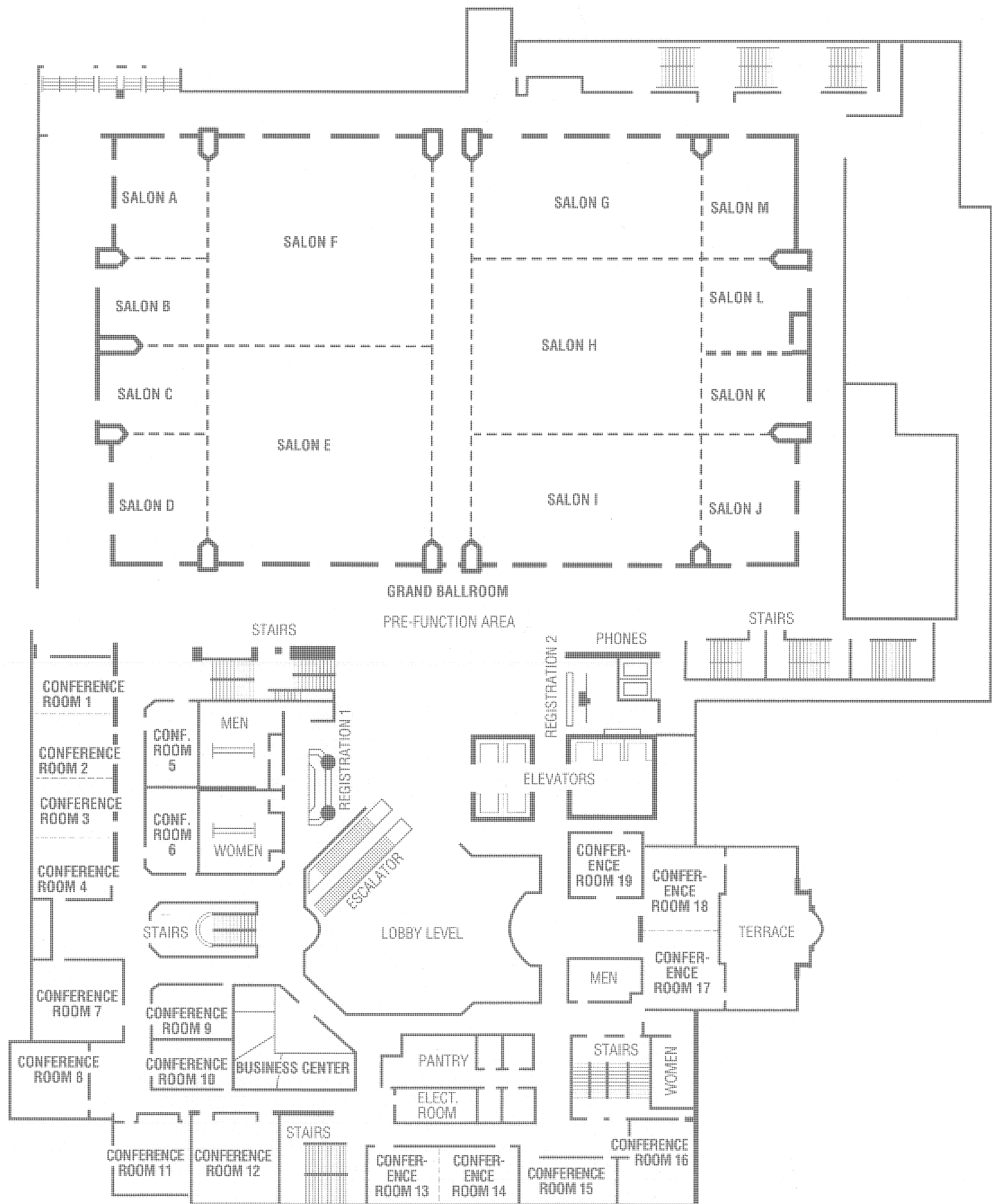

Marriott Riverwalk

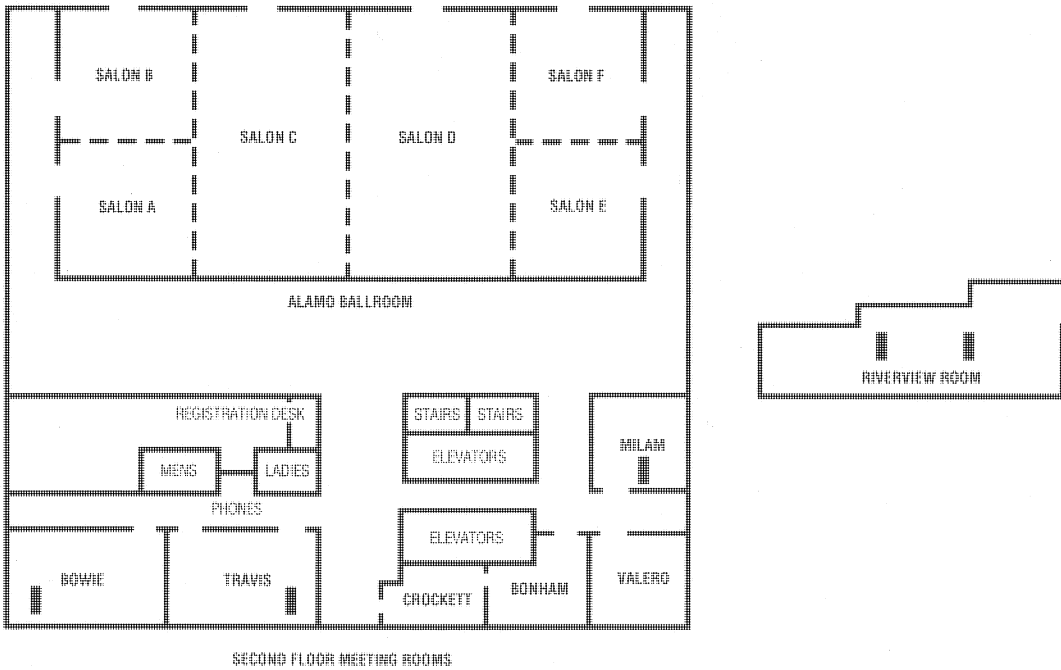

Thank you to the 2007 ADSA-PSA-AMPA-ASAS Joint Meeting Sponsors!

Platinum (\$20,000+)

Elanco Animal Health
Monsanto Company
Pfizer Animal Health

Gold (\$10,000+)

Ajinomoto Co., Inc. and Ajinomoto Heartland LLC
Alpharma
Diamond V Mills
DMI
European Association for Animal Production (EAAP)
Renewable Fuels Association

Silver (\$5,000+)

ABSTC
Biomim, USA
Church and Dwight Co., Inc./ Arm & Hammer Animal Nutrition
Danisco Animal Nutrition
DSM Nutritional Products
Iams
Jones-Hamilton
Novus International
USDA-CSREES
West Central

Bronze (\$2,500+)

Adisseo
Archer Daniels Midland Company
ASAS Foundation
Cargill Animal Nutrition
Cobb-Vantress
FASS
Kemin Americas, Inc.
Lucta USA, Inc.
Maple Leaf Farms
Milk Products, Inc.
Nestle Purina
Prince Agri-Products, Inc.
Ralco Nutrition, Inc.
Tyson Foods

Donor (\$1,500+)

Agilent Technologies
Asociacion Mexicana de Produccion Animal A.C. (AMPA)
Albion Advanced Nutrition
Ankom
American Society of Animal Science (ASAS)
BASF Plant Science/Ex Seed Genetics
California Dairy Research Foundation
Degussa
H.J. Baker & Bro.
MSC
National Pork Board
Southern Poultry Science Society
Syngenta Animal Nutrition
U.S. Poultry & Egg Association
Vi-Cor, Varied Industries Corporation
Zinpro Corporation

Contributor

American Sheep Industry (ASI)
Akey
Aviagen
BASF
Blue Seal Feeds
Herbuck Poultry Ranch, Inc.
Hilmar Ingredients
Huvepharma
Hybrid Turkeys
Lallemand Animal Nutrition
Premier 1 Supplies
Quality Technology International
Midwest Poultry Federation
Newsham Genetics
Renaissance Nutrition
Sydell
The Sheppard
United Feed Co-op, Inc.
Western Milling Quality Feeds

Schedule of Events

Scheduling and locations are subject to change without notice.

Friday, July 6

8:30 am - 4:30 pm	PSA Board of Directors Training	Hilton Palacio del Rio, Corte Real
4:00 pm - 6:00 pm	ASAS Membership Committee Meeting	Marriott Rivercenter, Conf. Rm. 10
7:00 pm - 9:00 pm	ASAS New Board Orientation Meeting/Dinner	Marriott Rivercenter, Conf. Rm. 11

Saturday, July 7

7:30 am - 5:00 pm	ADSA Board of Directors Meeting	Marriott Rivercenter, Conf. Rm. 5 & 18
8:00 am - 5:00 pm	PSA Board of Directors Meeting	Hilton Palacio del Rio, La Corona
8:00 am - 5:00 pm	ASAS Board of Directors Meeting	Marriott Rivercenter, Conf. Rm. 6 & 17
12:00 pm - 5:00 pm	Registration Open (Pre-registered, badge and material pick-up only)	Convention Center, East Registration
1:00 pm - 5:00 pm	William Chalupa Recognition Symposium	Convention Center, Room 006CD
3:15 pm - 4:30 pm	SAD Tour: The Alamo	Meet in the Hyatt lobby
5:00 pm - 6:00 pm	William Chalupa Recognition Reception	Convention Center, Grotto
5:15 pm - 7:00 pm	SAD Undergraduate Informal Mixer: Café Olé Riverwalk Cruise	Meet in the Hyatt lobby
7:00 pm - 9:00 pm	William Chalupa Recognition Dinner	Convention Center, Room 008AB
7:30 pm - 9:00 pm	ARPAS Executive Committee Meeting	Marriott Rivercenter, Conf. Suite 514

Sunday, July 8

7:00 am - 7:00 pm	Registration Open	Convention Center, East Registration
7:30 am - 10:00 am	ADSA New Board Orientation	Marriott Rivercenter, Conf. Rm. 16
8:00 am - 12:00 pm	ASAS Board of Directors Meeting	Marriott Rivercenter, Salon J
8:00 am - 5:00 pm	PSA Board of Directors Meeting	Hilton Palacio del Rio, La Corona
8:00 am - 5:00 pm	Commercial Exhibit Set-Up	Convention Center, Exhibit Hall C
8:00 am - 5:00 pm	Student Dairy Clubs Set Up Exhibits	Convention Center, Exhibit Hall C
8:00 am - 5:00 pm	ARPAS Governing Board Meeting	Marriott Rivercenter, Conf. Rm. 11
8:00 am - 5:00 pm	Hospitality Lounge	Convention Center, Room 208
8:00 am - 5:00 pm	Triennial Growth Symposium	Convention Center, Room 214D
11:00 am - 12:00 pm	SAD Officers and Advisor Meeting	Convention Center, Room 007B
12:00 pm - 1:00 pm	ADSA-SAD Midday Mixer and Taco Bar	Convention Center, Room 008AB
12:00 pm - 1:00 pm	ADSA JDS Editors and Journal Management Committee Luncheon	Marriott Rivercenter, Conf. Rm. 7
1:00 pm - 3:00 pm	ASAS Foundation Board of Trustees Meeting	Marriott Rivercenter, Conf. Rm. 16
1:00 pm - 5:00 pm	ADSA Journal Management Committee Meeting	Marriott Rivercenter, Conf. Rm. 7
1:00 pm - 5:00 pm	ADSA-SAD Quiz Bowl Seating/Preliminary Rounds	Convention Center, Rooms 007C & D
1:00 pm - 5:00 pm	Informal Nutrition Symposium	Convention Center, Room 214A
2:00 pm - 3:00 pm	ADSA Production Division Council Meeting	Convention Center, Room 204A
2:00 pm - 3:30 pm	ADSA Foundation Board of Trustees Meeting	Marriott Rivercenter, Conf. Rm. 5
3:00 pm - 4:00 pm	ADSA Production Division Nominating Committee	Convention Center, Room 204A

3:00 pm - 5:00 pm	2007 and 2008 Program Committee Meeting	Convention Center, Room 207B
4:30 pm - 6:30 pm	Plenary Session—The DC Connection: Science Policy, Research Support, and the Professional Animal Scientist	Convention Center, Room 205
5:00 pm - 6:00 pm	ADSA Dairy Foods Division Council Meeting	Convention Center, Room 204B
5:00 pm - 5:30 pm	ADSA-SAD Quiz Bowl Final Round	Convention Center, Room 007C
5:30 pm - 7:00 pm	Triennial Growth Symposium Reception	Convention Center, Room 214C
7:00 pm - 8:30 pm	2007 ADSA-PSA-AMPA-ASAS Opening Session . . .	Convention Center, Ballroom C
8:30 pm - 10:00 pm	2007 ADSA-PSA-AMPA-ASAS Opening Reception . .	Convention Center, Ballroom C

Monday, July 9

6:30 am - 9:00 am	ADSA Production Division Extension Breakfast	Marriott Rivercenter, Salon D
6:30 am - 8:00 am	Quadrennial Poultry Extension Workshop Breakfast . .	Hilton Palacio del Rio, Ibiza Restaurant
6:30 am - 4:00 pm	Registration Open	Convention Center, East Registration
7:00 am - 8:15 am	ADSA-SAD Exhibit Set-up	Convention Center, Exhibit Hall C
7:30 am - 9:30 am	Poster Presentations	Convention Center, Exhibit Hall C
7:30 am - 6:00 pm	Commercial Exhibits and ADSA-SAD Exhibits Open .	Convention Center, Exhibit Hall C
7:30 am - 5:00 pm	Job Resource Center	Convention Center, Exhibit Hall C
8:00 am - 5:00 pm	Hospitality Lounge	Convention Center, Room 208
8:30 am - 9:15 am	ADSA-SAD Business Meeting	Convention Center, Room 007C
9:30 am - 10:30 am	ADSA-SAD Judging of Yearbooks, Scrapbooks, Annual Reports	Convention Center, Room 007D
9:30 am - 10:30 am	ADSA-SAD Interviews for Outstanding Student and Advisor Awards	Convention Center, Room 008A
9:30 am - 10:45 am	ADSA-SAD Activities Symposium	Convention Center, Room 007C
9:30 am - 5:00 pm	Scientific Sessions	Convention Center
10:00 am - 11:00 am	ASAS Retirees Gathering	Convention Center, Room 216A
10:30 am - 12:30 pm	ARPAS Exam	Convention Center, Room 218
11:00 am - 5:00 pm	ADSA-SAD Undergraduate Paper Presentations	Convention Center, Room 007C
12:30 pm - 2:00 pm	ASAS Past Presidents' Luncheon	Marriott Rivercenter, Conf. Rm. 17-18
12:30 pm - 1:00 pm	ASAS Graduate Student Business Meeting	Convention Center, 207A
12:30 pm - 2:00 pm	ADSA Past Presidents' Luncheon	Marriott Rivercenter, Conf. Rm. 12
12:30 pm - 2:00 pm	ACAN Annual Meeting	Convention Center, Room 218
12:30 pm - 2:00 pm	ASAS Publications Committee Luncheon	Marriott Rivercenter, Conf. Rm. 5
12:30 pm - 2:00 pm	USDA-ARS Staff Update Luncheon	Convention Center, Room 007B
12:30 pm - 2:00 pm	Michigan State Lunch	Convention Center, Room 007A
2:00 pm - 4:00 pm	ARPAS Exam	Convention Center, Room 218
2:00 pm - 3:30 pm	DISCOVER Steering Committee Meeting	Convention Center, Room 216A
2:00 pm - 5:30 pm	Southern Branch ADSA Symposium and Business Meeting	Convention Center, Room 210
4:00 pm - 6:00 pm	Exhibitor Reception	Convention Center, Exhibit Hall C
5:00 pm - 7:00 pm	Informal Calf Gathering	Marriott Rivercenter, Salon M
5:00 pm - 6:00 pm	ADSA Town Hall Meeting	Convention Center, Room 206A
5:30 pm - 7:00 pm	ASAS Award Winners Reception and Photo Session . .	Marriott Rivercenter, Salon A-B
6:00 pm - 9:00 pm	SAD Informal Mixer: Picnic in the Park	HemisFair Park
7:00 pm - 8:30 pm	ASAS Awards Program	Marriott Rivercenter, Salon E

8:00 pm - 11:00 pm	Iowa State Reception	Marriott Rivercenter, Conf. Rm. 17-18
9:00 pm - Closing	Graduate Student Mixer	Steers & Beers Steakhouse and Saloon

Tuesday, July 10

6:15 am	5K Fun Run	Meet at the Convention Center
6:30 am - 8:00 am	ADSA Dairy Foods Division Extension Breakfast . . .	Marriott Rivercenter, Conf. Rm. 5
6:30 am - 8:00 am	JDS Editorial Board Breakfast/Meeting	Marriott Rivercenter, Conf. Rm. 6
6:30 am - 8:00 am	Penn State Breakfast	Marriott Rivercenter, Conf. Rm. 1-2
6:30 am - 8:00 am	University of Illinois Breakfast	Marriott Rivercenter, Conf. Rm. 3-4
6:30 am - 8:00 am	National Poultry Waste Organization Committee Breakfast	Convention Center, Room 007A
7:00 am - 8:00 am	Kentucky Breakfast	Marriott Rivercenter, Conf. Rm. 12
7:00 am - 3:30 pm	Registration Open	Convention Center, East Registration
7:30 am - 9:30 am	Poster Presentations	Convention Center, Exhibit Hall C
7:30 am - 5:00 pm	Commercial Exhibits and ADSA-SAD Exhibits Open .	Convention Center, Exhibit Hall C
7:30 am - 5:00 pm	Job Resource Center	Convention Center, Exhibit Hall C
8:00 am - 5:00 pm	Hospitality Lounge	Convention Center, Room 208
8:30 am - 9:30 am	ADSA-SAD Business Meeting - Election of Officers . .	Convention Center, Room 007C
9:30 am - 5:00 pm	Scientific Sessions	Convention Center
9:30 am - 10:15 am	ADSA-SAD Student Career Symposium	Convention Center, Room 007C
10:30 am - 11:30 am	ADSA-SAD Job Fair	Convention Center, Room 007D
10:30 am - 11:30 am	Spouse Event-Trolley Tour	The Alamo
11:30 am - 1:30 pm	Spouse Event-Luncheon	Menger Hotel
11:30 am - 12:30 pm	ADSA Production Division Business Meeting	Convention Center, Room 203
11:30 am - 12:30 pm	ADSA Dairy Foods Division Business Meeting	Convention Center, Room 201
11:45 am - 2:00 pm	ADSA-SAD Awards Luncheon	Convention Center, Room 008AB
12:30 pm - 2:00 pm	NE ASAS/ADSA Business Meeting and Awards Luncheon	Convention Center, Room 007B
12:30 pm - 2:00 pm	ADSA Dairy Foods Division Milk Proteins and Enzyme Committee	Convention Center, Room 201
12:30 pm - 2:00 pm	ARPAS Business Meeting	Convention Center, Room 207A
12:30 pm - 2:00 pm	ADSA Dairy Foods Division Program Planning Lunch .	Marriott Rivercenter, Conf. Rm. 10
12:30 pm - 2:00 pm	ASAS Editors' Luncheon	Marriott Rivercenter, Conf. Rm. 1-2
12:30 pm - 2:00 pm	PSA Student Luncheon	Hilton Palacio del Rio, El Mirador
12:30 pm - 2:00 pm	Poultry Extension Luncheon	Convention Center, Room 007A
2:00 pm - 3:00 pm	WPSA Lecture	Convention Center, Room 205
3:00 pm - 5:00 pm	PSA Business Meeting	Convention Center, Room 205
2:00 pm - 4:00 pm	ARPAS Exam	Convention Center, Room 218
2:00 pm - 3:00 pm	ADSA-SAD Award and Club Photos	Convention Center, Room 007C
2:30 pm - 3:30 pm	ADSA-SAD Committee Meeting - Old and New Officers and Advisors	Convention Center, Room 007D
3:30 pm - 5:00 pm	ASAS JAS Forum (Division/Associate Editors and Authors)	Convention Center, Room 206A
4:00 pm - 4:30 pm	CAST Issue Paper	Convention Center, Room 207A
4:30 pm - 5:00 pm	Three I's and U: A CAST Town Hall Meeting	Convention Center, Room 207A

5:00 pm - 6:00 pm	San Antonio River Talk: The ASAS Open Forum	Convention Center, Room 203
5:00 pm - 6:30 pm	ADSA Award Donor Dinner	Marriott Rivercenter, Conf. Rm. 17-18
7:00 pm - 8:00 pm	ADSA Awards Program	Marriott Rivercenter, Salon A-B
8:15 pm - 9:30 pm	2007 ADSA-PSA-AMPA-ASAS Ice Cream Social . . .	Marriott Rivercenter, Salon I
8:15 pm - 9:30 pm	ADSA Foundation Auction and Raffle	Marriott Rivercenter, Salon E

Wednesday, July 11

6:30 am - 8:00 am	<i>Poultry Science</i> Editors' Meeting and Breakfast	Hilton Palacio del Rio, La Princesa
6:30 am - 8:00 am	Purdue University Breakfast	Marriott Rivercenter, Conf. Rm. 17-18
6:30 am - 8:00 am	Virginia Tech Breakfast	Marriott Rivercenter, Conf. Rm. 7
7:00 am - 3:00 pm	Registration Open	Convention Center, East Registration
7:30 am - 9:30 am	Poster Presentations	Convention Center, Exhibit Hall C
7:30 am - 5:00 pm	Job Resource Center	Convention Center, Exhibit Hall C
7:30 am - 3:00 pm	Commercial Exhibits Open	Convention Center, Exhibit Hall C
8:00 am - 5:00 pm	Hospitality Lounge	Convention Center, Room 208
8:00 am - 10:00 am	PSA 2008 Committee Chairs Meeting	Hilton Palacio del Rio, La Duquesa
9:30 am - 10:00 am	Joint ADSA-ASAS Business Meeting	Convention Center, Room 206B
10:00 am - 10:30 am	ADSA Business Meeting	Convention Center, Room 206A
10:00 am - 10:30 am	ASAS Business Meeting	Convention Center, Room 207A
10:00 am - 10:30 am	AMPA Business Meeting	Convention Center, Room 207B
10:30 am - 5:00 pm	Scientific Sessions	Convention Center
12:30 pm - 2:00 pm	ADSA Board of Directors Meeting	Marriott Rivercenter, Conf. Rm. 18
12:30 pm - 2:00 pm	American Poultry Historical Society Luncheon	Hilton Palacio del Rio, Ibiza Restaurant
12:30 pm - 2:00 pm	JAPR Editors' Meeting and Luncheon	Hilton Palacio del Rio, La Princesa
12:30 pm - 2:00 pm	PSA New Board Luncheon	Hilton Palacio del Rio, La Corona
12:30 pm - 2:00 pm	Feed Analysis Consortium	Convention Center, Room 205
1:00 pm - 2:30 pm	ASAS Board of Directors Meeting	Marriott Rivercenter, Conf. Rm. 17
2:00 pm - 4:00 pm	ARPAS Exam	Convention Center, Room 218
3:00 pm - 6:00 pm	Commercial Exhibits Dismantle	Convention Center, Exhibit Hall C
4:30 pm - 6:00 pm	2007 Closing Reception	Convention Center, Room 006
3:00 pm - 5:00 pm	GrowSafe User Group Meeting	Convention Center, Room 204A
5:30 pm - 7:00 pm	Distillers Grains Symposium Reception	Convention Center, Tower View Lobby
6:00 pm - 10:00 pm	PSA Awards Banquet	Hilton Palacio del Rio, Salon del Rey
6:30 pm - 10:30 pm	AMPA Dinner	Marriott Rivercenter, Conf. Rm. 17-18

Thursday, July 12

8:00 am - 10:30 am	ADSA-ASAS-PSA Joint Executive Committee Breakfast	Marriott Rivercenter, Conf. Rm. 18
8:00 am - 10:00 am	Registration Open	Convention Center, East Registration
8:30 am - 11:30 am	Scientific Sessions	Convention Center

ADSA Student Affiliate Division Program

SAD Special Events

Scheduling and locations are subject to change without notice.

Saturday, July 7

*SAD Tour: The Alamo**

3:30 pm – 4:30 pm

The Alamo, 300 Alamo Plaza in downtown San Antonio

Meet in the Hyatt lobby by 3:15 pm to walk as a group

**Pre-registration required*

More than 2.5 million people a year visit the 4.2-acre complex known worldwide as “The Alamo.” Most come to see the old mission where a small band of Texans held out for 13 days against the Centralist army of General Antonio López de Santa Anna. Located on Alamo Plaza in downtown San Antonio, the Alamo represents nearly 300 years of history. Three buildings—the Shrine, Long Barrack Museum and Gift Museum—house exhibits on the Texas Revolution and Texas history. Visitors are welcome to stroll through the beautiful Alamo Gardens. Just a short distance from the River Walk and the Hyatt (the student hotel), the Alamo is a “must see” for all who come to San Antonio.

*SAD Undergraduate Evening Informal Mixer: Café Olé Riverwalk Cruise**

5:30 pm – 7:00 pm

Café Olé, 521 Riverwalk (located at the corner of Losoya and Commerce Streets)

Meet in the Hyatt lobby by 5:15 pm to walk as a group (approx. two blocks)

**Pre-registration required*

No trip to San Antonio is complete without a beautiful cruise along the San Antonio River. The River Walk is one of the largest tourist attractions in San Antonio. Located in the city’s downtown area, the San Antonio River Walk is three miles of riverfront walking area winding under the busy streets and bridges of San Antonio. The Café Olé Riverwalk Cruise offers onboard soft drinks and cocktails. This will be a great opportunity to get acquainted with the area and discover the many fine shops, restaurants, cafés, clubs, and hotels that line the San Antonio River Walk.

Sunday, July 8

*SAD Midday Mixer and Taco Bar**

12:00 pm – 1:00 pm

Convention Center, 008AB

**Pre-registration required*

Plan to join us for the first official event of the Student Affiliate Division Meetings. The mixer is a great way to have a free lunch and become acquainted with undergrads from other clubs who will be participating in the meetings. Registration is limited to undergraduate students and advisors.

Dairy Quiz Bowl
1:00 pm – 5:30 pm
Convention Center, 007C-007D

The Dairy Quiz Bowl invites teams from all universities to participate in this year's event. Seating test will be held immediately following the Midday Mixer and Pizza Party. Once teams are placed, competition will begin and continue throughout the afternoon. The top teams will move onto the final round, which will be held on Sunday evening at 5:00 pm. To enter your club's team, go the meetings section of the ADSA-SAD web site at www.adsa.org/sad.asp/.

Monday, July 9

SAD Informal Mixer: Picnic in the Park*
6:00 pm – 9:00 pm
HemisFair Park (200 South Alamo Street)
Go South on Losoya past Rivercenter Mall, approximately 0.9 miles
Meet in the Hyatt lobby by 5:45 pm to walk as a group
****Pre-registration required***

Get ready for a mix of Southern hospitality and Southern home cookin'—a taste of Louisiana in the heart of Texas! This picnic features Louisiana jambalaya, white beans, and salad, and is set in one of San Antonio's outdoor jewels, HemisFair Park. Originally created as the grounds for the 1968 World's Fair, this park is a favorite of locals and visitors alike. Stroll through the park's 12 acres of fountains, pools, and beautifully landscaped grounds.

Tuesday, July 10

SAD Career Symposium: Student Job Fair
9:30 am – 11:30 am
Convention Center, Exhibit Hall C

This two-part program will begin with a career panel of professionals representing various facets of the animal agriculture industry. Students will have the opportunity to visit with the panelists and learn about careers in the industry, get useful tips on career planning, and much more. After the panel, students will attend the Student Job Fair in the Exhibit Hall. More than 70 companies related to the dairy and animal science industry will be in the Exhibit Hall, so students will have ample opportunity to visit with company reps, and inquire about careers and internships that may be available to undergraduate students. Students are encouraged to dress professionally (business casual or better) and bring several copies of their resumes.

SAD Awards Luncheon*
11:45 am – 2:00 pm
Convention Center, 008AB
****Pre-registration required***

Plan to attend this year's SAD Awards Luncheon. Back by popular demand—be entertained as the student officers go head-to-head with ADSA Board members in a mini dairy quiz bowl! See who really knows more about the history of ADSA and the dairy industry! There are sure to be a few surprises and plenty of laughs along the way. The afternoon will culminate with the presentation of student awards and announcement of new SAD officers. Both students and professionals are encouraged to attend. This is a wonderful chance to get to know the next generation of the dairy industry.

SAD Schedule of Events

Scheduling and locations are subject to change without notice.

Saturday, July 7

12:00 pm - 5:00 pm	Registration Open (Pre-registered, badge and material pick-up only)	Convention Center, East Registration
3:15 pm - 4:30 pm	SAD Tour: The Alamo	Meet in the Hyatt lobby
5:15 pm - 7:00 pm	SAD Undergraduate Informal Mixer: Café Olé Riverwalk Cruise	Meet in the Hyatt lobby

Sunday, July 8

7:00 am - 7:00 pm	Registration Open	Convention Center, East Registration
8:00 am - 5:00 pm	Student Dairy Clubs Exhibit Set-Up	Convention Center, Exhibit Hall C
11:00 am - 12:00 pm	SAD Officers and Advisor Meeting	Convention Center, Room 007B
12:00 pm - 1:00 pm	ADSA-SAD Midday Mixer and Taco Bar	Convention Center, Room 008AB
1:00 pm - 5:00 pm	ADSA-SAD Quiz Bowl Seating/Preliminary Rounds . .	Convention Center, Rooms 007C & 007D
5:00 pm - 5:30 pm	ADSA-SAD Quiz Bowl Final Round	Convention Center, Room 007C
7:00 pm - 8:30 pm	2007 ADSA-PSA-AMPA-ASAS Opening Session . . .	Convention Center, Ballroom C
8:30 pm - 10:00 pm	2007 ADSA-PSA-AMPA-ASAS Opening Reception . .	Convention Center, Ballroom C

Monday, July 9

6:30 am - 4:00 pm	Registration Open	Convention Center, East Registration
7:00 am - 8:15 am	ADSA-SAD Exhibit Set-Up	Convention Center, Exhibit Hall C
7:30 am - 9:30 am	Poster Presentations	Convention Center, Exhibit Hall C
7:30 am - 6:00 pm	Commercial Exhibits and ADSA-SAD Exhibits Open .	Convention Center, Exhibit Hall C
8:30 am - 9:15 am	ADSA-SAD Business Meeting	Convention Center, Room 007C
9:30 am - 10:30 am	ADSA-SAD Judging of Yearbooks, Scrapbooks, Annual Reports	Convention Center, Room 007D
9:30 am - 10:30 am	ADSA-SAD Interviews for Outstanding Student and Advisor Awards	Convention Center, Room 008A
9:30 am - 10:45 am	ADSA-SAD Activities Symposium	Convention Center, Room 007C
11:00 am - 5:00 pm	ADSA-SAD Undergraduate Paper Presentations	Convention Center, Room 007C
4:00 pm - 6:00 pm	Exhibitor Reception	Convention Center, Exhibit Hall C
6:00 pm - 9:00 pm	SAD Informal Mixer: Picnic in the Park	HemisFair Park

Tuesday, July 10

6:15 am	Fun Run	Meet at the Convention Center
7:00 am - 3:30 pm	Registration Open	Convention Center, East Registration
7:30 am - 9:30 am	Poster Presentations	Convention Center, Exhibit Hall C
7:30 am - 5:00 pm	Commercial Exhibits and ADSA-SAD Exhibits Open .	Convention Center, Exhibit Hall C
8:30 am - 9:30 am	ADSA-SAD Business Meeting - Election of Officers . .	Convention Center, Room 007C
9:30 am - 10:15 am	ADSA-SAD Student Career Symposium	Convention Center, Room 007C
10:30 am - 11:30 am	ADSA-SAD Job Fair	Convention Center, Exhibit Hall C
11:45 pm - 2:00 pm	ADSA-SAD Awards Luncheon	Convention Center, Room 008AB
2:00 pm - 3:00 pm	ADSA-SAD Award and Club Photos	Convention Center, Room 007C
2:30 pm - 3:30 pm	ADSA-SAD Committee Meeting - Old and New Officers and Advisors	Convention Center, Room 007D
3:00 pm - 5:00 pm	Open to attend sessions	Convention Center, Exhibit Hall C
3:00 pm - 5:00 pm	Dismantle SAD Exhibits	Convention Center, Exhibit Hall C
7:00 pm - 8:00 pm	ADSA Awards Program	Marriott Rivercenter, Salon A-B
8:15 pm - 9:30 pm	2007 ADSA-PSA-AMPA-ASAS Ice Cream Social . . .	Marriott Rivercenter, Salon I
8:15 pm - 9:30 pm	ADSA Foundation Auction and Raffle	Marriott Rivercenter, Salon E

Wednesday, July 11

7:00 am - 3:00 pm	Registration Open	Convention Center, East Registration
7:30 am - 9:30 am	Poster Presentations	Convention Center, Exhibit Hall C
7:30 am - 3:00 pm	Commercial Exhibits Open	Convention Center, Exhibit Hall C
10:30 am - 5:00 pm	Scientific Sessions	Convention Center
3:00 pm - 6:00 pm	Dismantle Commercial Exhibits	Convention Center, Exhibit Hall C
4:30 pm - 6:00 pm	2007 Closing Reception	Convention Center, 006

Thursday, July 12

8:00 am - 10:00 am	Registration Open	Convention Center, East Registration
8:30 am - 11:30 pm	Scientific Sessions	Convention Center

Scientific Program Table of Contents

Sunday, July 8

SYMPOSIA

SYMPOSIUM: Triennial Growth Symposium: Interface Between Growth and Immunology	73
SYMPOSIUM: Informal Nutrition Symposium: The Impact of Imprinting on Biological and Economic Performance of Animals	74
PLENARY SESSION: The DC Connection: Scientific Policy, Research Support, and the Professional Animal Scientist	74

Monday, July 9

POSTER PRESENTATIONS

Animal Behavior & Well-Being - Livestock and Poultry I	75
Animal Health - Livestock and Poultry: Bovine I	75
Breeding and Genetics - Livestock and Poultry I	76
Egg and Meat Science and Muscle Biology - Livestock and Poultry I	78
Extension Education - Livestock and Poultry	79
Food Safety - Livestock and Poultry	80
Forages and Pastures - Livestock and Poultry: Forage Quality and Nutritive Value	81
Goat Species I	82
Growth and Development - Livestock and Poultry I	83
Immunology - Livestock and Poultry I	84
International Animal Agriculture - Livestock and Poultry	85
Lactation Biology: Mechanisms Regulating Lactation and Mammary Function	85
National ADSA Production Division Graduate Poster Competition	87
Nonruminant Nutrition: General Nonruminant Nutrition	87
Nonruminant Nutrition: Poultry Nutrition I	88
Nonruminant Nutrition: Weanling Pig Nutrition and Physiology	89
Physiology & Endocrinology - Livestock and Poultry: Endocrinology and Metabolism	90

Production, Management & the Environment - Livestock and Poultry I	92
Ruminant Nutrition I	93

SYMPOSIA AND ORAL SESSIONS

ADSA Southern Branch Graduate Student Competition	99
SYMPOSIUM: Alpharma Beef Cattle Nutrition Symposium	99
Animal Behavior & Well-Being - Livestock and Poultry I	99
Animal Health - Livestock and Poultry: Poultry and Swine I	100
SYMPOSIUM: Bio Ethics - Livestock and Poultry:	
The Ethics of Food Animal Production, Processing and Marketing	101
Breeding and Genetics - Livestock and Poultry: Poultry	101
SYMPOSIUM: Egg and Meat Science and Muscle Biology - Livestock and Poultry:	
Meat Packaging and Shelf Life	102
SYMPOSIUM: Food Safety - Livestock and Poultry:	
Current and Future Salmonella Challenges	102
Horse Species	103
Immunology - Livestock and Poultry I	103
Graduate Student Paper Competition: National ADSA Dairy Foods Division	104
Nonruminant Nutrition: Bioactive Compounds and Prebiotics in Swine Nutrition	105
Nonruminant Nutrition: Poultry Nutrition - Protein and Amino Acids	106
Nonruminant Nutrition: Swine Mineral Nutrition and Metabolism	107
Physiology & Endocrinology - Livestock and Poultry: Estrous Synchronization	108
Production, Management & the Environment - Livestock and Poultry:	
Dairy Production and Management I	108
Production, Management & the Environment - Livestock and Poultry:	
Poultry Production, Management and Environment	109
Ruminant Nutrition: Feedstuff Modification and Growing/Finishing Nutrition	110
Ruminant Nutrition: Ruminal Fermentation - Dairy	111
SYMPOSIUM: Teaching/Undergraduate & Graduate Education:	
Visual Learning in Animal Science	112
Graduate Student Competition ADSA-ASAS Northeastern Branch	112
ADSA-SAD Undergraduate Competition - Dairy Production	113

SYMPOSIUM: Dairy Foods: The Dairy Management Inc. National Dairy Foods Research Center Program: Responding to Industry Needs for New Technologies, Products and Markets. . . .	113
SYMPOSIUM: ADSA Southern Section Symposium: Keeping Dairy Going and Growing . . .	114
ADSA-SAD Undergraduate Competition - Dairy Foods	115
SYMPOSIUM: Bio Ethics - Livestock and Poultry: The Ethics of Food	115
Breeding and Genetics - Livestock and Poultry: Beef Cattle	115
Breeding and Genetics - Livestock and Poultry: Dairy Cattle I	116
Companion Animals: Companion and Comparative Animal Nutrition	117
Dairy Foods: Cheese I	118
SYMPOSIUM: Egg and Meat Science and Muscle Biology - Livestock and Poultry: Meat Marination	118
Food Safety - Livestock and Poultry: Cattle and Swine	119
SYMPOSIUM: Forages and Pastures - Livestock and Poultry: Tropical Forages: Management and Environmental Issues Affecting Use Efficiency	119
SYMPOSIUM: Horse Species: Recent Advances in Understanding Metabolic Disorders in Horses	120
Lactation Biology: Metabolism and Gene Expression in Support of Lactation	120
Graduate Student Paper Competition: National ADSA Production Division	121
Nonruminant Nutrition: Poultry Nutrition - Gut Health and Early Nutrition	122
Nonruminant Nutrition: Poultry Nutrition - Breeder and Laying Hen Nutrition and Broiler Environment	123
Physiology & Endocrinology - Livestock and Poultry: Poultry	124
Production, Management & the Environment - Livestock and Poultry: Broiler and Broiler Breeder Production and Management	125
Production, Management & the Environment - Livestock and Poultry: Dairy Production and Management II	126
Ruminant Nutrition: Nitrogen Metabolism/Immunology	127
SYMPOSIUM: Ruminant Nutrition: Opportunities to Improve Forage Utilization and Rumen Function	128
SYMPOSIUM: Teaching/Undergraduate & Graduate Education: Enhancing the Undergraduate Learning Experience in Animal Agriculture, Through the Integration of Teaching and Research	128
ADSA-SAD Undergraduate Competition - Original Research	129

Tuesday, July 10

POSTER PRESENTATIONS

Animal Behavior & Well-Being - Livestock and Poultry II	130
Animal Health - Livestock and Poultry: Poultry/Swine/Goat/Sheep	130
Beef Species	132
Breeding and Genetics - Livestock and Poultry II	133
Companion Animals: Nutrition and Health	134
Contemporary & Emerging Issues - Livestock and Poultry	135
Dairy Foods: Cheese, Dairy Products and Chemistry	135
Egg and Meat Science and Muscle Biology - Livestock and Poultry II	137
Forages and Pastures - Livestock and Poultry: Harvested Forages: Fermentation and Nutritive Quality	138
Goat Species II	139
Growth and Development - Livestock and Poultry II	140
Immunology - Livestock and Poultry II	141
Nonruminant Nutrition: Feeder Pig and Sow Nutrition I	142
Nonruminant Nutrition: Poultry Nutrition II	144
Physiology & Endocrinology - Livestock and Poultry: Estrus Synchronization	146
Production, Management & the Environment - Livestock and Poultry II	148
Ruminant Nutrition II	149

SYMPOSIA AND ORAL SESSIONS

Animal Behavior & Well-Being - Livestock and Poultry II	154
Animal Health - Livestock and Poultry: Bovine I	154
Beef Species I	155
Breeding and Genetics - Livestock and Poultry: Analyses and Methods I	156
SYMPOSIUM: Breeding and Genetics - Livestock and Poultry: New Challenges and Opportunities From Automation of Animal Data Recording	157
Egg and Meat Science and Muscle Biology - Livestock and Poultry I	157
Food Safety - Livestock and Poultry: Poultry	158

SYMPOSIUM: Forages and Pastures - Livestock and Poultry:	
Understanding Diet Selection in Temperate Biodiverse Pasture Systems	159
SYMPOSIUM: Goat Species: Nutrient Requirement of Goats	160
Growth and Development - Livestock and Poultry I	160
Immunology - Livestock and Poultry II	161
SYMPOSIUM: Joint National Extension Workshop: Accountability Issues in Extension:	
Identifying, Measuring and Reporting Impacts	161
SYMPOSIUM: Nonruminant Nutrition: Lessons and Logistics of Application of Digestible	
Amino Acids in Diet Formulation	162
Nonruminant Nutrition: Poultry Nutrition - Enzymes, Feeds, Feed Ingredients,	
and Manufacturing	162
SYMPOSIUM: Physiology & Endocrinology - Livestock and Poultry:	
Role of Lipids and Fatty Acids in Regulation of Reproductive Function	163
Production, Management & the Environment - Livestock and Poultry:	
Poultry Production and Reproduction	163
Ruminant Nutrition: Acid:Base Balance/Metabolism - Dairy	164
Ruminant Nutrition: Corn Milling Co-Products - Beef	165
SYMPOSIUM: Teaching/Undergraduate & Graduate Education:	
Shaping Animal Sciences Curricula for 2020	166
ADSA Foundation Scholar Lecture – Dairy Foods	166
Danisco International Dairy Science Award Lecture	167
Growth and Development - Livestock and Poultry: Livestock and Poultry II	167

OTHER EVENTS

PSA Business Meeting	167
--------------------------------	-----

SYMPOSIA AND ORAL SESSIONS

World's Poultry Science Association Lecture	168
SYMPOSIUM: Animal Behavior & Well-Being - Livestock and Poultry:	
New Methodologies Symposium	168
Animal Health - Livestock and Poultry: Bovine II	168
Breeding and Genetics - Livestock and Poultry: Dairy Cattle II	169

SYMPOSIUM: Companion Animals: Pet Food Ingredients - Mining, Dredging, and Extrapolating Effective Nutrient Delivery	170
Dairy Foods: Chemistry and Microbiology	170
SYMPOSIUM: Dairy Foods: On the Road from Analysis and Discovery of Functional Milk Bioactives to New Products and Health Outcomes	171
Forages and Pastures - Livestock and Poultry: Harvesting, Ensiling, and Forage Quality	172
Goat Species	172
SYMPOSIUM: Joint National Extension Workshop: Changing the Future of Food Animal Production	173
Nonruminant Nutrition: Feeder Pig and Sow Nutrition	173
Nonruminant Nutrition: Protein and Amino Acid Nutrition in Swine	174
SYMPOSIUM: Nonruminant Nutrition: Understanding Protein Synthesis and Degradation and Their Pathway Regulations	175
Physiology & Endocrinology - Livestock and Poultry: Endocrinology	176
Ruminant Nutrition: Corn Milling Co-Products - Dairy	177
Ruminant Nutrition: Intake and Performance - Beef	177
SYMPOSIUM: Sheep Species: Biology and Management of Low-Input Lambing Management in Easy-Care Systems	178
Teaching/Undergraduate & Graduate Education: Teaching Session I - Assessment & Evaluation	179
ADSA Foundation Scholar Lecture - Production	179
Teaching/Undergraduate & Graduate Education: Teaching Session II - Curricular Innovation	179

OTHER EVENTS

A New CAST Paper: A Briefing	180
CAST Town Hall Meeting	180

Wednesday, July 11 ***POSTER PRESENTATIONS***

Animal Behavior & Well-Being - Livestock and Poultry III	181
Animal Health - Livestock and Poultry: Bovine II	181
Breeding and Genetics - Livestock and Poultry III	183
Dairy Foods: Dairy Processing, Products and Microbiology	184

Egg and Meat Science and Muscle Biology - Livestock and Poultry III	186
Forages and Pastures - Livestock and Poultry: Pastures and Grazing	187
Goat Species III	188
Nonruminant Nutrition: Feeder Pig and Sow Nutrition II	189
Nonruminant Nutrition: Poultry Nutrition III	191
Physiology & Endocrinology - Livestock and Poultry: Reproductive Physiology	193
Production, Management & the Environment - Livestock and Poultry III	195
Ruminant Nutrition III	196
Sheep Species: Sheep Production and Management	201
Swine Species	202
Teaching/Undergraduate & Graduate Education	203

OTHER EVENTS

ADSA/ASAS Joint Business Meeting	204
ADSA Business Meeting	204
ASAS Business Meeting	204
AMPA Business Meeting	204

SYMPOSIA AND ORAL SESSIONS

Animal Health - Livestock and Poultry: Poultry and Swine II	205
Nonruminant Nutrition: Poultry Nutrition - Ingredient and Mineral Nutrition	206
Production, Management & the Environment - Livestock and Poultry: Poultry Management, and Environment	206
SYMPOSIUM: Distillers Grains Symposium	207
SYMPOSIUM: ARPAS Symposium: Current and Future On-Farm Auditing & Assessment	208
Breeding and Genetics - Livestock and Poultry: Dairy Cattle III	208
Dairy Foods: Products and Processing	209
Egg and Meat Science and Muscle Biology - Livestock and Poultry II	209
Extension Education - Livestock and Poultry: Extension Dairy Session	210

Lactation Biology: Applied Lactation Biology	210
Production, Management & the Environment - Livestock and Poultry:	
Livestock, Production, and Management	211
Production, Management & the Environment - Livestock and Poultry:	
Livestock Production, Management, and Environment	212
Ruminant Nutrition: Nutrition and Animal Health	212
Ruminant Nutrition: Protein and Fiber Digestion	213
Swine Species	214
SYMPOSIUM: Teaching/Undergraduate & Graduate Education:	
From Choosing a Graduate Program to Embarking on a Successful Career:	
A Guide for Livestock and Poultry Science Students	214
Bio Ethics - Livestock and Poultry	215
SYMPOSIUM: Distillers Grains Symposium	215
SYMPOSIUM: ADSA Production Division Symposium	215
Breeding and Genetics - Livestock and Poultry: Swine	216
Dairy Foods: Cheese II	216
SYMPOSIUM: Dairy Foods: Milk Proteins and Enzymes: Proteomics and Milk	217
Extension Education - Livestock and Poultry: Extension Livestock Session	217
Forages and Pastures - Livestock and Poultry: Grazing	218
SYMPOSIUM: Growth and Development - Livestock and Poultry:	
Transcriptional Factors and Cell Mechanisms for Regulation of Growth and Development	
with Application to Animal Agriculture	219
SYMPOSIUM: International Animal Agriculture - Livestock and Poultry:	
Global Livestock and Poultry Issues	219
Nonruminant Nutrition: General Topics	220
SYMPOSIUM: Nonruminant Nutrition: Natural Phytobiotics for Health of Young Animals:	
Applications and Mechanisms	221
Nonruminant Nutrition: Weanling Pig Nutrition	221
Physiology & Endocrinology - Livestock and Poultry: Reproductive Physiology	222
SYMPOSIUM: Production, Management & the Environment - Livestock and Poultry:	
The Evolving National Animal Identification System	223
Ruminant Nutrition: Intake Behavior/Acidosis/Metabolism - Dairy	224

Ruminant Nutrition: Lipid Supplementation	225
Sheep Species: Sheep Production and Management	226

Thursday, July 12

SYMPOSIA AND ORAL SESSIONS

Beef Species II: Feed Intake and Efficiency	227
Breeding and Genetics - Livestock and Poultry: Analyses and Methods II	227
SYMPOSIUM: Contemporary & Emerging Issues - Livestock and Poultry:	
Contemporary and Emerging Issues	228
Nonruminant Nutrition: Poultry Nutrition - Phosphorus and Phytase	228
Physiology & Endocrinology - Livestock and Poultry: Metabolic Physiology	229
SYMPOSIUM: Poultry-Breeding and Hatchery Symposium:	
Semen Evaluation and Fertility Determination in Poultry	230
Ruminant Nutrition: Nitrogen Digestion/Metabolism	231
SYMPOSIUM: Swine Species: Impact of Season on the Boar and Sow	232
SYMPOSIUM: Teaching/Undergraduate & Graduate Education: Swine Teaching	232

ADSA Dairy Foods Division Schedule of Events

Sunday, July 8

5:00 pm – 6:00 pm ADSA Dairy Foods Division Council Meeting, Convention Center, Room 204B

Monday, July 9

9:30 am – 12:30 pm Graduate Student Paper Competition: National ADSA Dairy Foods Division, Convention Center, Room 201 (page 104)

1:30 pm – 5:00 pm SYMPOSIUM: Dairy Foods: The Dairy Management Inc. National Dairy Foods Research Center Program: Responding to Industry Needs for New Technologies, Products and Markets, Convention Center, Room 202 (page 113)

2:00 pm – 5:00 pm Dairy Foods: Cheese I, Convention Center, Room 201 (page 118)

Tuesday, July 10

7:30 am – 9:30 am Posters - Cheese, Dairy Products and Chemistry, Convention Center, Exhibit Hall C (page 135)

9:30 am – 10:30 am ADSA Foundation Scholar Lecture - Dairy Foods, Convention Center, Room 201 (page 166)

10:30 am – 11:30 am Danisco International Dairy Science Award Lecture, Convention Center, Room 201 (page 167)

11:30 am – 12:30 pm ADSA Dairy Foods Division Business Meeting, Convention Center, Room 201

12:30 pm – 2:00 pm ADSA Dairy Foods Division Milk Proteins & Enzymes Committee, Convention Center, Room 201

2:00 pm – 5:00 pm Dairy Foods: Chemistry and Microbiology, Convention Center, Room 201 (page 170)

2:00 pm – 5:00 pm SYMPOSIUM: Dairy Foods: On the Road From Analysis and Discovery of Functional Milk Bioactives to New Products and Health Outcomes, Convention Center, Room 202 (page 171)

Wednesday, July 11

7:30 am – 9:30 am Posters - Dairy Processing, Products and Microbiology, Convention Center, Exhibit Hall C (page 184)

9:30 am – 10:00 am Joint ADSA/ASAS Business Meeting, Convention Center, Room 206B (page 204)

10:00 am – 10:30 am ADSA Business Meeting, Convention Center, Room 206A (page 204)

10:30 am – 12:30 pm Dairy Foods: Products and Processing, Convention Center, Room 202 (page 209)

2:00 pm – 5:00 pm Dairy Foods: Cheese II, Convention Center, Room 201 (page 216)

2:00 pm – 5:00 pm SYMPOSIUM: Dairy Foods: Milk Proteins and Enzymes: Proteomics and Milk, Convention Center, Room 202 (page 217)